

FOR LEASE

**72 STANIFORD STREET
WEST END | BOSTON, MA**

± 1,697 SF

THE WEST END
APARTMENTS

LEASING CENTER 72

WEST END MARKET



THE WEST END
APARTMENTS

W LEASING C

Jersey Mike's SUBS



MILAN
Laser Hair Removal

MILAN Laser Hair Removal

THE OPPORTUNITY

72 Staniford is situated on the highly desirable corridor connecting historic Beacon Hill, modern West End, and bustling North Station/TD Garden. This +/- 1,697 SF unit represents the last vacancy of the newly revitalized center, offering the opportunity to join Jersey Mike's, Domino's, Chilacates, Milan Laser and more. Moreover, this location is immersed in the dense medical office population of Massachusetts General Hospital, Massachusetts Eye and Ear, and Shriners' Hospitals for Children.

AREA SPECS

(0.5 MILE RADIUS)

\$1.03 BILLION

RETAIL EXPENDITURE

\$212,000

AVERAGE HOUSEHOLD INCOME

22,000+

RESIDENTS

STEPS AWAY FROM

TD GARDEN & MGH

NEIGHBORS:



TD GARDEN



MASSACHUSETTS
GENERAL HOSPITAL



FLOOR PLAN



**FOR
LEASE**

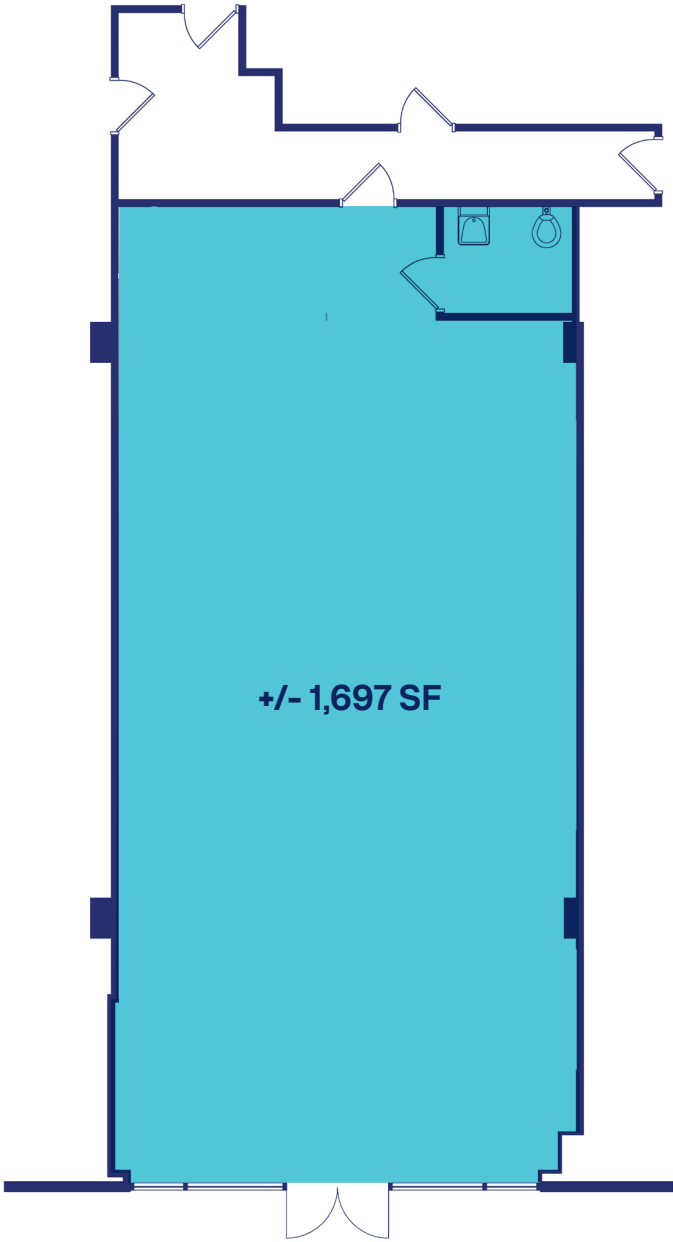

LOCATION



MUSEUM OF SCIENCE

CONVERSE

28

3

NORTH STATION

93

EQUITY RESIDENTIAL

TD GARDEN

RAPID 7

WHITTIER PLACE

TASTY BURGER

STAR MARKET

THOREAU PATH

HUBHALL

VERIZON

EQUITY RESIDENTIAL

CITIZEN M

ASCEND

MASS GENERAL HOSPITAL: CORRIGAN

IRS

ONYX

DUNKIN

THE SKI MONSTER

CITY WINERY

SHRINERS CHILDREN'S BOSTON



STANFORD ST

MERRIMAC ST

HAYMARKET

MASS GENERAL HOSPITAL

PARTNERS HEALTHCARE

BOSTON PUBLIC MARKET

MASS GENERAL HOSPITAL YAWKEY

CVS

WHOLE FOODS

NEW CHARDON ST

FLOUR

BANK OF AMERICA

CHARLES/MGH

TD BANK

STARBUCKS

CAMBRIDGE ST

BOWDOIN

JFK FEDERAL BUILDING

THE WHITNEY HOTEL

TARGET

BOSTON CITY HALL

SWEETGREEN

BLANK STREET

BOWDOIN ST

GOVERNMENT CENTER

COURT ST



FIND YOUR DISTRICT



BECK DANGLER
Senior Vice President

315.723.8511
beck@districtadvisors.com



800 Boylston Street
Suite 420
Boston MA 02199

857.284.7971
districtadvisors.com

This information has been secured from sources we believe to be reliable, but we make no representations or warranties, expressed or implied, as to the accuracy of the information. References to rents, expenses, expense reimbursements, lease terms, square footage, demographics, traffic count or age are approximate. Parties must verify the information and bears all risk for any inaccuracies.