

FOR SALE

210 - 310 W. Hundred Road | Chester, Virginia 23836



For More Information Regarding This Property, Please Contact:

RIVER'S BEND
PROFESSIONAL CENTER

COLTON KONVICKA

804-324-7209

ckonvicka

@commonwealthcommercial.com

TUCKER DOWDY

804-228-4932

tdowdy

@commonwealthcommercial.com

MAIN OFFICE ADDRESS: 4198 Cox Road, Suite 200 | Glen Allen, VA 23060 **MAILING ADDRESS:** P.O. Box 71150 | Richmond, VA 23255

T 804-346-4966 **F** 804-346-5901 **COMMONWEALTHCOMMERCIAL.COM**



Features

220, 300, 310 W. Hundred Road

- › **Proposed** one story medical office condos
- › Build-to-suit opportunity
- › Zoned C-2
- › Pad site available
- › All utilities stubbed to site
- › Potential monument signage available

210 W. Hundred Road

- › **Existing** 7,752 SF one story medical office building
- › ±2,500 - 7,752 SF condos available; built in 2014
- › Visibility/signage from W. Hundred Road
- › Join newly developed medical center which includes Colonial Orthopedics, David Ferry Dentistry, Spine Institute of Virginia, etc.
- › Conveniently located between I-95 & I-295
- › Parking ratio 5:1000 SF
- › 5 miles from John Randolph Medical Center
- › Pricing: call agent for details

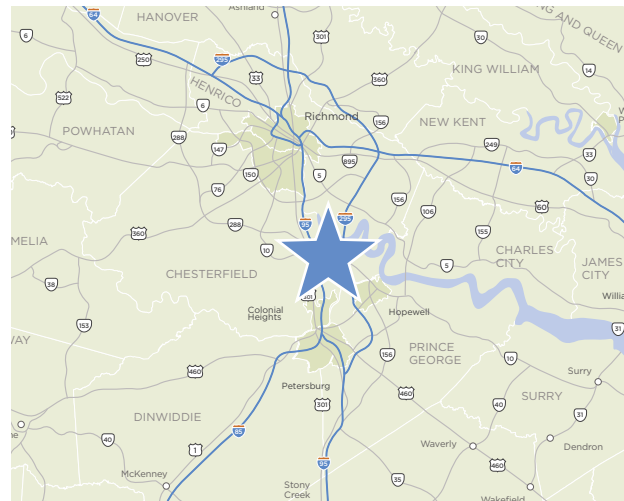

Demographics

	1 Mile	3 Miles	5 Miles
Total Population	2,912	18,782	61,260
Daytime Employees	1,085	13,311	25,489
Average HH Income	\$122,703	\$93,366	\$86,503



Site plans

Floor plans

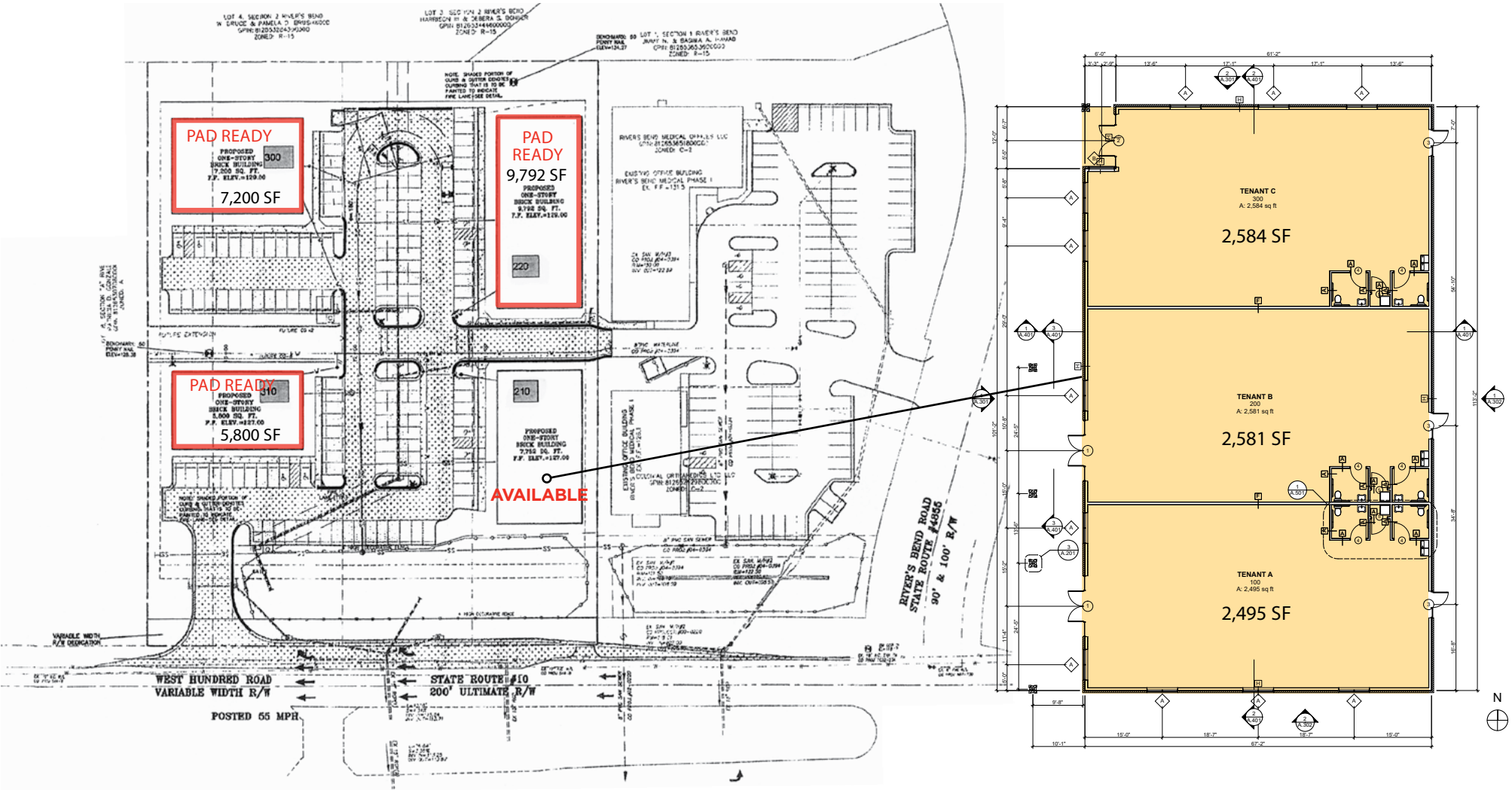



Renderings

