

**For Sale/Lease**  
**1 Norfolk Avenue Easton, MA**



**Easton Industrial Park**

**78,268 SF**  
**Warehouse & Manufacturing**  
**Facility**

**DONAHUE**  
**ASSOCIATES**

*Commercial & Industrial Real Estate*  
*Tel: 508.588.1717*  
*Donahueassociates.com*

# Building Specs

## 43,520 SF Total Warehouse

North Warehouse:

26,273 SF

18' Clear

5 Loading Docks

South Warehouse:

17,257SF

25' Clear

2 Loading Docks

25,428 SF A/C Manufacturing

9,310 SF Office

*Includes 8,689 SF ISO 8 Clean Room & Lab  
areas suitable for pharmaceutical, medical  
device & electronics manufacturing*

### Additional Information

Heavy Power

ESFR Sprinkler System

Zoned Industrial

15.27 Acres

2025 Taxes \$70,990.61 +/-

*(4,500 SF Mezzanine not included in SF)*

*Accessible via Brockton Area Transit  
Authority*

# Floor Plan

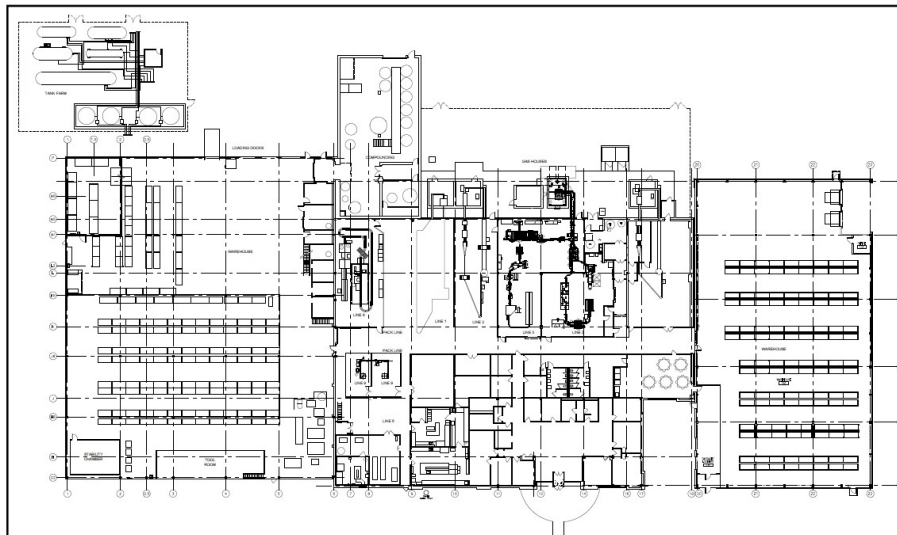

**IFDI**  
**Industrial Facilities Design, Inc.**  
1000 North  
 10th Street, Suite 100  
 Houston, TX 77002

**PHARMASOL**  
One South Avenue Center, MS. 10271

ENGINEERING SERVICES

OVERALL EXISTING CONDITIONS PLAN

NO.	DATE	BY	DESCRIPTION

SCALE	DATE	PROJECT NUMBER	DRAWING NUMBER
1/4" = 1'-0"	03/24/04	11524	A-121
FILE	11524-A-121		

*Photographs*



# Location

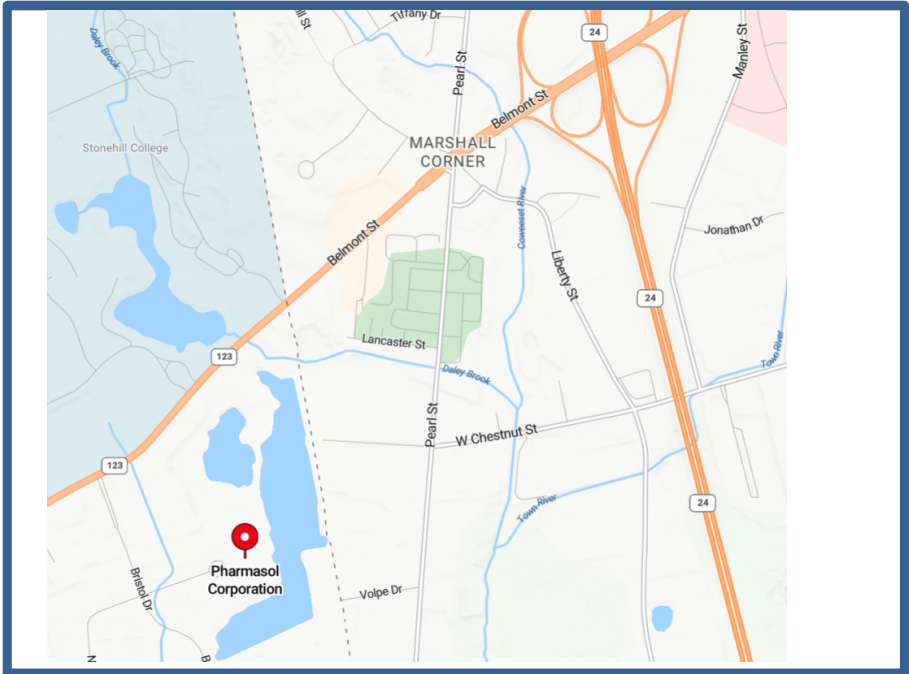

*For more information Contact*  
**Mark Donahue**  
**617-930-7477**

**Betsy Donahue**  
**339-206-7422**