

FOR LEASE

SEDONA, ARIZONA

HILLSIDE SHOPPING CENTER

INCREDIBLE LOCATION & VISIBILITY
TOP RESTAURANTS AND RETAIL
SIGNIFICANT CAPITAL IMPROVEMENTS
PANORAMIC RED ROCK VIEWS



LISTING BROKER:
JACK MCMAHON
(928) 224-2709
jack@mmpropsaz.com
[Company Website](#)

Table of Contents

02 TABLE OF CONTENTS	09 SUITE AVAILABILITY
03– 04 PHOTOS	10 – 11 ALLOWABLE USES
05 – 06 PROPERTY DETAILS	12 – 13 SEDONA INFO
07 – 08 TENANT MIX AND SITE MAP	14 CONTACT



AERIAL PHOTO



GROUND'S PHOTOS





OFFERING HIGHLIGHTS



Location & Frontage

SR 179 FRONTAGE AND VISIBILITY
W/MONUMENT SIGNAGE. STEPS
FROM ARABELLA HOTEL, LOS
ABRIGADOS RESORT, AND
TLAQUEPAQUE ARTS VILLAGE



Competitive Rates / New Ownership

PROFESSIONALLY MANAGED &
MAINTAINED WITH ONSITE MGMT.
NEW HANDS-ON OWNERSHIP AS OF
2022.



Capital Improvements

NEW PAINT, PARKING LOT, MURALS,
SIGNAGE, ATTRACTIONS, TENANTS
ETC. SIGNIFICANT ONGOING
RENOVATION. SEE NEXT PAGE FOR
DETAILS

OFFERING SUMMARY

ADDRESS 671 STATE ROUTE 179, SEDONA, AZ 86336

973 SF + 300 SF

SIZE(S)

\$3.00 NNN

MONTHLY RATE

29,751 SF

GLA

2.84 AC

SITE SIZE

16,500+

VPD (ADOT)

99%

OCCUPANCY

175+ SHARED

PARKING

CO

ZONING

SR 179

FRONTAGE

IMMEDIATE

AVAILABILITY

PREMIER SEDONA LOCATION

- Fantastic visibility with excellent vehicular & foot traffic (steps from 150 room Arabella Sedona Hotel and 220 room Los Abrigados Resort and Tlaquepaque Arts & Crafts Village)
- Panoramic red rock views and steps from Oak Creek
- 1,000' feet of SR 179 frontage with two points of ingress/egress and 170+ parking spots
- **Top rated anchor restaurants onsite (Hudson and Javelina Cantina) plus Mooney's Irish Pub**
- **COMING SOON - KOREAN BBQ RESTAURANT, DESERT SHOP, MINI GOLF, DESIGNER W/COFFEE**

IMPROVEMENTS

- New ownership in Fall of 2022
- New exterior paint as of May 2023
- New parking lot July of 2023
- New and refreshed signage Fall of 2023
- New artist murals Fall of 2023
- All vacant suites repainted/renovated
- All suites now with interior bathrooms + common

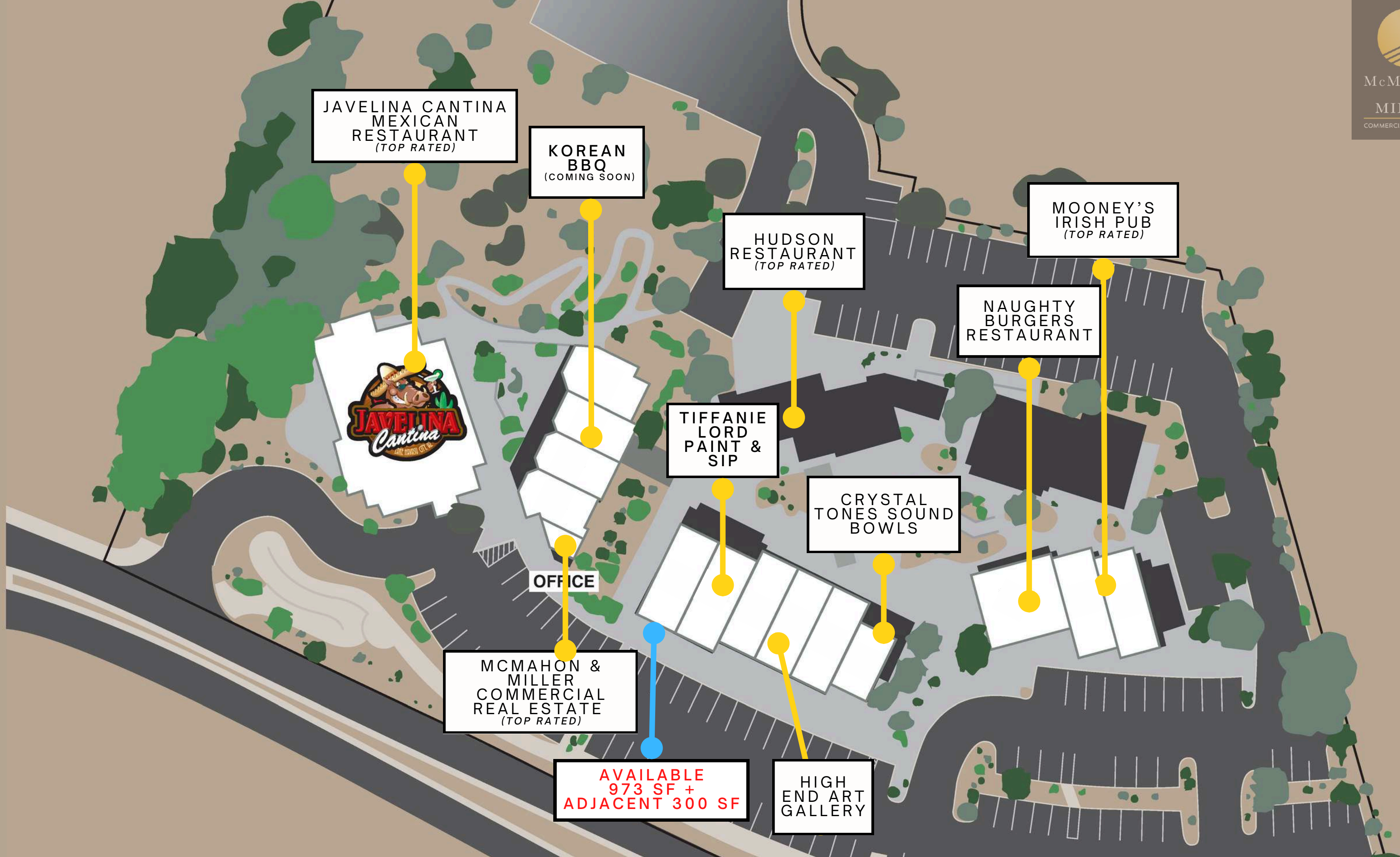

BOBA TEA AND DESSERT	RESTAURANT (COMING SOON)	BLUE LOTUS BOUTIQUE	COOKIE CREATIONS	ASCEND CBD OIL	ALFARAH SELF CARE/ ZIA WELLNESS	CLUB PILATES	BERKSHIRE HATHAWAY REAL ESTATE
----------------------------	--------------------------------	---------------------------	---------------------	-------------------	---------------------------------------	-----------------	--------------------------------------

Storage Closet
Common Women's Restroom
Common Men's Restroom

MINI GOLF
(COMING
SOON)

DESIGNER
W/COFFEE
SHOP

SUITE A-ST-1 (973 SF)

PICTURES COMING SOON

SUMMARY TABLE OF ALLOWED USES

Section 3.2 Table of Allowed Uses | Sedona Land Development Code

Page 1 of 7

E. Table of Allowed Uses

See Table 3.1, below.

Table 3.1

Table of Allowed Uses

P = permitted C = conditional use permit required A = accessory Blank Cell = use prohibited

	Residential								Non-Residential						Other				Use-Specific Standards
	RS-70	RS-35	RS-18	RS-10	RS-6	RMH	RM-1	RM-2	RM-3	M1	M2	M3	CO	IN	L	CF	OS	OC	
Residential																			
Household Living																			
Dwelling, Co-Housing							P	P	C	P								P	3.3.A(1)
Dwelling, Duplex							P	P	C	P	P							P	
Dwelling, Live/Work										P	C	P	C	C	C	A		P	3.3.A(2)
Dwelling, Multifamily							P	P	P	P	P	P	P	P	P	A		P	3.3.A(3)
Dwelling, Single-Family Attached							P	P	C	P	P		C		C			P	3.3.A(4)
Dwelling, Single-Family Detached	P	P	P	P	P	P	P	P	C	C								P	3.3.A(5)
Manufactured Home					P	P	C	C	C										3.3.A(6)
Group Living																			
Assisted Living Center										P	P	P	P		P	P			
Dormitory							C	C	C	C	P	P	C						
Public, Institutional, and Civic Uses																			
Community and Cultural Facilities																			
Cemetery or Interment Facility																C			
Club or Lodge	C	C	C	C	C	C	C	C	C	C	P	P	P	P	P	P		P	3.3.B(1)
Conference/Meeting Facility											A	A	P	P	P	P		A	
Day Care	C	C	C	C	C	C	C	C	C	C	P	P	P			A			

The Sedona Land Development Code is current through Ordinance 2023-09, passed October 24, 2023.

Section 3.2 Table of Allowed Uses | Sedona Land Development Code

Page 2 of 7

Table 3.1

Table of Allowed Uses

P = permitted C = conditional use permit required A = accessory Blank Cell = use prohibited

	Residential									Non-Residential						Other				Use-Specific Standards	
	RS-70	RS-35	RS-18	RS-10	RS-6	RMH	RM-1	RM-2	RM-3	M1	M2	M3	CO	IN	L	CF	OS	OC			
Foodbanks	CA	CA	CA	CA	CA	CA	CA	CA	CA	P	P	P	P	P	P	P		P	Accessory to non-residential use		
Funeral Facility												P	P	P	P	P					
Library										C	C	P	P	P	P	C					
Museum										C	C	P	P	P	P	C		P			
Park, Active	P	P	P	P	P	P	P	P	P	P	P	P	P	P	P	P	P	P			
Park and Open Space, Passive	P	P	P	P	P	P	P	P	P	P	P	P	P	P	P	P	P	P			
Religious Assembly	C	C	C	C	C	C	C	C	C	P	P	P	P	P	P	P		P			
Shelters (e.g., homeless shelter)	CA	CA	CA	CA	CA	CA	CA	CA	CA	P	P	P	P	P	P	P		P	Accessory to non-residential use		
Educational Facilities																					
School, Public or Private	C	C	C	C	C	C	C	C	C	C	P	P	P	P	P	P		P	3.3.B(2)		
School, Vocational or Trade											P	P	P	P	P						
Healthcare Facilities																					
Hospital											P	P	P		P						
Medical or Dental Clinic										C	P	P	P		P						
Commercial Uses																					
Animal-Related Uses																					
Kennel, Commercial													C	P					3.3.C(1)		
Stable, Commercial	P	P																	3.3.C(2)		
Veterinary Hospital or Clinic										C	P	P	P	P					3.3.C(3)		

The Sedona Land Development Code is current through Ordinance 2023-09, passed October 24, 2023.

Section 3.2 Table of Allowed Uses | Sedona Land Development Code

Table 3.1

Table of Allowed Uses

P = permitted C = conditional use permit required A = accessory Blank Cell = use prohibited

	Residential									Non-Residential					Other				Use-Specific Standards
	RS-70	RS-35	RS-18	RS-10	RS-6	RMH	RM-1	RM-2	RM-3	M1	M2	M3	CO	IN	L	CF	OS	OC	
Recreation and Entertainment																			
RV Park																		P	3.3.C(4)
Indoor Recreation Facility								A	A	P	P	P	P	P	P	P			3.3.C(5)
Outdoor Recreation Facility	CA	CA	CA	CA	A	A	A	A	A		C	C	C	C	C	C	C	P	3.3.C(6)
Food and Beverage Services																			
Bar, Tavern, Lounge, or Tasting Room										C	P	P	P	P	P			P	3.3.C(7)
Catering Establishment											P	P	P	P	P				
Microbrewery, Distillery, or Winery										C	P	P	P	P	P			P	3.3.C(8)
Mobile Food Vending										P	P	P	P	P	P	P		C	3.3.C(9)
Restaurant										P	P	P	P	P	P			P	3.3.C(10)
Restaurant with Drive-Through												C	P	P	P				3.3.C(11)
Office, Business, and Professional Services																			
Administrative, Professional, or Government Office										P	P	P	P	P	P	P		P	3.3.C(12)
Financial Institution										P	P	P	P	P	P				3.3.C(13)
Lodging																			
Lodging, Medium-Density												P			P			P	3.3.C(14)b
Lodging, High-Density															See 3.3				
Personal Services																			
Personal Services, General										P	P	P	P	P	P			P	

SEE 10

The Sedona Land Development Code is current through Ordinance 2023-09, passed October 24, 2023.

SUMMARY TABLE OF ALLOWED USES (CONT'D)

Section 3.2 Table of Allowed Uses | Sedona Land Development Code

Page 4 of 7

Table 3.1

Table of Allowed Uses

P = permitted C = conditional use permit required A = accessory Blank Cell = use prohibited

	Residential									Non-Residential						Other			Use-Specific Standards
	RS-70	RS-35	RS-18	RS-10	RS-6	RMH	RM-1	RM-2	RM-3	M1	M2	M3	CO	IN	L	CF	OS	OC	
Laundromat, Self-Service							A	A	A	P	P	P	P	P	P				3.3.C(16)
Retail Sales																			
Auction House											P	P	P	P	P				3.3.C(17)
Building Materials and Supply Store													P	P					
General Retail, Less than 10,000 Square Feet										P	P	P	P	P	P			P	3.3.C(18)
General Retail, 10,000 Square Feet to 25,000 Square Feet													P		P				
General Retail, More than 25,000 Square Feet													C		C				
Medical Marijuana Dispensary													P	P					3.3.C(19)
Medical Marijuana Dispensary, Off-Site Cultivation Location, Recreational Marijuana Establishment Dual Licensee													P	P					3.3.C(19)
Nursery or Garden Supply Store											C	P	P	P	P			P	3.3.C(20)
Transportation, Vehicles, and Equipment																			
Equipment Sales and Rental													C	P					3.3.C(21)
Fleet Services													P	P	C	C			3.3.C(22)
Off-Highway Vehicle Sales and Rentals													C	C	C				3.3.C(29)
Parking Facility												P	P	P	P	C			

The Sedona Land Development Code is current through Ordinance 2023-09, passed October 24, 2023.

Section 3.2 Table of Allowed Uses | Sedona Land Development Code

Page 5 of 7

Table 3.1

Table of Allowed Uses

P = permitted C = conditional use permit required A = accessory Blank Cell = use prohibited

	Residential									Non-Residential						Other			Use-Specific Standards		
	RS-70	RS-35	RS-18	RS-10	RS-6	RMH	RM-1	RM-2	RM-3	M1	M2	M3	CO	IN	L	CF	OS	OC			
Transit Terminal or Station																C					
Vehicle Fuel Sales												C	P	P					3.3.C(23)		
Vehicle Repair, Major													P	P					3.3.C(24)		
Vehicle Repair, Minor											C	C	P	P	P				3.3.C(25)		
Vehicle Sales and Leasing													P	P	C				3.3.C(26)		
Vehicle Service Station											C	C	P	P	P				3.3.C(27)		
Vehicle Wash											C	P	P	P	P						
Adult Entertainment Establishments																					
Adult Entertainment													C	C					3.3.C(28)		
Industrial Uses																					
Manufacturing and Processing																					
Food Processing											C	C	P	P	P	P			3.3.D(1)		
Manufacturing, Artisan											C	C	P	P	P	P		P	3.3.D(2)		
Manufacturing, Light													P	P					3.3.D(3)		
Storage and Warehousing																					
Contractor Office or Equipment Storage Yard													C	P							
Outdoor Storage													C	P					3.3.D(4)		
Self-Storage Facility													P	P					3.3.D(5)		
Warehousing and Wholesale Facility													P	P					3.3.D(6)		
Public and Semi-Public Utility Uses																					
Flood Control Facility	P	P	P	P	P	P	P	P	P	P	P	P	P	P	P	P	C	C			
Public Utility, Major	C	C	C	C	C	C	C	C	C	C	C	C	C	P	C	P					
Public Utility, Minor	P	P	P	P	P	P	P	P	P	P	P	P	P	P	P	P	C	C			

The Sedona Land Development Code is current through Ordinance 2023-09, passed October 24, 2023.

Section 3.2 Table of Allowed Uses | Sedona Land Development Code

Table 3.1

Table of Allowed Uses

P = permitted C = conditional use permit required A = accessory Blank Cell = use prohibited

	Residential									Non-Residential						Other				Use-Specific Standards	
	RS-70	RS-35	RS-18	RS-10	RS-6	RMH	RM-1	RM-2	RM-3	M1	M2	M3	CO	IN	L	CF	OS	OC			
Water Storage Tank	C	C	C	C	C	C	C	C	C	C	C	C	C	C	C	P	C	C			
Wireless Telecommunications Facility	See Article 4: Wireless Communication Facilities																				
Accessory Uses																					
Agriculture, General	A	A															CA	A	3.4.D(1)		
Agriculture, Urban	A	A	A	A	A	A	A	A	A	A	A	A	A	A	A	A	A	A	3.4.D(2)		
Guest Quarters	A	A	A	A	A	A	A	A	A	A								A	3.4.D(3)		
Home Occupation	A	A	A	A	A	A	A	A	A	A	A	A						A	3.4.D(4)		
Outside Sales and Display										CA	CA	CA	CA	CA	CA				3.4.C(3)		
Outdoor Dining										A	A	A	A	A	A			A			
Outdoor Storage, Accessory	A	A	A	A	A	A	A	A	A	A	A	A	A	A	A	A		A	3.4.D(5)		
Parking Facilities	CA	CA	CA	CA	CA	CA	CA	CA	CA										3.4.D(7)		
Temporary Uses																					
Christmas Tree and Pumpkin Sales	P	P	P	P	P	P	P	P	P	P	P	P	P	P	P	P	P	P	3.5.E(1)		
Construction Support Activity	P	P	P	P	P	P	P	P	P	P	P	P	P	P	P	P	P	P	3.5.E(2)		
Filming-Related Activity	P	P	P	P	P	P	P	P	P	P	P	P	P	P	P	P	P	P	3.5.E(3)		
Model Home	P	P	P	P	P	P	P	P	P	P	P							P			
Special Event	P	P	P	P	P	P	P	P	P	P	P	P	P	P	P	P	P	P	3.5.E(4)		
Temporary Housing	P	P	P	P	P	P	P	P	P	P								P	3.5.E(5)		

The Sedona Land Development Code is current through Ordinance 2023-09, passed October 24, 2023.

SEDONA, AZ



Visitors Generate Significant Funding



Sedona

Location

- 45 min south of Flagstaff
- 2 hours north of Phoenix
- 2 hours south of Grand Canyon
- 4.5 hours southeast of Las Vegas
- 7 hours east of Los Angeles

Airports

- Phoenix Sky Harbor (100 miles)
- Flagstaff Pulliam (30 miles)
- Sedona Airport (West Sedona)
- Cottonwood Airport (20 miles)

Activities

- 300+ recreational trails
- Sits in the middle of 1.8 million acres of national forest
- Oak Creek, golf, restaurants, and shopping

Major Employers

- Enchantment Resorts: 570+
- L'Auberge De Sedona: 240+
- Hilton Resort: 197+
- Pink Jeep Tours: 170+

Contact Information

LISTING TEAM

PADRAIC HAWLEY – ASSOCIATE BROKER

(928) 399-9141

PADRAIC@MMPROPSAZ.COM

JACK MCMAHON – DESIGNATED BROKER

(928) 224-2709

JACK@MMPROPSAZ.COM

COMPANY WEBSITE



McMAHON
&
MILLER

COMMERCIAL REAL ESTATE