

PROPERTY FOR SALE / LEASE

1026 W 11 Mile Road  
Royal Oak, MI 48067



L. MASON CAPITANI  
CORFAC INTERNATIONAL



## Property Highlights

- Excellent Owner/Occupant Investment
- Move-In Ready Office Suite
- Building Could Be Vacated For User
- Just Blocks From Downtown Royal Oak
- Prominent Signage Available
- Direct Suite Entry
- Dedicated Parking & Suite HVAC
- Minutes From Beaumont Hospital Royal Oak
- Quick Access to I-696 & I-75 via Woodward Ave

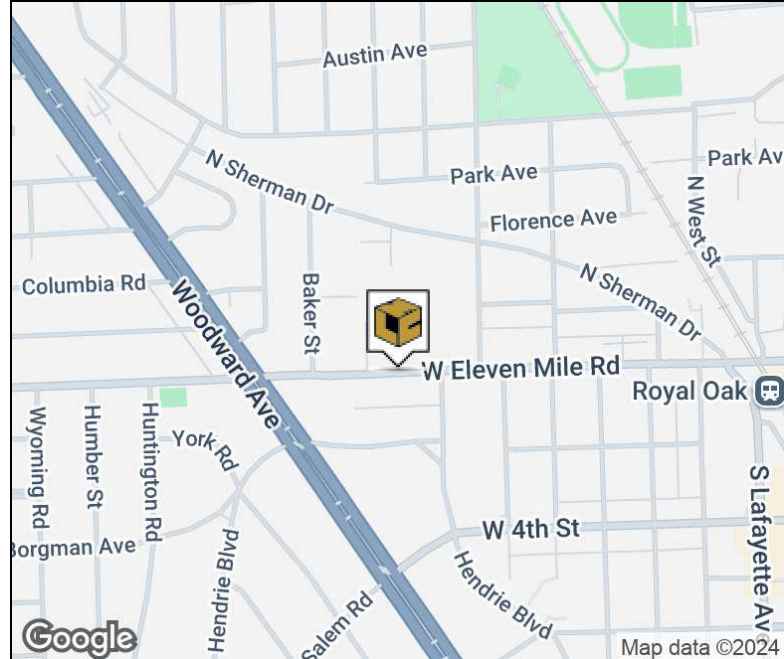

## FOR MORE INFORMATION:

**Aaron Smith**

Vice President  
248.637.3515  
asmith@lmcap.com

**Mason L. Capitani, SIOR**

Managing Partner  
248.637.7795  
mlcapitani@lmcap.com



CONNECT WITH US

248.637.9700 | [www.LMCap.com](http://www.LMCap.com)

Information contained herein was obtained from sources deemed to be reliable but is not guaranteed. Subjects to prior sales, changes of price or withdrawal.

PROPERTY FOR SALE / LEASE

**1026 W Eleven Mile Rd**  
Royal Oak, MI 48067



**L. MASON CAPITANI**  
CORFAC INTERNATIONAL

## OFFICE PROPERTY DETAILS

Sale Price	<b>\$2,100,000</b>
------------	--------------------

Lease Rate	<b>\$23.00 SF/yr NNN</b>
------------	--------------------------

## Property Information

Property Type	Office
Property Subtype	Office Building
Zoning	Office
Lot Size	11,175 SF
APN #	25-16-380-032

## Parking & Transportation

Parking Type	Surface
Parking Ratio	3.31

## Available Suites

Suite C - 1,094 SF	\$23.00 NNN
--------------------	-------------

## Location Information

Street Address	1026 W Eleven Mile Rd
City, State, Zip	Royal Oak, MI 48067
County	Oakland
Cross-Streets	East of Woodward Avenue
Nearest Highway	I-696 & I-75

## Building Information

Building Size	11,175 SF
Building Class	B
Occupancy %	71.4
Tenancy	Multiple
Number of Floors	2
Year Built	1950
Gross Leasable Area	11,175 SF
Load Factor	N/A
Annual Escalations	2.5%
Partition Allowance	Negotiable

## FOR MORE INFORMATION:

### Aaron Smith

Vice President  
248.637.3515  
asmith@lmcap.com

### Mason L. Capitani, SIOR

Managing Partner  
248.637.7795  
mlcapitani@lmcap.com



CONNECT WITH US

**248.637.9700 | www.LMCap.com**

Information contained herein was obtained from sources deemed to be reliable but is not guaranteed. Subjects to prior sales, changes of price or withdrawal.



PROPERTY FOR SALE / LEASE

1026 W Eleven Mile Rd

Royal Oak, MI 48067



L. MASON CAPITANI  
CORFAC INTERNATIONAL

RETAILER MAP

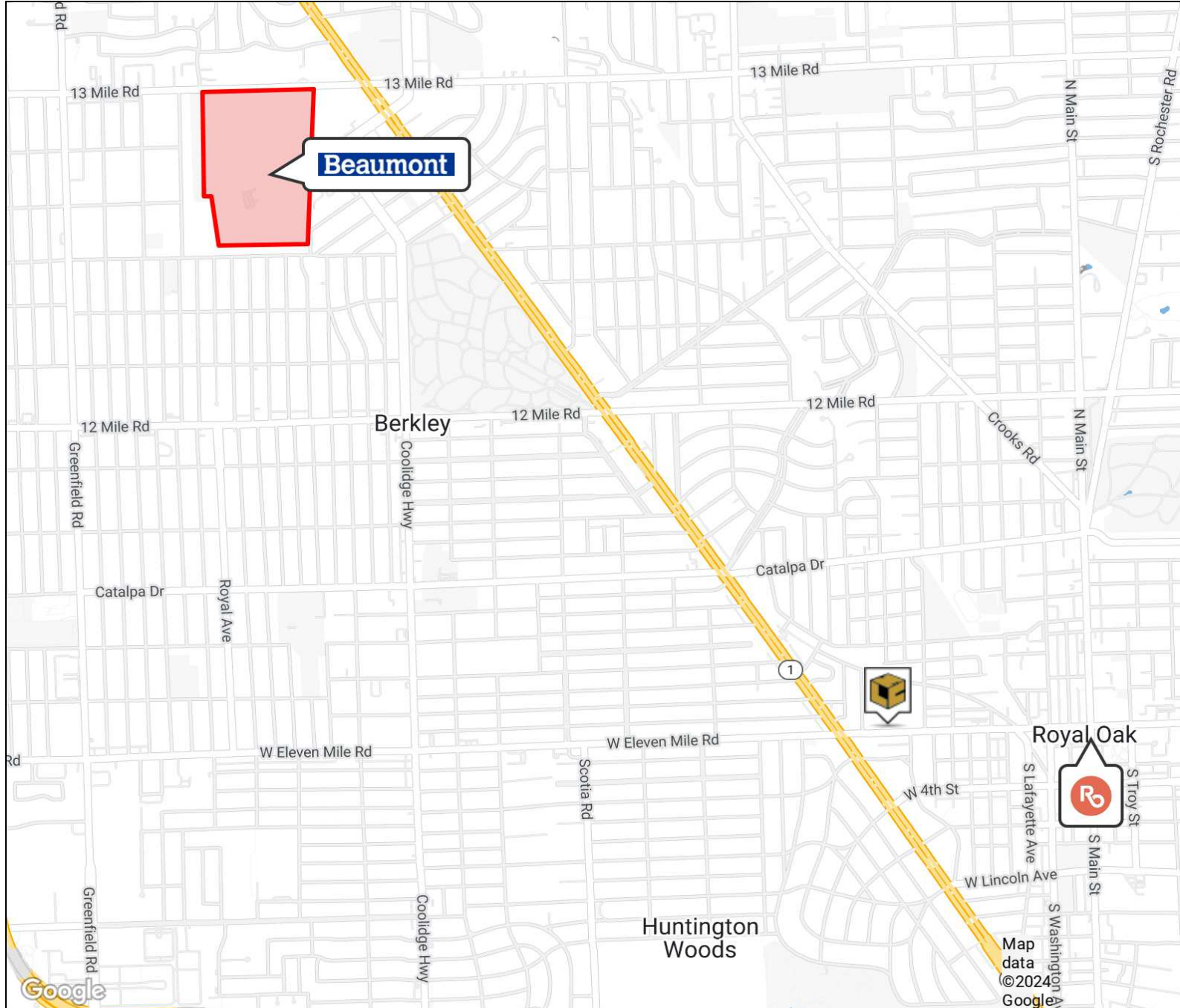

FOR MORE INFORMATION:

**Aaron Smith**

Vice President

248.637.3515

asmith@lmcap.com

**Mason L. Capitani, SIOR**

Managing Partner

248.637.7795

mlcapitani@lmcap.com



CONNECT WITH US

248.637.9700 | [www.LMCap.com](http://www.LMCap.com)

Information contained herein was obtained from sources deemed to be reliable but is not guaranteed. Subjects to prior sales, changes of price or withdrawal.

PROPERTY FOR SALE / LEASE

1026 W 11 Mile Road  
Royal Oak, MI 48067



L. MASON CAPITANI  
CORFAC INTERNATIONAL

FIRST FLOOR PLAN

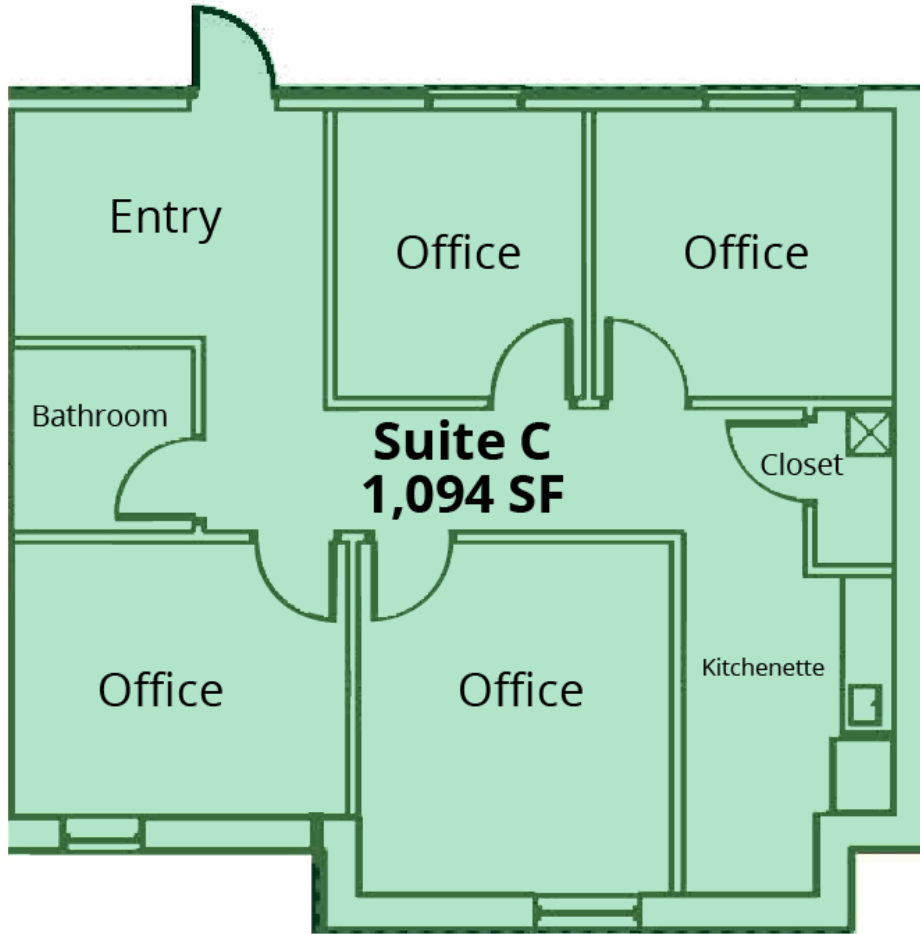

Available Space

Suite	Tenant	Size (SF)	Lease Type	Lease Rate
Suite C	Available	1,094 SF	NNN	\$23.00 SF/yr

FOR MORE INFORMATION:

**Aaron Smith**  
Vice President  
248.637.3515  
asmith@lmcap.com

**Mason L. Capitani, SIOR**  
Managing Partner  
248.637.7795  
mlcapitani@lmcap.com



CONNECT WITH US

248.637.9700 | [www.LMCap.com](http://www.LMCap.com)

Information contained herein was obtained from sources deemed to be reliable but is not guaranteed. Subjects to prior sales, changes of price or withdrawal.