

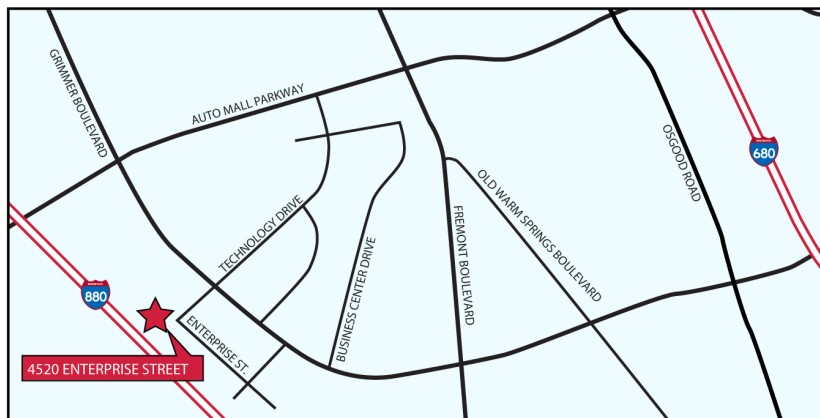

For Lease : ±11,764 SF Industrial Space With Heavy Power

**4520 ENTERPRISE STREET
FREMONT, CA**



Property Type for Lease/Sale

- ±11,764 SF Available
- ±10% Office
- 1,200 Amps of Distributed Power (To be Verified)
- 100% HVAC Throughout
- One (1) Grade Level Door
- Ample Parking
- Close Proximity to Pacific Commons Retail
- Freeway Signage Available on I-880
- Available 7/1/24- Call to Tour

Lease Rate

\$1.50 / NNN / PSF / MO

For information, please contact:

Steve Kapp, SIOR

Executive Managing Director
t 510-543-7822
steve.kapp@nrmk.com

Grant Meylan

Associate Director
t 925-899-1556
grant.meylan@nrmk.com

nrmk.com

NEWMARK

The distributor of this communication is performing acts for which a real estate license is required. The information contained herein has been obtained from sources deemed reliable but has not been verified and no guarantee, warranty or representation, either express or implied, is made with respect to such information. Terms of sale or lease and availability are subject to change or withdrawal without notice. MP-813 • 05/2024

FloorPlan

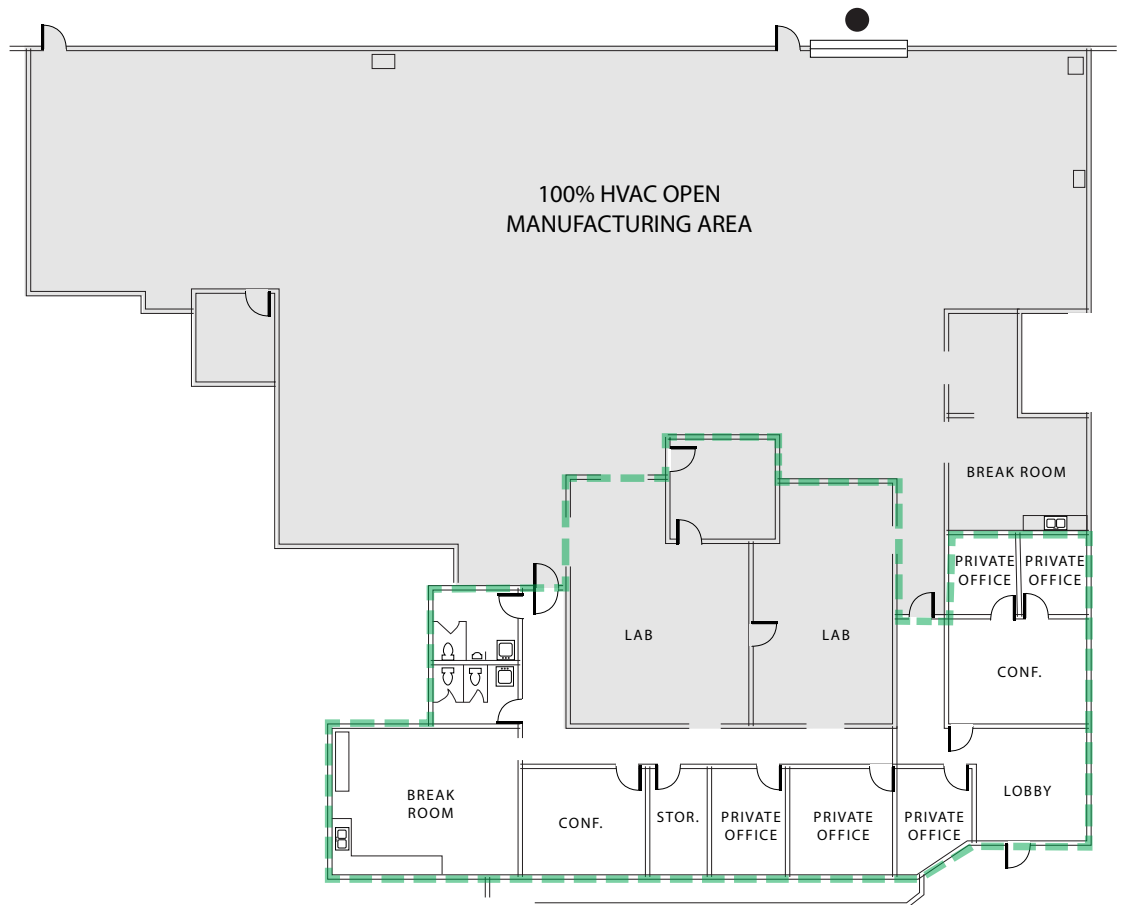

Site Plan

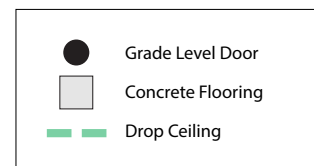
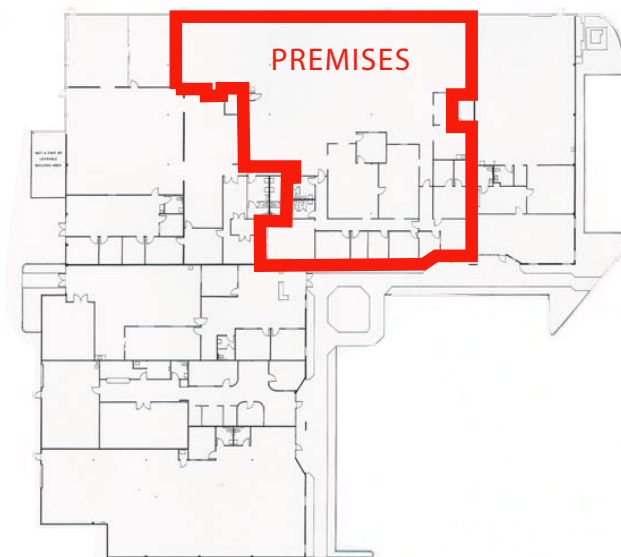

For information, please contact:

Steve Kapp, SIOR

Executive Managing Director
t 510-543-7822
Steve.kapp@nmrk.com

Grant Meylan

Associate Director
t 925-899-1556
grant.meylan@nmrk.com

nmrk.com

NEWMARK

The distributor of this communication is performing acts for which a real estate license is required. The information contained herein has been obtained from sources deemed reliable but has not been verified and no guarantee, warranty or representation, either express or implied, is made with respect to such information. Terms of sale or lease and availability are subject to change or withdrawal without notice. MP-813 • 05/2024