

FOR LEASE

COMMERCIAL PROPERTY
1978 W. WILSON STREET
BATAVIA, IL 60510

Commercial Space Available!

RATE: \$25/SF/YR NNN
6,275 SQUARE FEET
\$9.11/SF/YR CAM

Building Highlights

- ▶ Freestanding Brick Building
- ▶ Ample Parking
- ▶ Detached Drive-Through
- ▶ High Ceilings and Large Windows
- ▶ Signage Opportunities
- ▶ Located on Major Thoroughfare



FOR LEASE

COMMERCIAL PROPERTY
1978 W. WILSON STREET
BATAVIA, IL 60510

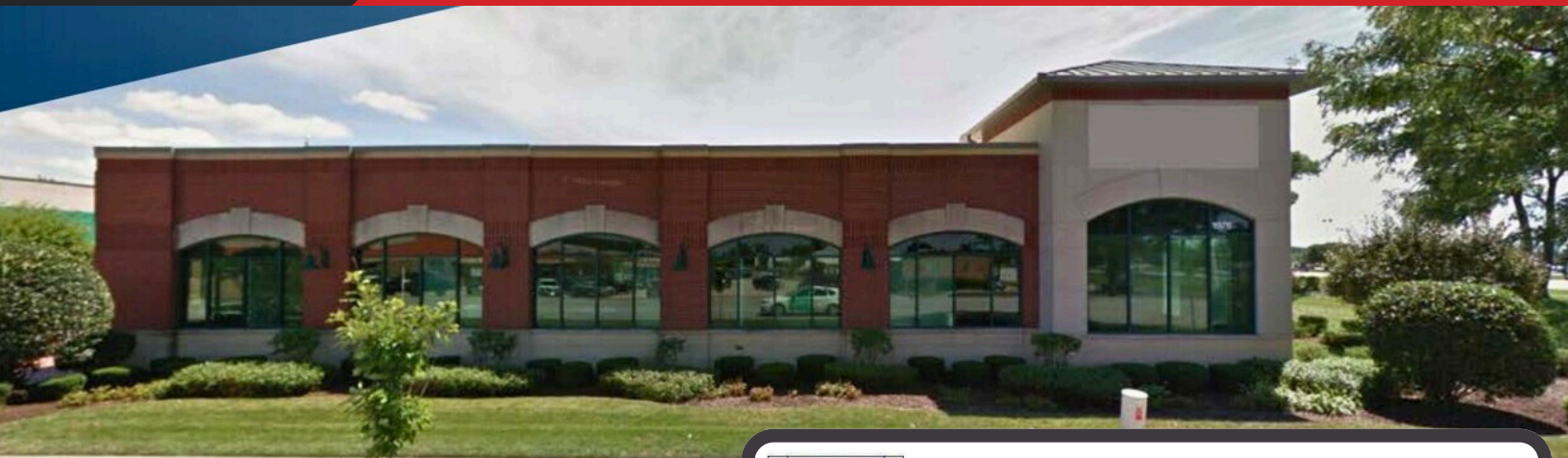

PROPERTY AND LOCATION

1978 W. Wilson Street is conveniently located along the major thoroughfare of Randall Road at a heavily traveled and signalized intersection. With excellent visibility and over 45,000 vehicles passing the property daily.

The property is easily accessible by major highways, including I-88 and conveniently surrounded by national retailers, restaurants and residential developments.

The surrounding area is home to a diverse demographic and Batavia, IL is a growing city with a 10% population increase over the past decade.

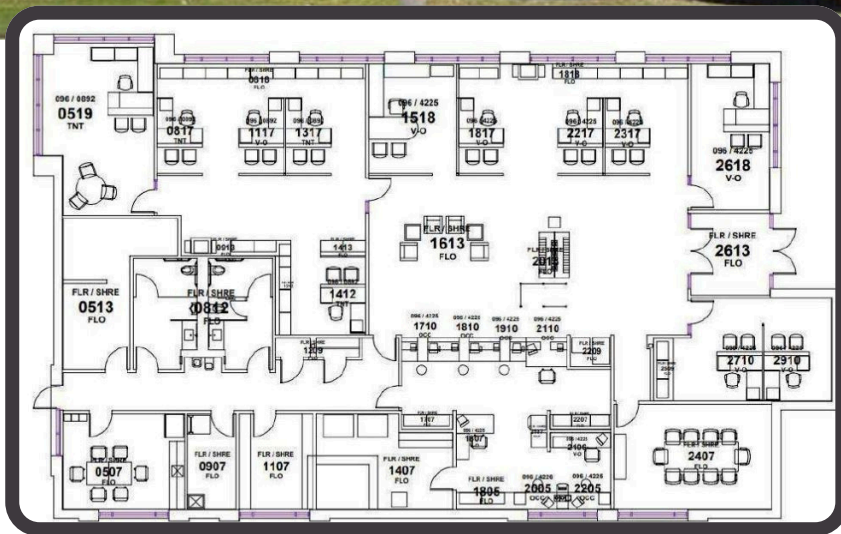

COMMERCIAL SPACE AVAILABLE!
RATE: \$25/SF/YR NNN
6,275 SQUARE FEET
\$3.02/SF/YR CAM
\$6.09/SF/YR RETAX

FOR LEASE

COMMERCIAL PROPERTY
1978 W. WILSON STREET
BATAVIA, IL 60510



FOR LEASE

COMMERCIAL PROPERTY
1978 W. WILSON STREET
BATAVIA, IL 60510

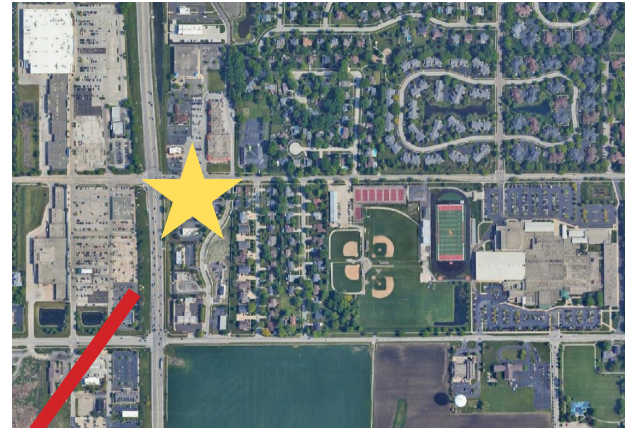

AREA MAP

Available SF: 6,275 SF
Lease Rate: \$25.00psf NNN
Lot Size: 1.3 Acres
Zoning: GC

Broker Contact:

Brad Schreiner
Managing Broker

630-457-1248
bschreiner@beicre.com

