



2000 MKT



Class A space available

2000 Market Street, Philadelphia, PA

Experience a DESTINATION

Featuring striking contemporary design, 2000 Market Street sets the new standard for workplace excellence. With extensive renovations completed in 2021, the building boasts 12 foot+ high ceilings, unobstructed city views, abundant natural light, and flexible, efficient floorplates accommodating users of all industries. New, pre-built suites are available for immediate occupancy and feature first-class finishes throughout, as well a variety of huddle and conference spaces. Tenants have unmatched access to exclusive amenities, including the tenant-only conferencing facility, private outdoor patio, on-site deli, and dedicated shuttle service transporting tenants to and from SEPTA and PATCO transit stations. Additionally, significant capital improvements have been invested in sustainability upgrades, including new energy-efficient cooling towers, LED light conversions throughout common areas, and overall efforts to reduce the building's electricity usage. From start to finish, 2000 Market delivers excellence into every part of the workday.

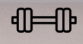
Building amenities:

- 
Fitness Center
 State-of-the-art indoor fitness center to be delivered in 2023
- 
Tenant Amenity Center
 Brand new conference facility and tenant lounge to be delivered in 2023
- 
Conference Facility
 3,000 SF tenant-only conference facility available free of charge
- 
Private Outdoor Patio
 Tenant-only private patio adjacent to the conference facility
- 
Food & Beverage
 On-site deli serving breakfast and lunch with both indoor and outdoor seating
- 
Shuttle Service
 Tenant-only dedicated shuttle service available during peak morning and evening hours transporting tenants to and from SEPTA



2,199 SF – 105,060 SF

AVAILABILITIES

27th Floor	9,037 SF
21st Floor	26,265 SF
20th Floor	26,265 SF
19th Floor	26,265 SF
18th Floor	26,265 SF
14th Floor	4,644 SF
	1,971 SF
12th Floor	25,666 SF
10th Floor	25,666 SF
9th Floor	4,263 SF (pre-built)
	3,891 SF (pre-built)
8th Floor	6,342 SF (pre-built)

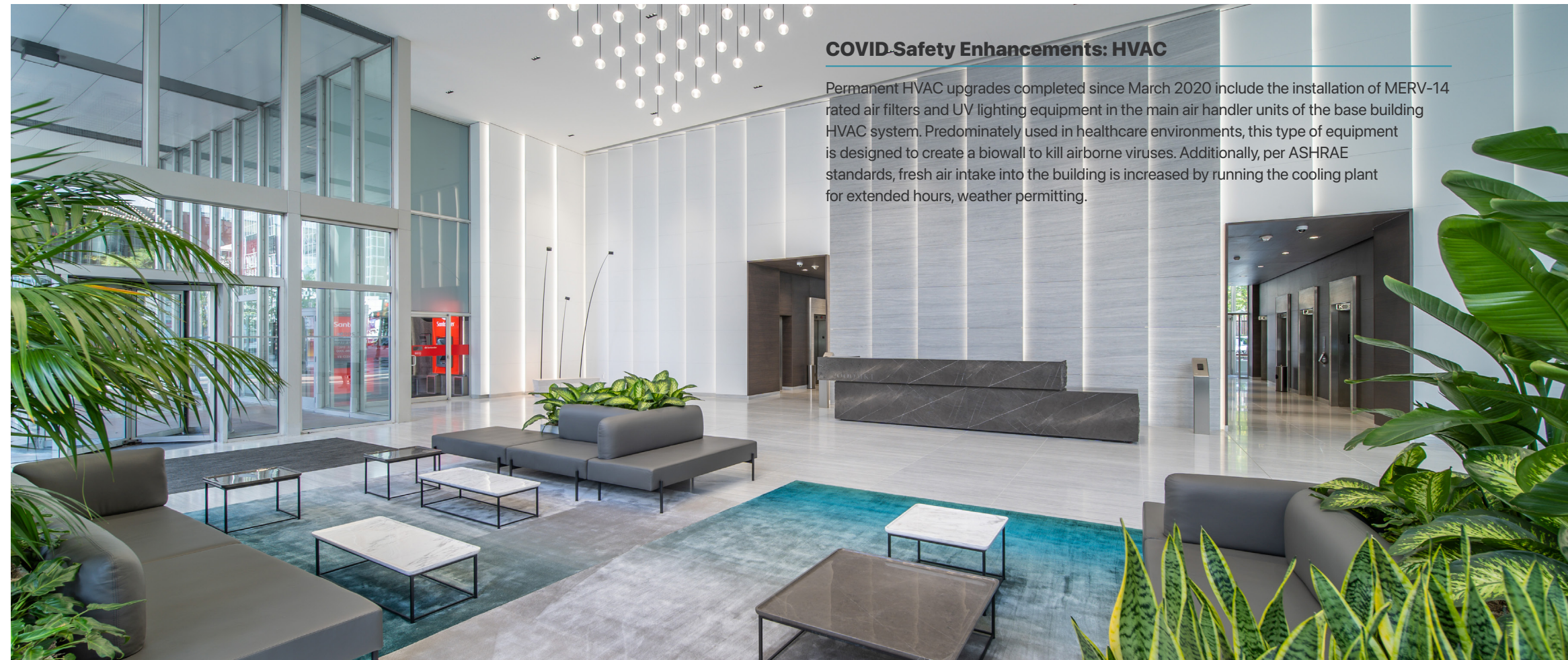

COVID-Safety Enhancements: HVAC

Permanent HVAC upgrades completed since March 2020 include the installation of MERV-14 rated air filters and UV lighting equipment in the main air handler units of the base building HVAC system. Predominately used in healthcare environments, this type of equipment is designed to create a biowall to kill airborne viruses. Additionally, per ASHRAE standards, fresh air intake into the building is increased by running the cooling plant for extended hours, weather permitting.

MARKET STREET

Typical floor plan

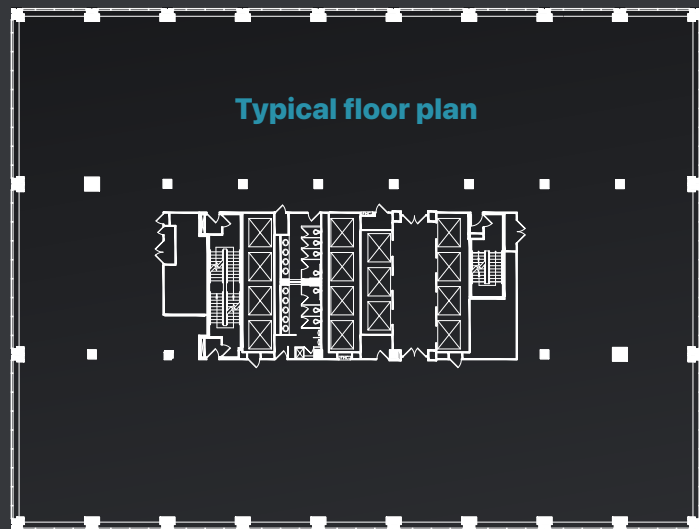

20TH STREET

Excellence in

ACCESS

2000 Market is centrally located in the Market West corridor, with easy access to public transportation and city hotspots.



Landmarks



Parking



Shuttle



Transportation



2000MKT

Contacts:

Kevin M. Maloney

+1 215 399 1833

kevin.maloney@jll.com

Katherine Hollingsworth

+1 215 282 4628

kat.hollingsworth@jll.com

David Mendez

+1 215 988 5563

david.mendez@jll.com

JLL | Jones Lang LaSalle Brokerage, Inc.

1650 Arch Street, Suite 2500

Philadelphia, PA 19103

+1 215 988 5500



Disclaimer: Although information has been obtained from sources deemed reliable, neither Owner nor JLL makes any guarantees, warranties or representations, express or implied, as to the complete-ness or accuracy as to the information contained herein. Any projections, opinions, assumptions or estimates used are for example only. There may be differences between projected and actual results, and those differences may be material. The Property may be withdrawn without notice. Neither Owner nor JLL accepts any liability for any loss or damage suffered by any party resulting from reliance on this information. If the recipient of this information has signed a confidentiality agreement regarding this matter, this information is subject to the terms of that agreement. ©2022. Jones Lang LaSalle IP, Inc. All rights reserved.