

25 West 14th Street

Between 5th & 6th Ave | Union Square

ksr
**RETAIL SPACE
FOR LEASE**

Solomon Tbeile David Green
917.215.5471 347.752.3350
STbeile@ksrny.com DGreen@ksrny.com

Ike Bibi
347.417.2860
IBibi@ksrny.com

ksr
**RETAIL SPACE
FOR LEASE**

Solomon Tbeile David Green
917.215.5471 347.752.3350
STbeile@ksrny.com DGreen@ksrny.com

Ike Bibi
347.417.2860
IBibi@ksrny.com

25 West 14th Street

Between 5th & 6th Ave | Union Square



SIZE: 3,469 SF Ground Floor

FRONTAGE: 35'

CEILING HEIGHTS: 18 ft

ASKING RENT: Upon Request

POSSESSION: Immediate

TRANSPORTATION:



HIGHLIGHTS:

- All uses considered
- Prominent signage opportunities
- Potential to expand to 6,580 SF by combining with adjacent store
- Close proximity to Union Square, Chelsea, & West Village
- Neighboring tenants include: *Popeye's, Baskin Robbins, CVS, The New School, Taco Bell, Joe Coffee, Chase, Pressed Juicery, Pinkberry, GNC, McDonald's, Chipotle, Think Coffee, Pratt*

CONTACT OUR BROKERS FOR MORE INFORMATION:

IKE BIBI

IBibi@ksrny.com
347.417.2860

DAVID GREEN

DGreen@ksrny.com
516.320.0260

SOLOMON TBEILE

STbeile@ksrny.com
917.215.5471

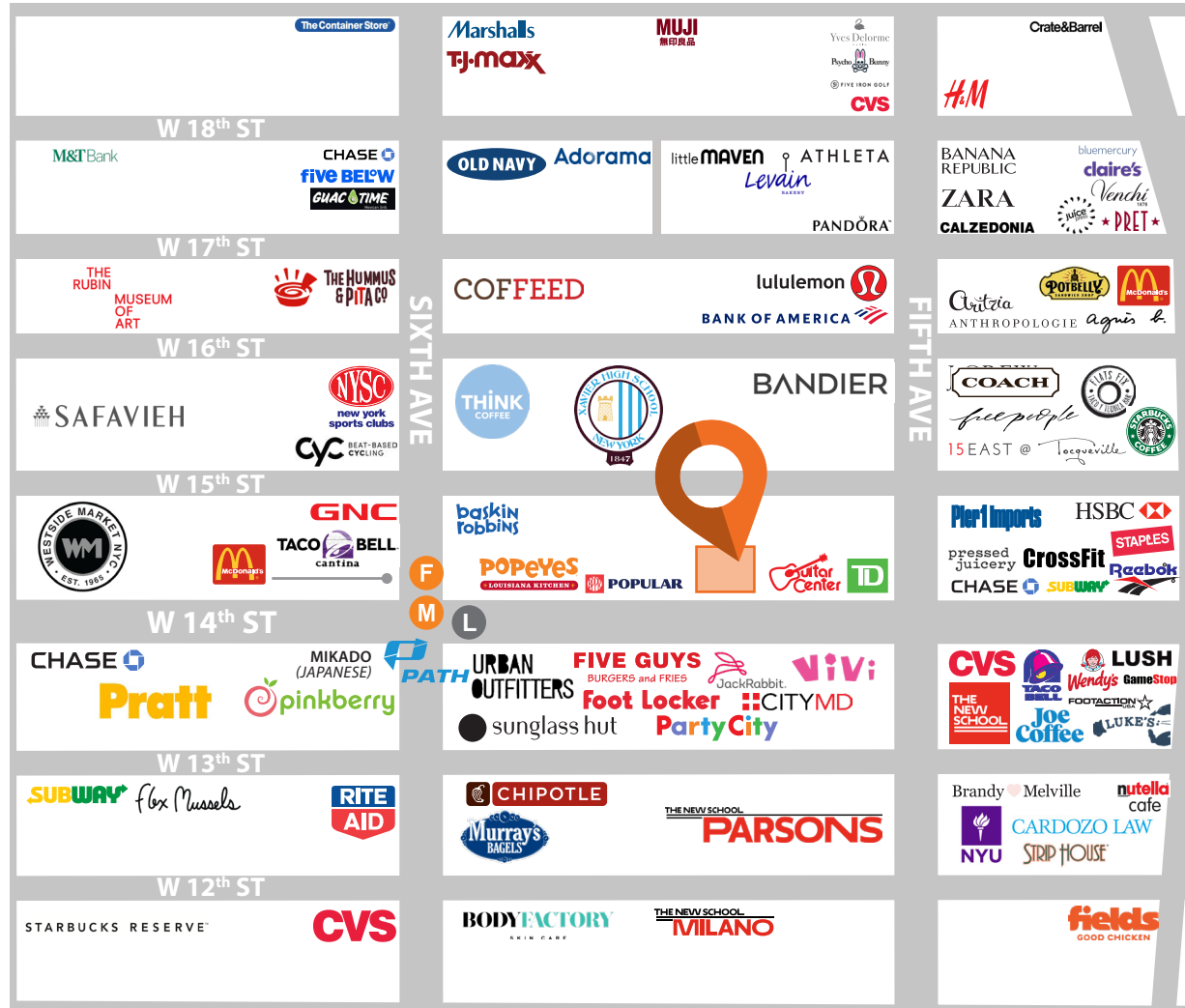

25 West 14th Street

Between 5th & 6th Ave | Union Square

Floor Plans:
Ground Floor - 3,469 SF

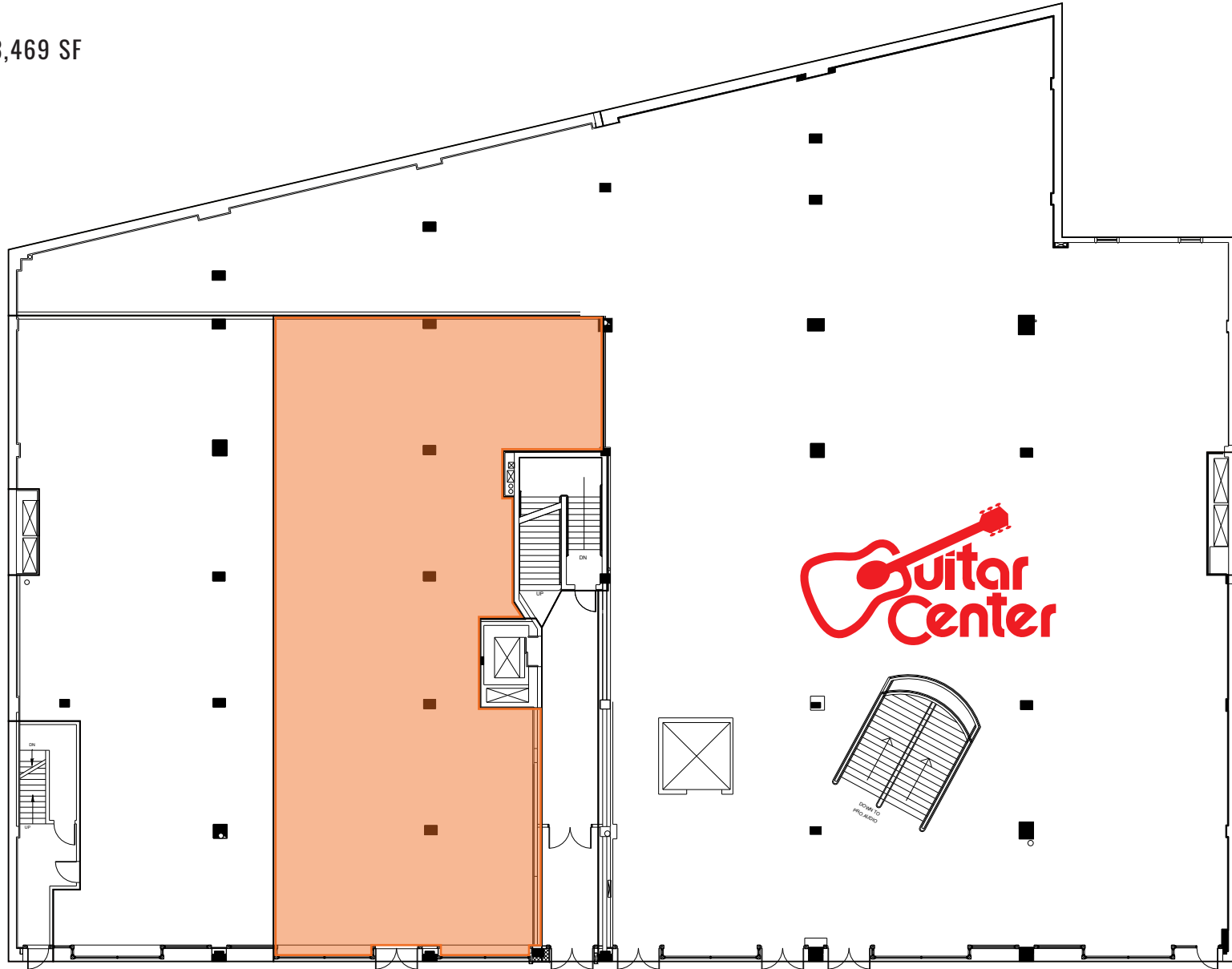

25 West 14th Street

Between 5th & 6th Ave | Union Square

Interiors:

