

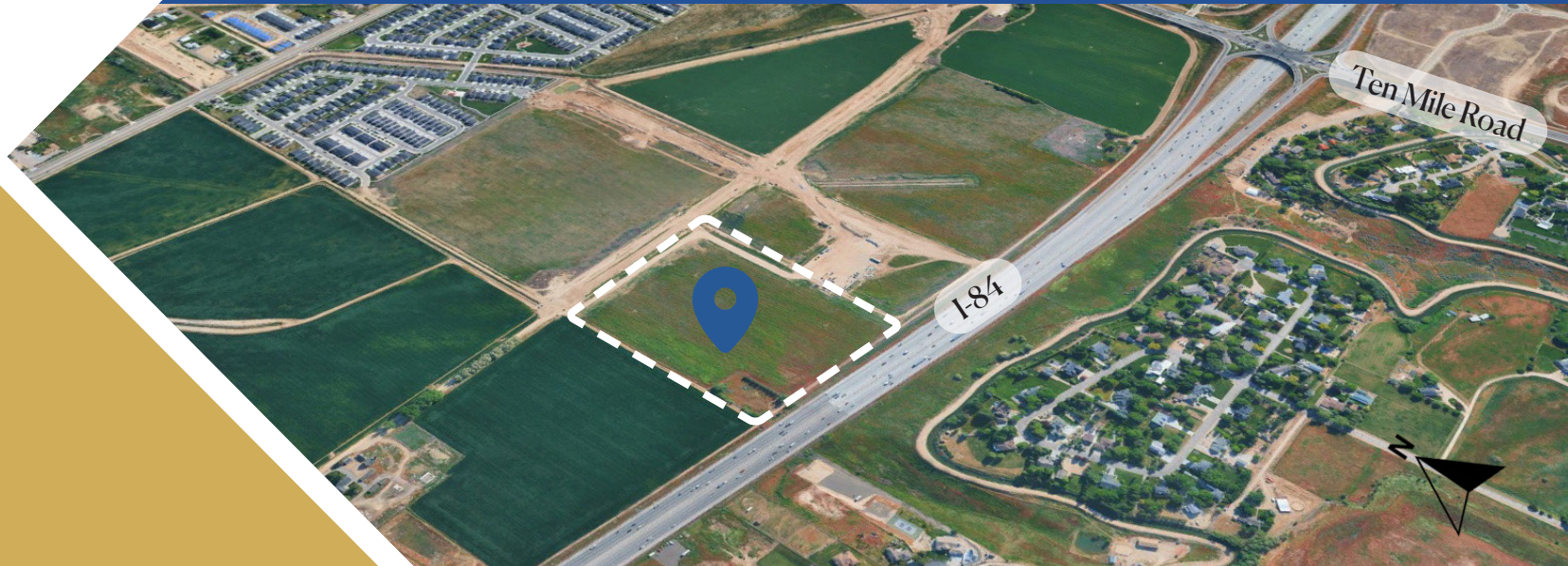

231,402 SF Industrial Space Ten Mile West

FUTURE ADDRESS: GRANDE MOGUL & LA VISTA | MERIDIAN, IDAHO



Property Highlights

- Two future divisible industrial spaces
- 129,717 SF and 101,685 SF available
- Close proximity to I-84
- Customizable Tenant Improvements Available
- Part of the upcoming The District development



Contact

Charity Nelson – Director of Leasing
cnelson@adler-industrial.com

adler-industrial.com

 (+1) 208-506-7170

 8665 W. Emerald Street, Suite 200,
Boise, ID 83704, USA



231,402 SF Industrial Space

Spec Building with Tennant Improvements



**FUTURE: GRAND MOGUL & LA VISTA
MERIDIAN, IDAHO**

Development Plan

Adler Industrial and our partners Ball Ventures, and Ahlquist are proud to present 231,402 of spec industrial space as part of the up and coming Ten Mile West development. Located due west of the Ten Mile Road exit of I-84. These 20 acres are zoned for light industrial, making it the perfect fit for businesses of all designs.

Future Development



For rates, please contact our
Leasing Manager





231,402 SF Industrial Space

Ten Mile West



**FUTURE: GRAND MOGUL & LA VISTA
MERIDIAN, IDAHO**



Access

Boise Airport	+/- 20 min / 14 miles
I-84 Interstate	+/- 2 min / 1 mile
Downtown Boise	+/- 20 min / 15 miles





ADLER
INDUSTRIAL

90+

**PROPERTIES ACQUIRED OR
DEVELOPED IN BOISE MSA**

Visit adler-industrial.com for more information



The largest industrial real estate
development and management
company in Idaho

Adler Industrial specializes in vertically integrated solutions for Class “A” industrial development, including developing, constructing, leasing, investing, and property management. With over 4 million square feet of acquired or developed buildings and 1,000 acres of land for future projects, we lead the market in providing comprehensive industrial solutions. Our sister company, Adler Realty Investments, founded in 1996, has acquired or developed 5.9 million square feet of properties, across all asset types nationwide.



Contact

Charity Nelson – Director of Leasing
cnelson@adler-industrial.com

adler-industrial.com

 (+1) 208-506-7170

 8665 W. Emerald Street, Suite 200,
Boise, ID 83704, USA