

4930 SE 26TH AVENUE



FOR SALE OR LEASE

4930 SE 26TH AVENUE | PORTLAND | OR | 97202

FOR MORE INFORMATION:

SCOTT MILLER

971.275.0341

scottm@capacitycommercial.com

ALLEN PATTERSON, SIOR

503.781.4015

allen@capacitycommercial.com

CAPACITY COMMERCIAL GROUP

805 SW Broadway, Suite 600

Portland, OR 97205

capacitycommercial.com



PROPERTY FEATURES

FOR SALE: 37,438 Total SF (11,066 SF Leased)

FOR LEASE: 26,372 SF w/ ± 2,078 SF Office

Complete Interior and Exterior Rehab Finished in 2024 Including:

- Fully Renovated Office with all New Fixtures
- Beautiful New Exterior Paint Scheme
- Interior Warehouse Walls Painted White
- 3 New Dock High Loading Doors (9' x 11')
- 3 New Grade-Level Loading Doors (12' x 14')
- New Motion-Sensing LED Lighting with Skylights
- New Roof Installed in 2022
- Fenced and Secured Loading Area with RFID Access
- Concrete Tilt-Up Construction - 20' Clear Height
- 480 Volt, Heavy 3-Phase Power Well Distributed

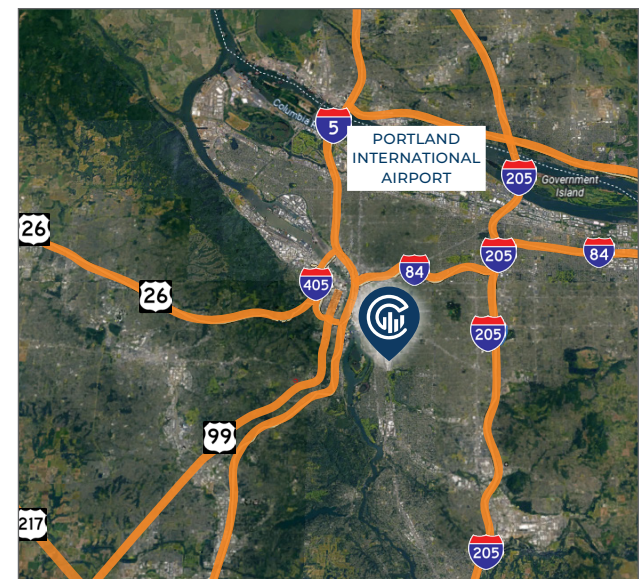

The information contained herein is believed to be accurate but is not warranted as to its accuracy and may change or be updated without notice. Seller or landlord makes no representation as to the environmental condition of the property and recommends purchaser's or tenant's independent investigation.

4930 SE 26TH AVENUE

SITE PLAN

UNDER NEW OWNERSHIP

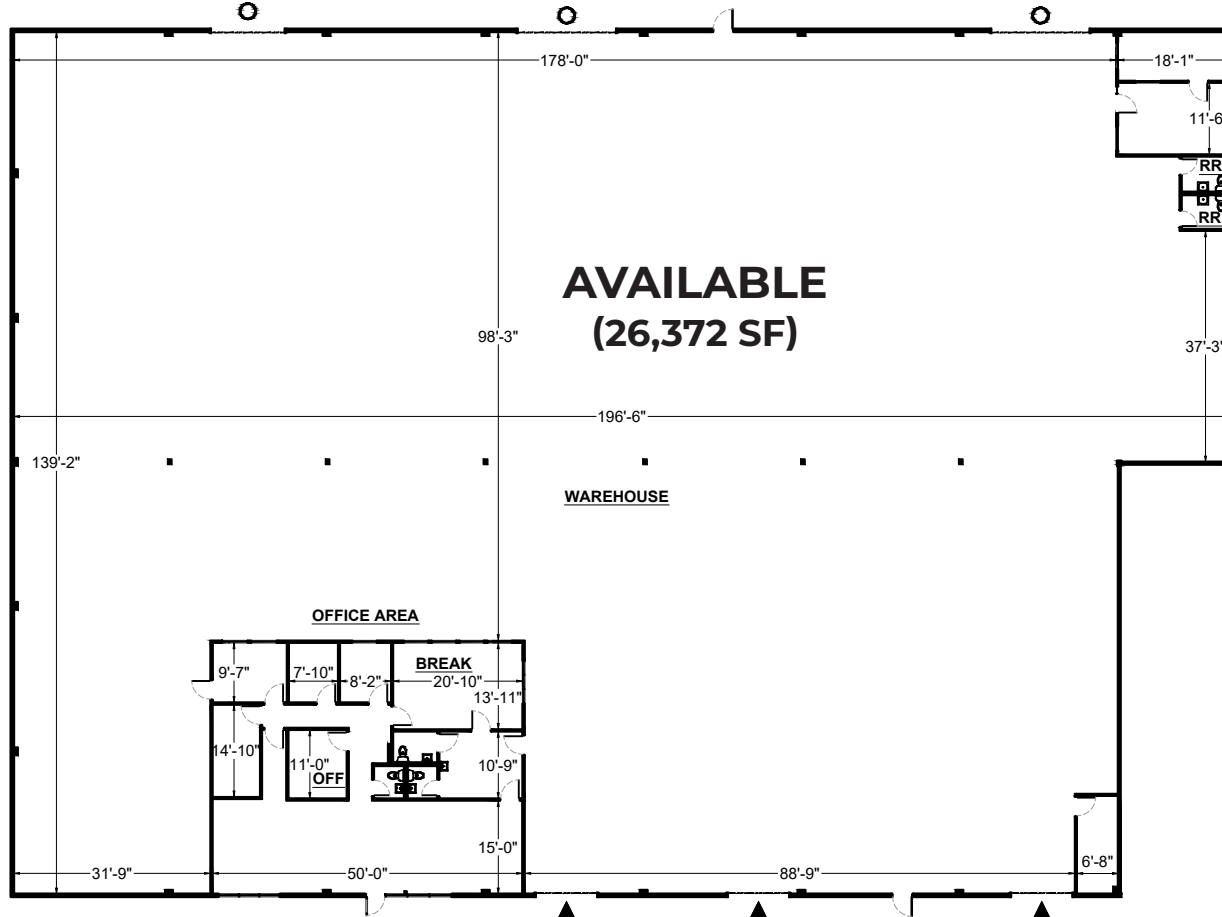

FOR MORE INFORMATION

SCOTT MILLER
 971.275.0341
 scottm@capacitycommercial.com

ALLEN PATTERSON, SIOR
 503.781.4015
 allen@capacitycommercial.com

CAPACITY COMMERCIAL GROUP
 805 SW Broadway, Suite 600
 Portland, OR 97205
 capacitycommercial.com

BUILDING KEY PLAN:



AVAILABLE
 OCCUPIED

4930 SE 26TH AVENUE
 PORTLAND, OR 97202



VACANT SUITE DATA

AREA	TOTAL SF
Office	2,078
Warehouse	24,294
Total	26,372