



Telfair Place Warehouse

25 Telfair Place, Garden City, Georgia 31415

• Available Units

- Suite A: ±8,800 SF | One drive-in door | Available 1/1/25
- Suite B: ±9,600 SF | One drive-in door | Available Now
- Suites can be combined for a total of ±18,400 SF
- Access to shared dock platform
- 24' - 30' eave height
- Heavy electrical - 3 phase power - 240 volts/400 amp max
- Equipped with ESFR sprinkler system
- Located on Telfair Place, just off of Chatham Parkway
- Easy access to Interstate-16 and Highway 80, just minutes away from Georgia Ports Authority's Garden City Terminal and Ocean Terminal

For Lease

Lease Rate:
Please
Inquire

Contact us:

David Sink, SIOR
Principal
+1 912 662 8010
david.sink@colliers.com

Zachary Zakas
Associate
+1 912 417 0009
zachary.zakas@colliers.com

Colliers | Savannah
545 E York Street
Savannah, GA 31401
Main: +1 912 233 7111
colliers.com/savannah

Accelerating success.

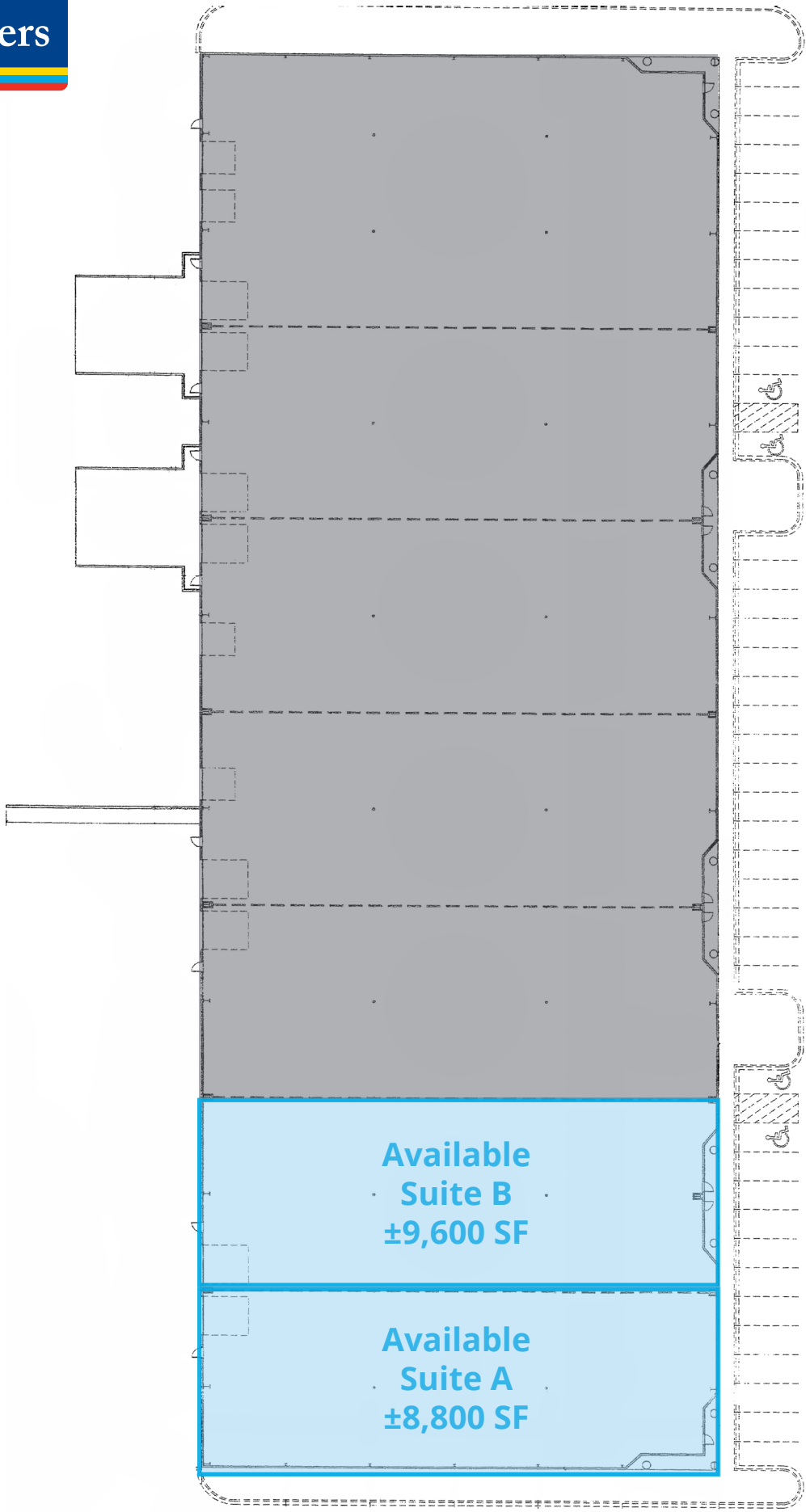

Floor Plan | Suite A

±8,800 SF

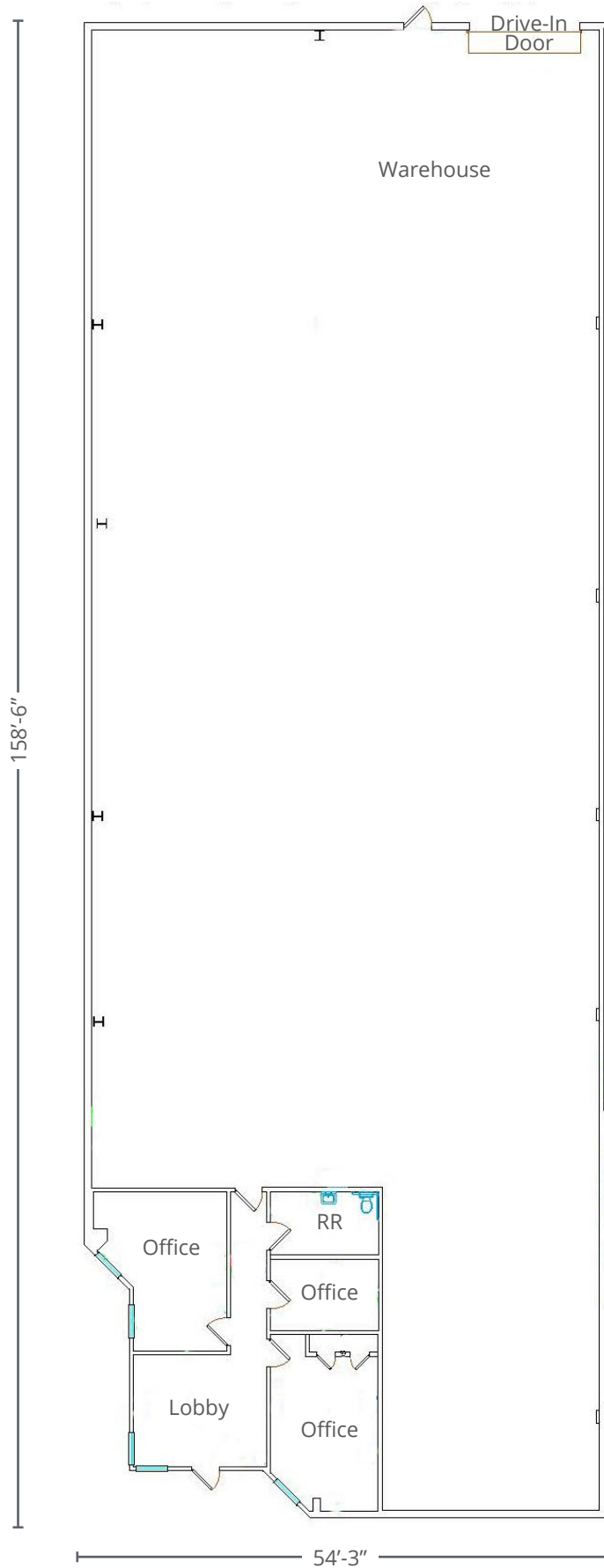

Floor Plan | Suite B

±9,600 SF





Property Location



Contact

David Sink, SIOR
Principal
+1 912 662 8010
david.sink@colliers.com

Zachary Zakas
Associate
+1 912 417 0009
zachary.zakas@colliers.com

Colliers | Savannah
545 E. York Street, Savannah, GA
+1 912 233 7111
colliers.com/savannah



This document has been prepared by Colliers International for advertising and general information only. Colliers International makes no guarantees, representations or warranties of any kind, expressed or implied, regarding the information including, but not limited to, warranties of content, accuracy and reliability. Any interested party should undertake their own inquiries as to the accuracy of the information. Colliers International excludes unequivocally all inferred or implied terms, conditions and warranties arising out of this document and excludes all liability for loss and damages arising there from. This publication is the copyrighted property of Colliers International and/or its licensor(s). ©2024. All rights reserved.