

318

MAUJER STREET EAST WILLIAMSBURG, BROOKLYN

Between Morgan Avenue & Waterbury Street

WAREHOUSE FOR LEASE

APPROXIMATE SIZE
2,400 SF

ASKING RENT
Upon Request

TERM
Negotiable

POSSESSION
Immediate

FRONTAGE
18 FT

CEILING HEIGHT
18 FT

COMMENTS

- Clean-raw condition warehouse with office space included
- 200 AMPs of electric
- Heating and sprinkler systems in place
- Drive-in gate
- Gate clearance 12.5 FT
- All uses considered

NEIGHBORS

Bella's Pierogies • Spelta • Popeyes • Frito Lay
• D&J Grocery • BP Gas Station • Dynamic Fitness • Variety Coffee • 1-800 Flowers

TRANSPORTATION

L



PROPERTY INFORMATION

JAMES FAMULARO
President

STEPHEN LIGAMBI
Associate
212.468.5985
sligambi@meridiancapital.com

JOSEPH HARARY
Associate
212.468.5978
jharary@meridiancapital.com



All information supplied is from sources deemed reliable and is furnished subject to errors, omissions, modifications, removal of the listing from sale or lease, and to any listing conditions, including the rates and manner of payment of commissions for particular offerings imposed by Meridian Capital Group. This information may include estimates and projections prepared by Meridian Capital Group with respect to future events, and these future events may or may not actually occur. Such estimates and projections reflect various assumptions concerning anticipated results. While Meridian Capital Group believes these assumptions are reasonable, there can be no assurance that any of these estimates and projections will be correct. Therefore, actual results may vary materially from these estimates and projections. Any square footage dimensions set forth are approximate.

318 MAUJER STREET

EAST WILLIAMSBURG, BROOKLYN | Between Morgan Avenue and Waterbury Street

WAREHOUSE FOR LEASE

INTERIOR



JAMES FAMULARO
President

STEPHEN LIGAMBI
Associate
212.468.5985
sligambi@meridiancapital.com

JOSEPH HARARY
Associate
212.468.5978
jharary@meridiancapital.com



All information supplied is from sources deemed reliable and is furnished subject to errors, omissions, modifications, removal of the listing from sale or lease, and to any listing conditions, including the rates and manner of payment of commissions for particular offerings imposed by Meridian Capital Group. This information may include estimates and projections prepared by Meridian Capital Group with respect to future events, and these future events may or may not actually occur. Such estimates and projections reflect various assumptions concerning anticipated results. While Meridian Capital Group believes these assumptions are reasonable, there can be no assurance that any of these estimates and projections will be correct. Therefore, actual results may vary materially from these estimates and projections. Any square footage dimensions set forth are approximate.

318 MAUJER STREET

EAST WILLIAMSBURG, BROOKLYN | Between Morgan Avenue and Waterbury Street

WAREHOUSE FOR LEASE

FLOOR PLAN

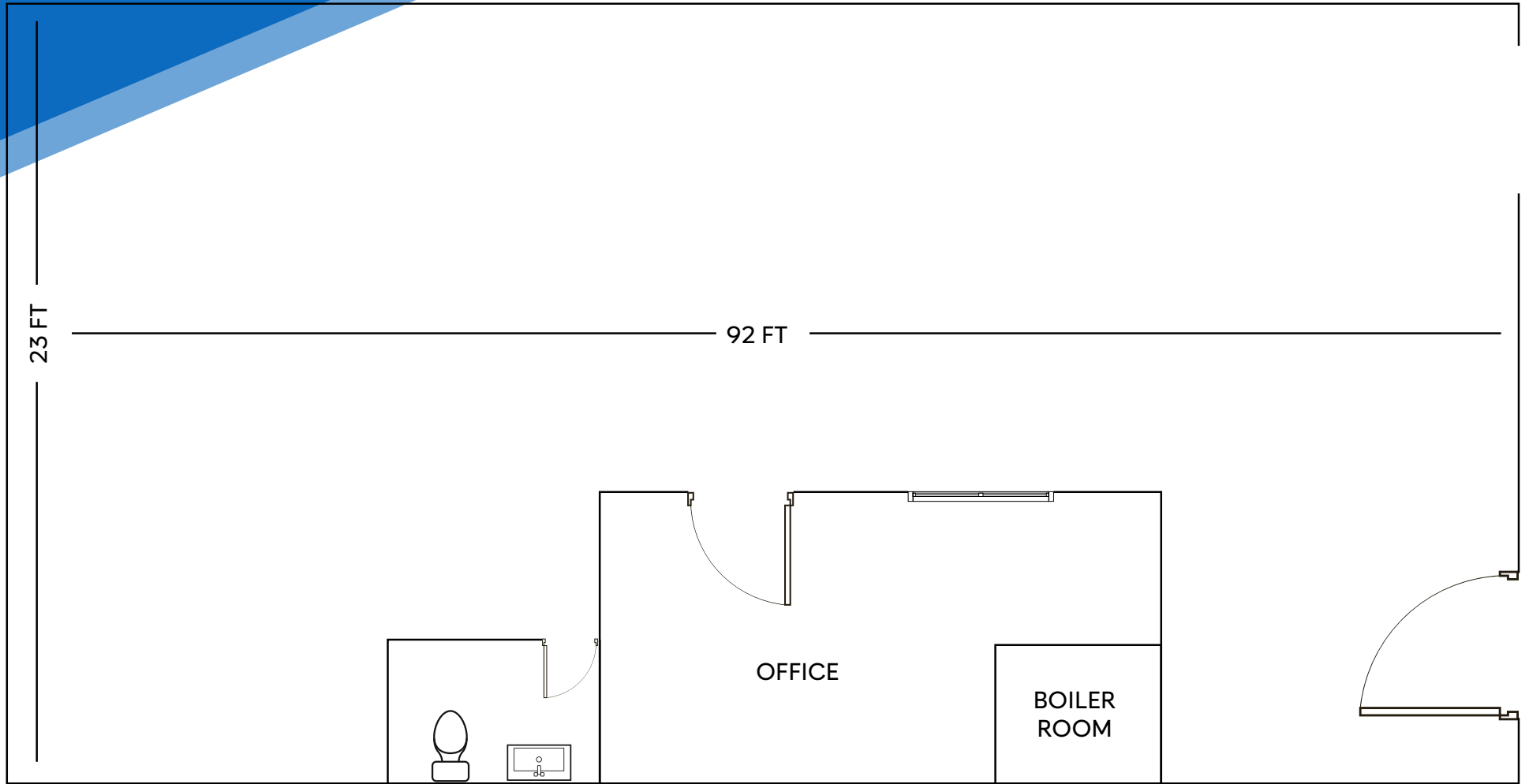

JAMES FAMULARO
President

STEPHEN LIGAMBI
Associate
212.468.5985
sligambi@meridiancapital.com

JOSEPH HARARY
Associate
212.468.5978
jharary@meridiancapital.com



All information supplied is from sources deemed reliable and is furnished subject to errors, omissions, modifications, removal of the listing from sale or lease, and to any listing conditions, including the rates and manner of payment of commissions for particular offerings imposed by Meridian Capital Group. This information may include estimates and projections prepared by Meridian Capital Group with respect to future events, and these future events may or may not actually occur. Such estimates and projections reflect various assumptions concerning anticipated results. While Meridian Capital Group believes these assumptions are reasonable, there can be no assurance that any of these estimates and projections will be correct. Therefore, actual results may vary materially from these estimates and projections. Any square footage dimensions set forth are approximate.

318 MAUJER STREET

EAST WILLIAMSBURG, BROOKLYN | Between Morgan Avenue and Waterbury Street

WAREHOUSE FOR LEASE



NEIGHBORS

JAMES FAMULARO
President

STEPHEN LIGAMBI
Associate
212.468.5985
sligambi@meridiancapital.com

JOSEPH HARARY
Associate
212.468.5978
jharary@meridiancapital.com



All information supplied is from sources deemed reliable and is furnished subject to errors, omissions, modifications, removal of the listing from sale or lease, and to any listing conditions, including the rates and manner of payment of commissions for particular offerings imposed by Meridian Capital Group. This information may include estimates and projections prepared by Meridian Capital Group with respect to future events, and these future events may or may not actually occur. Such estimates and projections reflect various assumptions concerning anticipated results. While Meridian Capital Group believes these assumptions are reasonable, there can be no assurance that any of these estimates and projections will be correct. Therefore, actual results may vary materially from these estimates and projections. Any square footage dimensions set forth are approximate.