

# JOIN BANK OF AMERICA & DAVID'S SHOES

113-117 FIRST STREET - EAST CAMBRIDGE, MA | KENDALL SQUARE  
1,241 SF STREET LEVEL



RETAIL SPACE FOR LEASE • 113-117 FIRST STREET • EAST CAMBRIDGE, MA • 1,241 SF 

# SITE PLAN

1/2 Acre  
Open Park Area



RETAIL SPACE FOR LEASE • 113-117 FIRST STREET • EAST CAMBRIDGE, MA • 1,241 SF 

# FLOOR PLAN

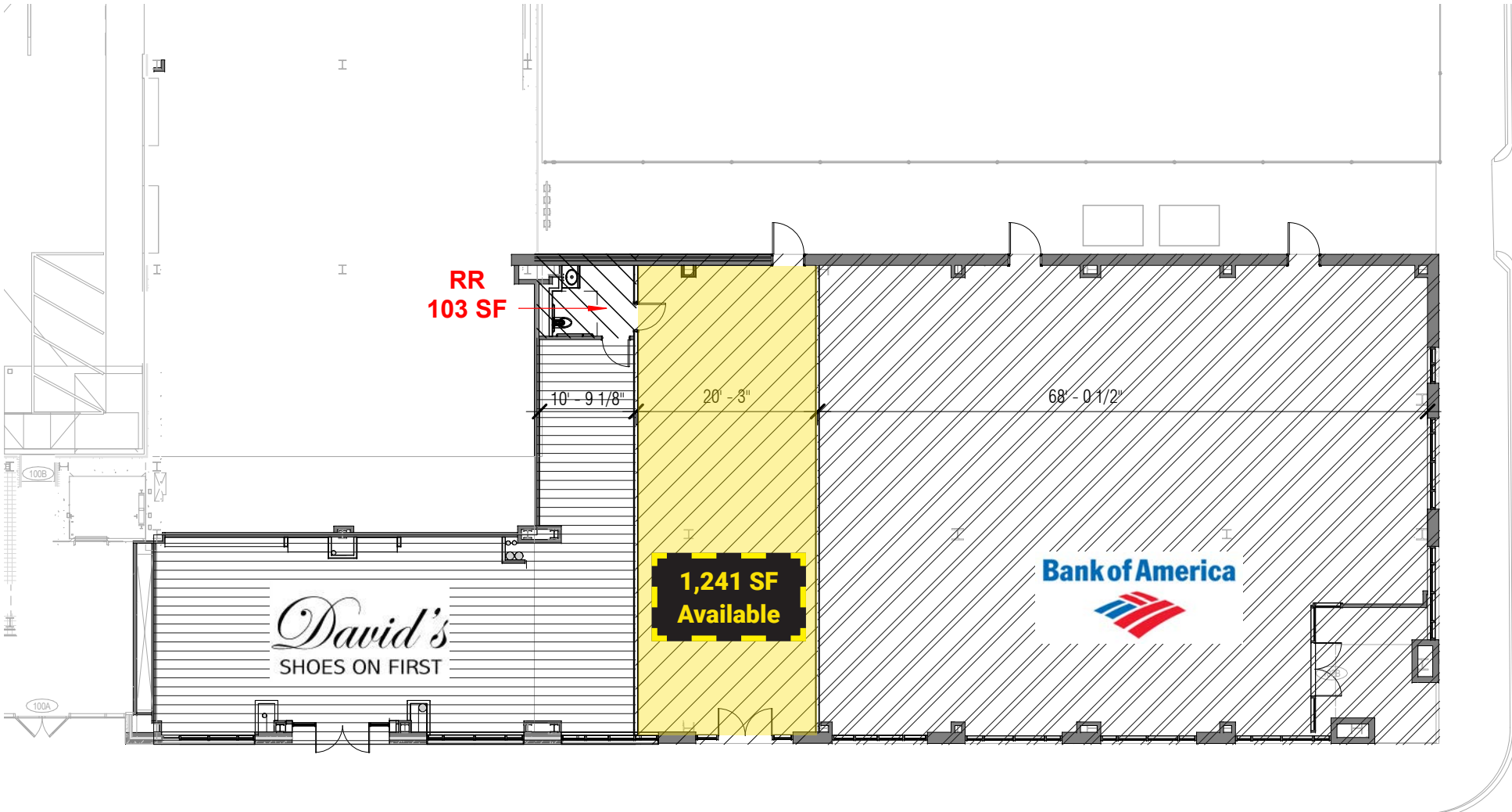

# CLOSE AERIAL

**D: 40 Thorndike**  
500K SF  
422 SF Office  
48 Residential Units  
362 Parking Spaces  
15K Retail

**C: 35 First Street**  
First Street Garage  
1,400 Parking Spaces  
10K SF Retail (Programmed)

**A: Cambridge Crossing**  
2.1M SF Commercial  
2.4M SF Residential  
100K SF Retail / Restaurant

**B: Cambridge Galleria**  
2M SF Retail/Office/Hotel/Residential  
**100 Cambridgeside**  
162K SF - Smart Lab  
**20 Cambridgeside**  
366K SF Labs/Office  
25K SF Retail  
**60 First Street - Lab**  
**150 Cambridgeside Place**  
Residential

**T Lechmere MBTA**

**G: 85 First Street**  
9,943 SF Retail  
**4,575 SF Available**

**F: 113-117 First Street**  
58,200 SF  
**1,241 SF Available** ★  
Office

**E: 109 First Street**  
136 Residential Units  
13K SF Retail

**Logos:** Encore BOSTON HARBOR, AREI, LAMPLIGHTER BREWING CO., SANOFI, PHILIPS, Bristol Myers Squibb, Starbucks, CS CAMBRIDGESIDE, Bank of America, David's SHOES ON FIRST, SHERWIN-WILLIAMS, UNITED STATES POSTAL SERVICE.

RETAIL SPACE FOR LEASE • 113-117 FIRST STREET • EAST CAMBRIDGE, MA • 1,241 SF 

# MAP

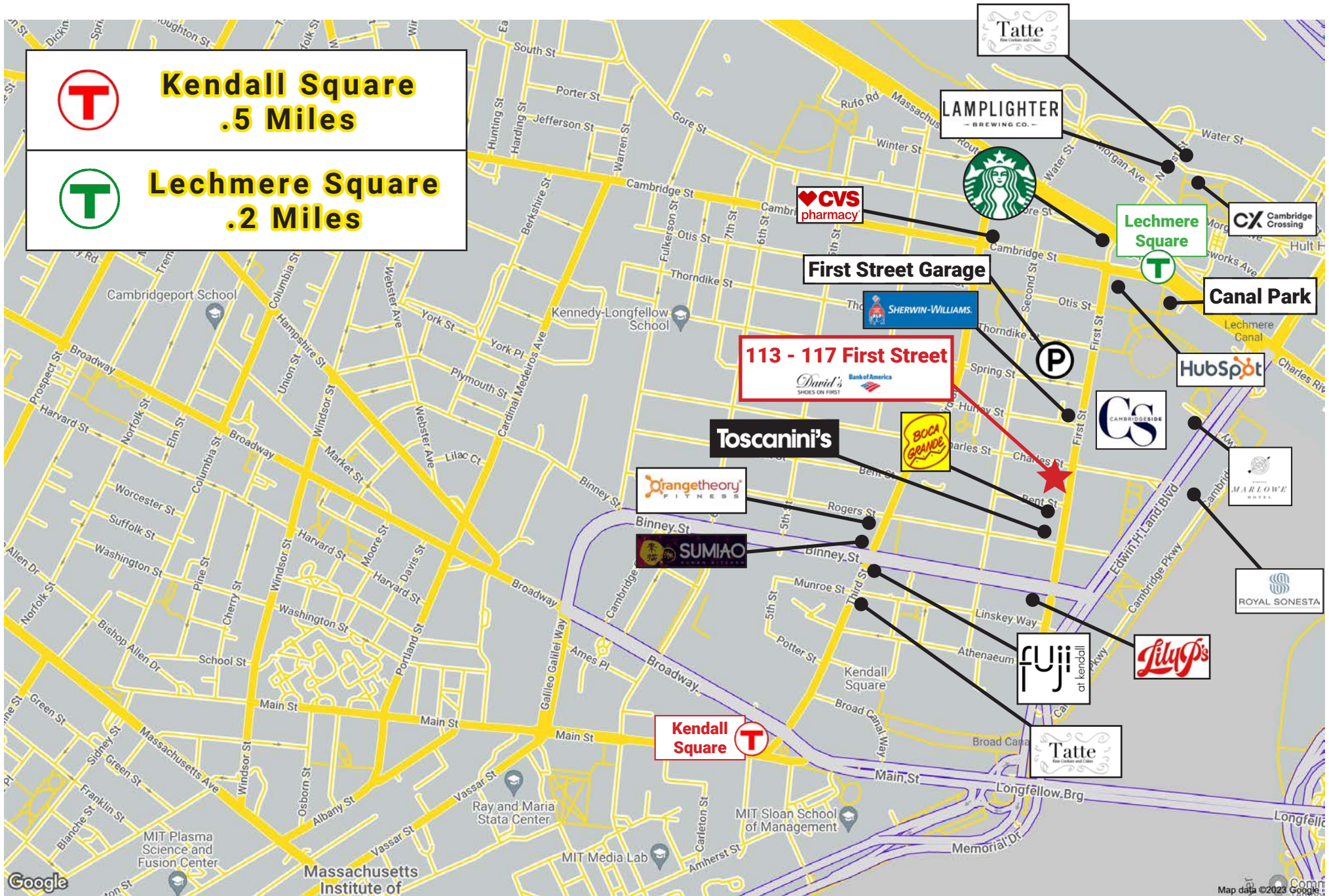

RETAIL SPACE FOR LEASE • 113-117 FIRST STREET • EAST CAMBRIDGE, MA • 1,241 SF 

# Find Your Place.

**LANDLORD / DEVELOPER**

URBAN SPACES

**ADAM CONVISER**

**ADAM@CONVISERPG.COM**

**MOBILE: (617) 593-1700**

**JIM CONVISER**

**JIM@CONVISERPG.COM**

**MOBILE: (781) 839-0456**



**CONVISER PROPERTY GROUP, INC**

**220 RESERVOIR STREET, SUITE 9 • NEEDHAM, MA 02494**

**O: (781) 320-0600 • F: (781) 791-4599 • WWW.CONVISERPG.COM**

RETAIL SPACE FOR LEASE • 113-117 FIRST STREET • EAST CAMBRIDGE, MA • 1,241 SF



Ver: 12.1.23