



COMMERCIAL & RESIDENTIAL
MANAGEMENT GROUP

SPACE FOR LEASE

CANBY CIVIC BLOCK

182 NORTH HOLLY ST, CANBY OR 97013



THE DAHLIA

CITY HALL

POLICE BUILDING

**CALL OR EMAIL
FOR A TOUR!**

SPACE DETAILS:

THE DAHLIA: NO AVAILABLE SPACES

CITY HALL: AVAILABLE

POLICE BUILDING: AVAILABLE



SCOTT WEIGEL | BROKER | SCOTTW@CRMGCO.COM | (503) 802-2538
JILL KEOPPEL | PRINCIPAL BROKER | JILLK@CRMGCO.COM | (971) 353-2079
WWW.CRMGCO.COM | 9400 SW BARNES RD, PORTLAND, OR 97225

The information in this package was gathered from sources deemed reliable, however C&R Management Group makes no representation or warranty of the accuracy of the information. Any buyer or tenant considering purchase or lease of this property should confirm any and all information relied upon in making the decision to purchase or lease prior to finalizing the transaction and bears the risk of all inaccuracies.



HISTORIC CANBY CITY HALL

182 NORTH HOLLY ST, CANBY OR 97013

Modern convenience, with character

The Historic City Hall building at the corner of 2nd and Holly. Built as part of the WPA effort, this 1937 building has been beautifully restored to its original glory. Located in the center of Canby's historic downtown. The city's original jail which dates back to the early 1900's is attached to the city hall building.

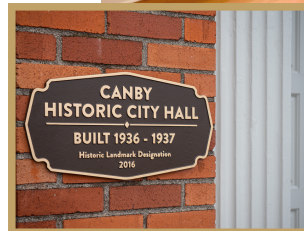

Available:

Main Floor - 1,800 SF
\$28 SF/YR, NNN

Basement - 1,800 SF
\$18 SF/YR, NNN



SCOTT WEIGEL | BROKER | SCOTTW@CRMGCO.COM | (503) 802-2538
JILL KEOPPEL | PRINCIPAL BROKER | JILLK@CRMGCO.COM | (971) 353-2079
WWW.CRMGCO.COM | 9400 SW BARNES RD, PORTLAND, OR 97225

The information in this package was gathered from sources deemed reliable, however C&R Management Group makes no representation or warranty of the accuracy of the information. Any buyer or tenant considering purchase or lease of this property should confirm any and all information relied upon in making the decision to purchase or lease prior to finalizing the transaction and bears the risk of all inaccuracies.



HISTORIC CANBY CITY HALL

182 NORTH HOLLY ST, CANBY OR 97013

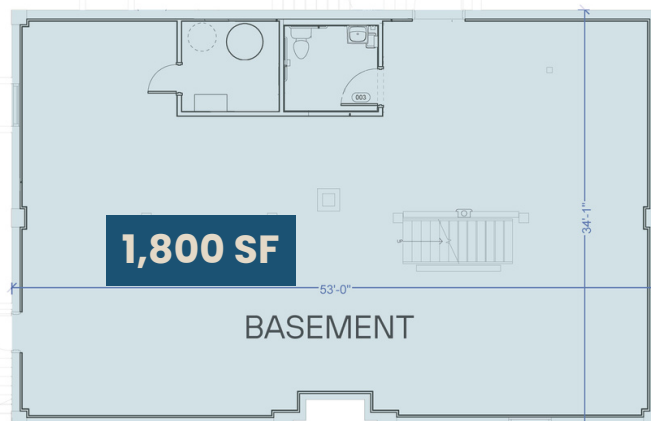
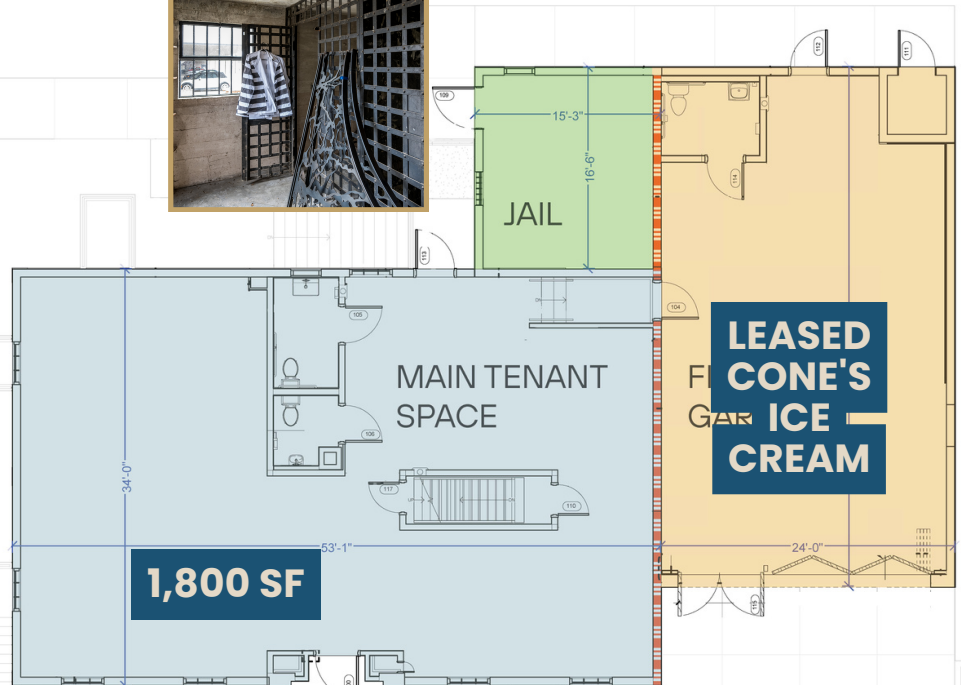

SCOTT WEIGEL | BROKER | SCOTTW@CRMGCO.COM | (503) 802-2538
JILL KEOPPEL | PRINCIPAL BROKER | JILLK@CRMGCO.COM | (971) 353-2079
WWW.CRMGCO.COM | 9400 SW BARNES RD, PORTLAND, OR 97225

The information in this package was gathered from sources deemed reliable, however C&R Management Group makes no representation or warranty of the accuracy of the information. Any buyer or tenant considering purchase or lease of this property should confirm any and all information relied upon in making the decision to purchase or lease prior to finalizing the transaction and bears the risk of all inaccuracies.



THE POLICE BUILDING

120 NORTH HOLLY ST, CANBY OR 97013

Industrial and historic space with modern upgrades

Located on the south end of Holly Street. originally built in 1926, is The Police Building, one of many spaces for use in the Canby Civic Block. While still maintaining many of the original features including, exposed timber ceiling, preserved brick wall with original paint lettering, the space has also seen many upgrades. Brand new windows as well as new restrooms were updated.

Available:

The Police Building
6,000 SF
\$22 SF/YR, NNN



SCOTT WEIGEL | BROKER | SCOTTW@CRMGCO.COM | (503) 802-2538
JILL KEOPPEL | PRINCIPAL BROKER | JILLK@CRMGCO.COM | (971) 353-2079
WWW.CRMGCO.COM | 9400 SW BARNES RD, PORTLAND, OR 97225

The information in this package was gathered from sources deemed reliable, however C&R Management Group, makes no representation or warranty of the accuracy of the information. Any buyer or tenant considering purchase or lease of this property should confirm any and all information relied upon in making the decision to purchase or lease prior to finalizing the transaction and bears the risk of all inaccuracies.



THE POLICE BUILDING

120 NORTH HOLLY ST, CANBY OR 97013

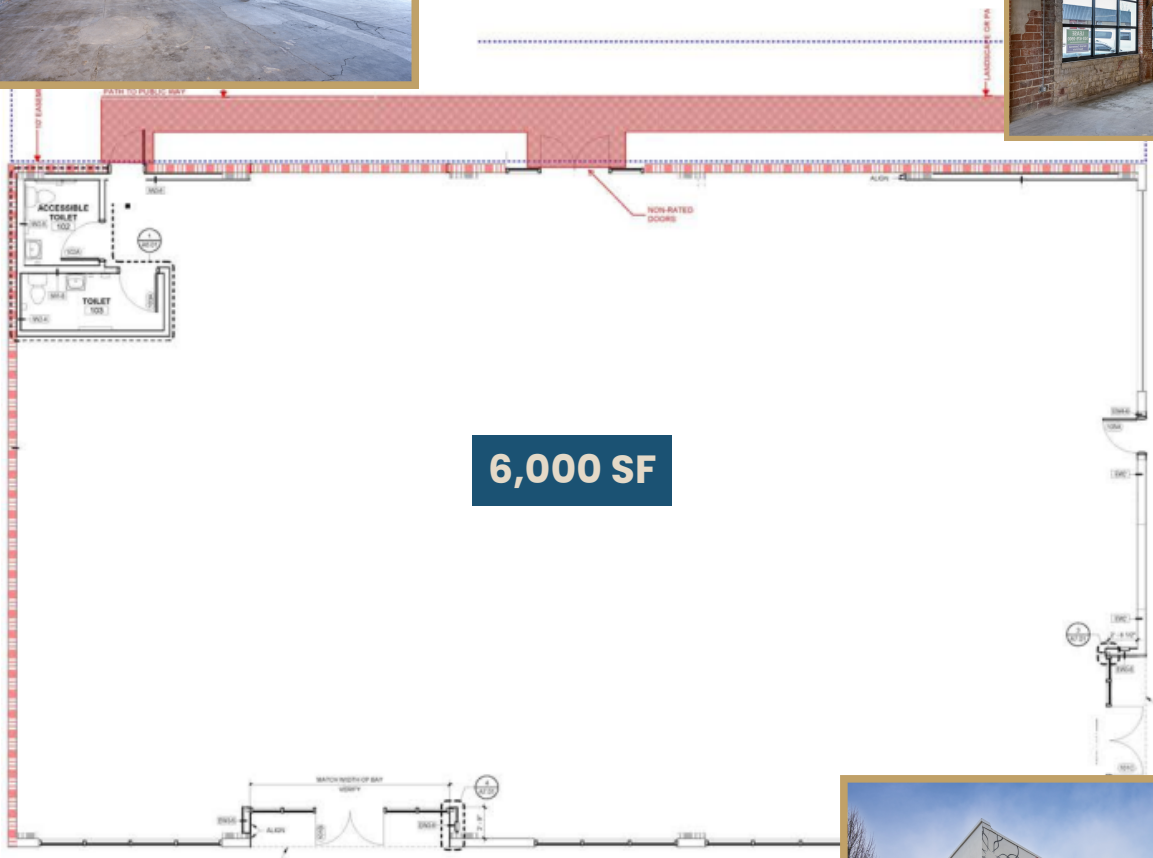

SCOTT WEIGEL | BROKER | SCOTTW@CRMGCO.COM | (503) 802-2538
JILL KEOPPEL | PRINCIPAL BROKER | JILLK@CRMGCO.COM | (971) 353-2079
WWW.CRMGCO.COM | 9400 SW BARNES RD, PORTLAND, OR 97225

The information in this package was gathered from sources deemed reliable, however C&R Management Group makes no representation or warranty of the accuracy of the information. Any buyer or tenant considering purchase or lease of this property should confirm any and all information relied upon in making the decision to purchase or lease prior to finalizing the transaction and bears the risk of all inaccuracies.