



Prime Harlem Fully Fixtured Restaurant For Lease on High Traffic Shopping Corridor

100 WEST 125TH STREET
NEW YORK, NY

NEWMARK

100 WEST 125TH STREET

Property Details

Location

Between Lenox Avenue and Adam Clayton Powell Jr. Boulevard

Approximate Size

Second Floor Approx. 10,500 SF

Ceiling Heights

Second Floor Approx. 14 FT

Site Status

Formerly Olive Garden

Term

Long term

Possession

Immediate

Neighbors

Whole Foods Market, Raymour & Flanigan Furniture, TD Bank, Burlington, H&M, JD Sports, Raising Canes, Victoria's Secret, PINK, Planet Fitness, Snipes, Bath & Body Works, Apollo Theater, Marshalls, CVS Pharmacy, CityMD, T.J. Maxx, Starbucks, Sylvia's, Chipotle Mexican Grill, Sephora, Pandora, Chase Bank, Target and Trader Joe's

Comments

Sublet through Dec. 31, 2026, **long term direct lease available**

Multi-million dollar turnkey installation, kitchen and bar

Entry on first floor via common hallway with escalator and elevator

Access to common freight elevator behind retail space on the second floor

All retail uses considered

Across from 125th Street subway station servicing the **2** and **3** trains and within walking distance to the **MTA Metro-North Railroad** and the **4** **5** and **6** trains at 125th Street

Second Floor

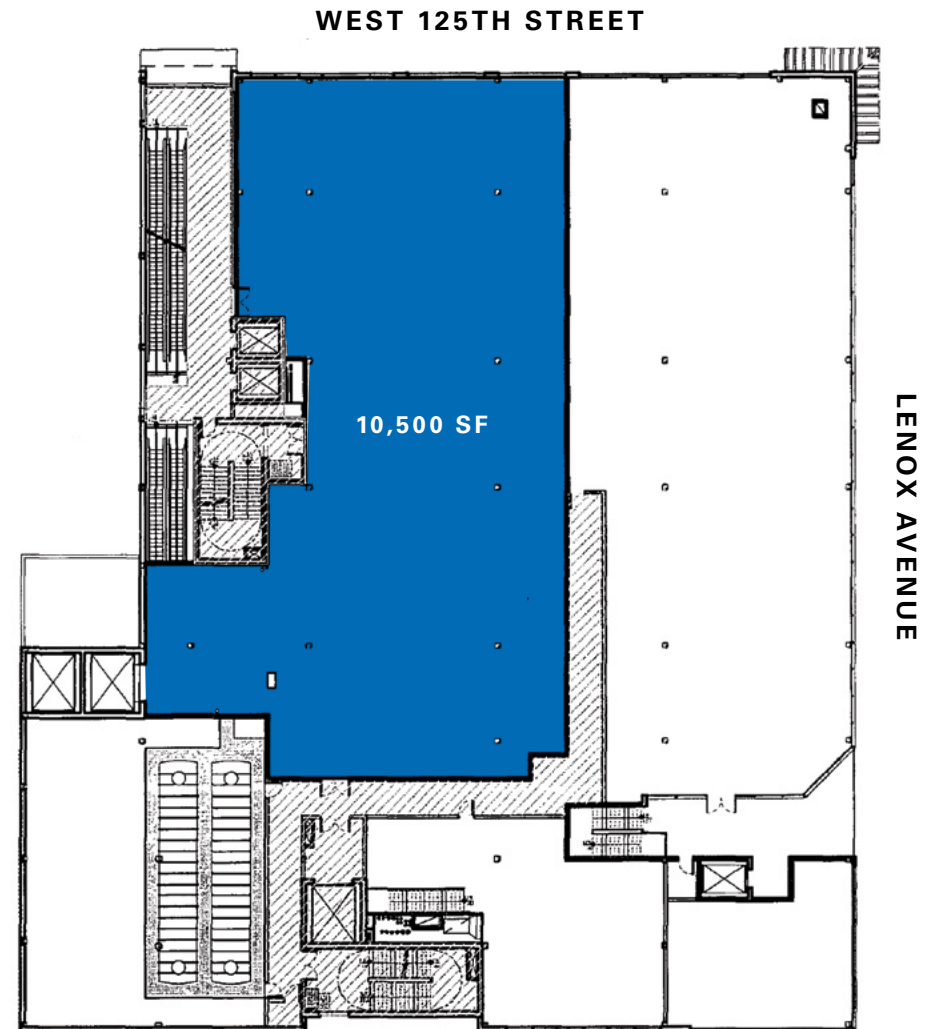

ENTRANCE AND INTERIOR PHOTOS

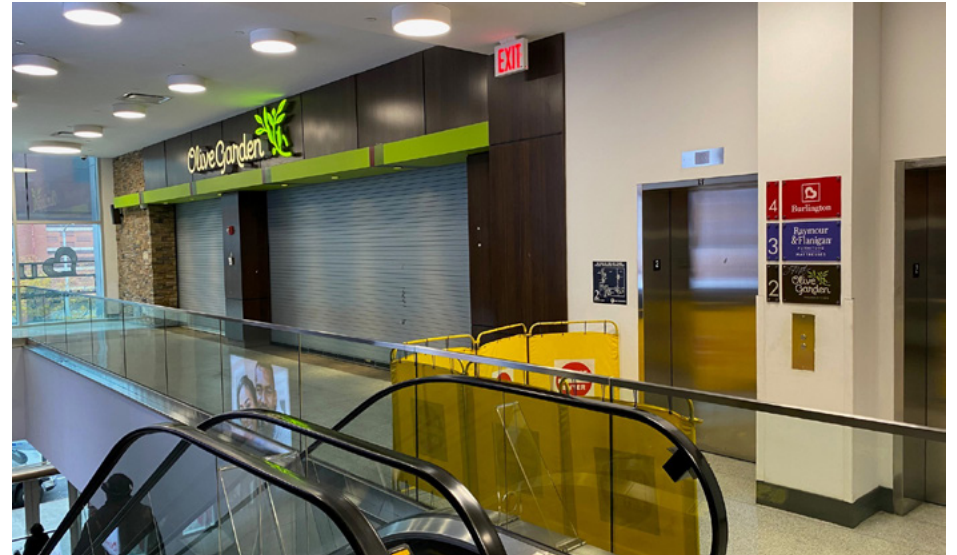

AREA RETAIL

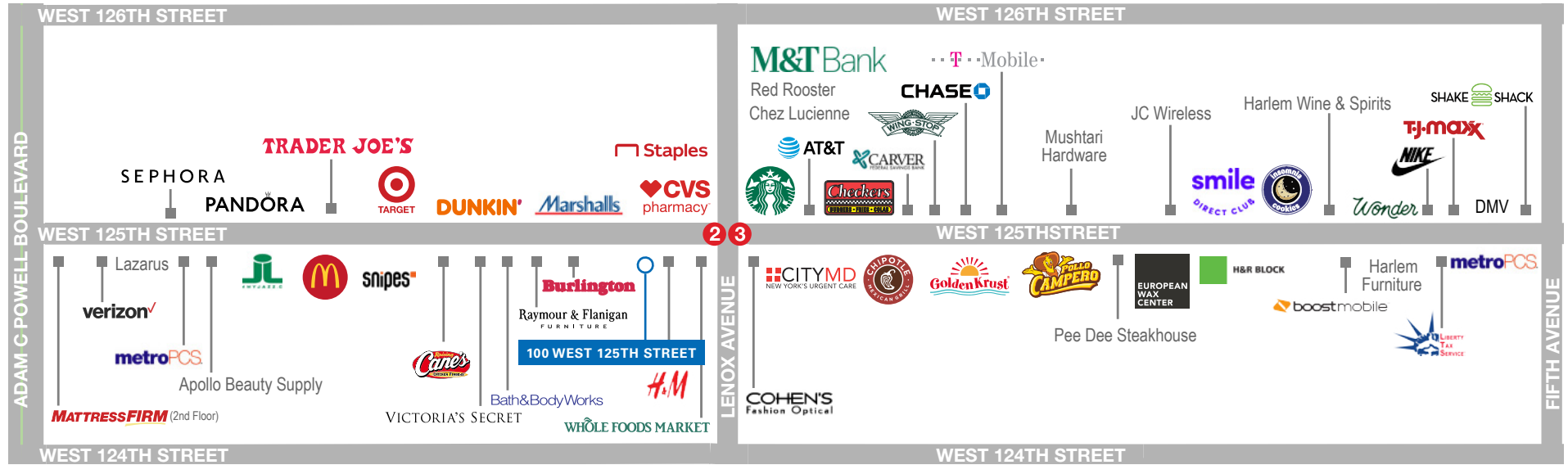

CONTACTS

Craig Slosberg

t 212-372-2398

craig.slosberg@nmrk.com

Jeffrey D Roseman

t 212-372-2430

jeffrey.roseman@nmrk.com

nmrk.com

The information contained herein has been obtained from sources deemed reliable but has not been verified and no guarantee, warranty or representation, either express or implied, is made with respect to such information. Terms of sale or lease and availability are subject to change or withdrawal without notice.