

FOR SUBLEASE

±13,569 SF FREESTANDING INDUSTRIAL SPACE

13201 Barton Circle, Santa Fe Springs, CA



PROPERTY FEATURES

- Freestanding Industrial Building
- ±3,600 SF of Office/Showroom Space
- One (1) Oversized Ground Level Loading Door 12' H x 18' W
- Fire Spinklers
- ±16' Ceiling Height
- Heavy Power, 800 Amps, 277/480V (verify)
- Great Corner Location
- Excellent Access to the Santa Ana (5), San Gabriel (605) and Century (105) Freeways
- Long Term Direct Deal Possible

Sublease Term Through November 30, 2025

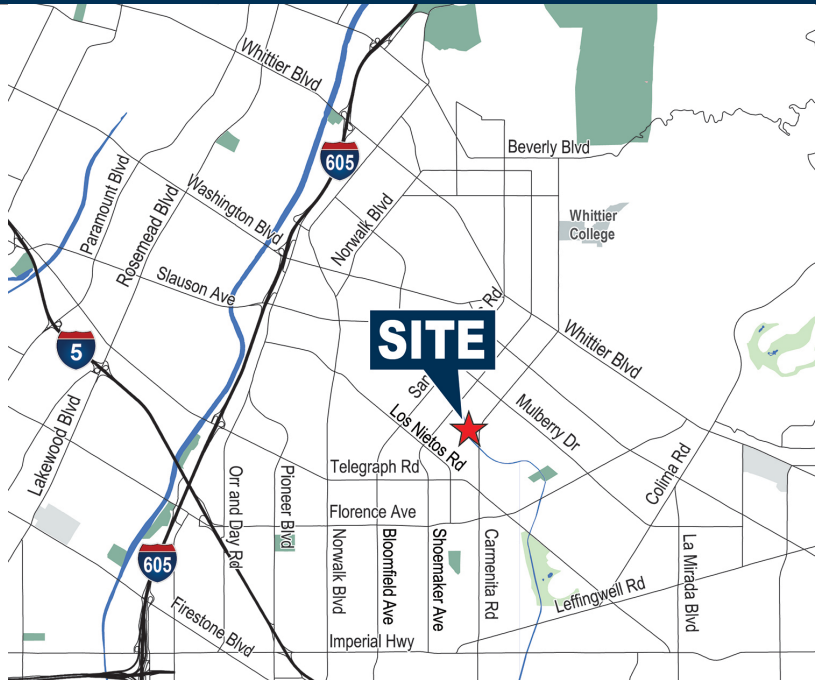

SELDEN MCKNIGHT
Senior Vice President | Partner
(714) 935-2323
smcknight@voitco.com
License #02027919

STAN KWAK
Senior Vice President | Partner
(714) 526-1111
skwak@voitco.com
License #01824776

JORDAN HAYNES
Associate
(213) 269-5000
jhaynes@voitco.com
License #02083655

Voit

REAL ESTATE SERVICES

2400 E. Katella Avenue, Suite 750
Anaheim, CA 92806
License #01991785

CLIENT
RESOURCE GROUP

www.voitco.com

FOR SUBLEASE

±13,569 SF FREESTANDING INDUSTRIAL SPACE

13201 Barton Circle, Santa Fe Springs, CA

SITE PLAN

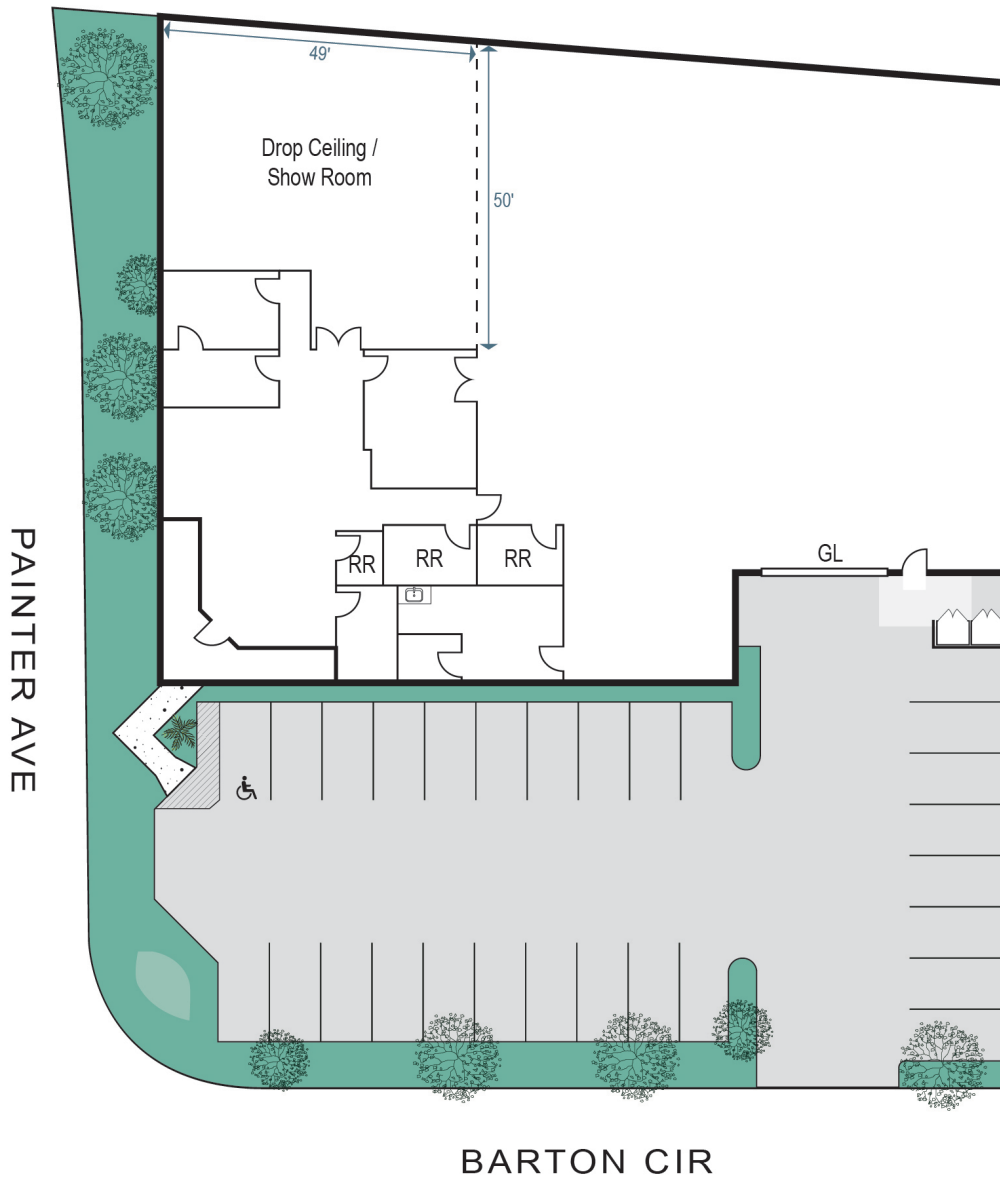

Site plan not to scale and is subject to change. Tenant to independently verify all sizes

SELDEN MCKNIGHT
Senior Vice President | Partner
(714) 935-2323
smcknight@voitco.com
License #02027919

STAN KWAK
Senior Vice President | Partner
(714) 526-1111
skwak@voitco.com
License #01824776

JORDAN HAYNES
Associate
(213) 269-5000
jhaynes@voitco.com
License #02083655

Voit
REAL ESTATE SERVICES
2400 E. Katella Avenue, Suite 750
Anaheim, CA 92806
License #01991785



www.voitco.com