

# South Waterloo Business Park

Hwy 20 & Ansborough Ave  
Waterloo, Iowa

135,000 SF Building



## Contact Us

**Mike Macri III, CCIM, MRED, CRE**

Vice President

+1 515 415 6120

[mike.macri@cbre.com](mailto:mike.macri@cbre.com)

Licensed in the State of Iowa

**South Waterloo Business Park**  
Hwy 20 & Ansborough Ave | Waterloo, Iowa

# Property Overview

---

## 135,000 SF Building

CBRE is pleased to exclusively offer for Lease the prospect building in Waterloo, Iowa.

### Available Building

- + 135,000 SF light industrial/  
warehouse/manufacturing space
- + Zoned M1
- + 32' Clear
- + Dock & Drive-in
- + Outside storage permitted

### Site Features

- + Excellent access and visibility to Hwy 20
- + Construction to begin in 2025



**South Waterloo Business Park**  
Hwy 20 & Ansborough Ave | Waterloo, Iowa

# Salient Information

SIZE	135,000 SF Building
ZONING	Zoned M1
FRAMING	Steel frame beam dimensions : 50' x 50'
BAY SIZE	60' Speed Bay
CEILING HEIGHT	Minimum 32' clear
WALLS	Concrete sidewalls
LIGHTING	LED lighting throughout
DRIVE-IN DOORS	Dock and Drive-in access available
STORAGE	Outdoor Storage Permitted
Building	Secured storage areas available
SPACE	Minimum demised space is 10,000 SF
UTILITIES	City water/sewer/roadways services
BUILD	Spaces/ buildings can be build- to-suit



# Site Plan

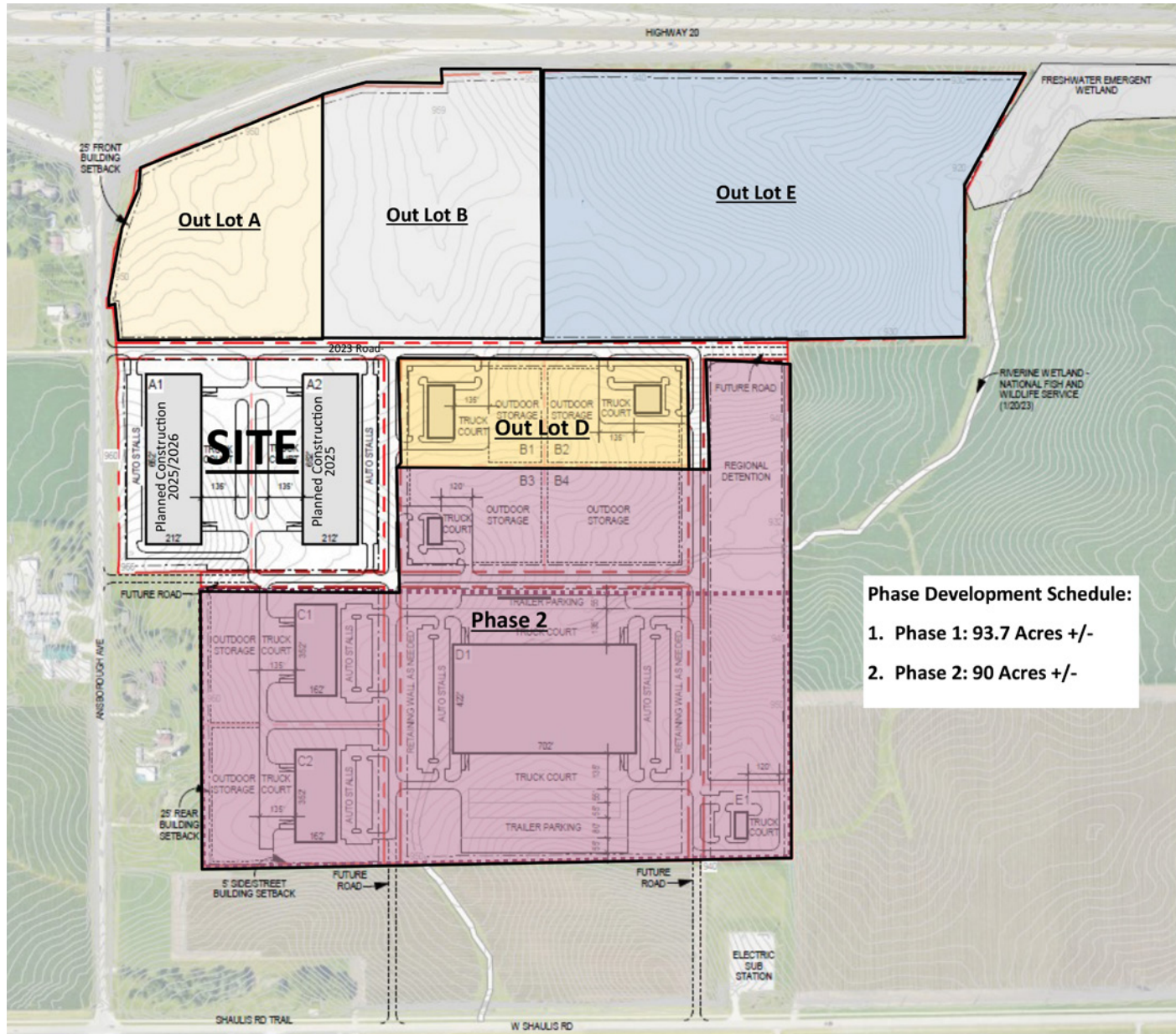

# Site Aerial



# Location



# Demographics



## Education

	3 Mile	5 Mile
2023 Population 25 and Over	24,069	53,575
HS and Associates Degrees	62.0%	64.5%
Bachelor's Degree or Higher	31.2%	28.0%

## Population

	3 Mile	5 Mile
2023 Population - Current Year Estimate	34,341	76,710
2028 Population - Five Year Projection	34,089	76,311
2020-2023 Annual Population Growth Rate	-0.18%	-0.18%

## Households

	3 Mile	5 Mile
2023 Households - Current Year Estimate	14,911	33,294
2028 Households - Five Year Projection	14,918	33,414
2023-2028 Annual Household Growth Rate	0.01%	0.07%
2023 Average Household Size	2.28	2.28

## Household Income

	3 Mile	5 Mile
2023 Average Household Income	\$81,939	\$76,392
2023 Median Household Income	\$58,237	\$55,621
2028 Average Household Income	\$92,291	\$85,759

## Housing Units

	3 Mile	5 Mile
2023 Housing Units	16,249	36,471

## Place of Work

	3 Mile	5 Mile
2023 Businesses	1,025	3,000
2023 Employees	19,342	52,483

© 2024 CBRE, Inc. All rights reserved. This information has been obtained from sources believed reliable, but has not been verified for accuracy or completeness. You should conduct a careful, independent investigation of the property and verify all information. Any reliance on this information is solely at your own risk. CBRE and the CBRE logo are service marks of CBRE, Inc. All other marks displayed on this document are the property of their respective owners, and the use of such logos does not imply any affiliation with or endorsement of CBRE. Photos herein are the property of their respective owners. Use of these images without the express written consent of the owner is prohibit.