

1910 Campostella Rd,
Suite 102
Chesapeake, VA 23324

FOR LEASE HIGH-BAY INDUSTRIAL PORT OF VIRGINIA



SUITE 102 - ± 90,475 SF AVAILABLE

SPECIFICATIONS

- ± 90,475 SF
- ± 1,634 sf of office
- ESFR Sprinkler System Potential (Currently Wet System with High Pile ELO Sprinkler Heads)
- Modified Cross-Dock
- Twenty-four (24) 10' x 10' Dock Level Loading Doors with Dock Seals and Canopies
 - 10 with in-ground pit levelers
 - 14 with edge-of-dock levelers
- One (1) - 12' x 14' Grade Level Loading Door
- Ceiling Height: ± 30'7"
- M-2 Zoning (Heavy Industrial)
- 3-Phase, 480 Volt, 800 Amps
- Column Spacing: Varies ± 47'W x ± 55'D
- Central Hampton Roads "Inside the Beltway" Location
- Amongst the lowest drayage rates in the region
- Immediate access to I-64, I-264, I-464, I-664, US-13, US-58, US-460
- Large shared paved trailer storage yard available
- Rail Potential via private Norfolk Southern Spur
- Foreign Trade Zone and ICE Coffee Future eligibility
- Institutionally owned by Lovett Industrial



For more information:

CHARLES L. DICKINSON, SIOR
757.640.9468

CharlesDickinson@HarveyLindsay.com

999 Waterside Drive • Suite 1400
Norfolk, Virginia 23510
757-640-8700
www.HarveyLindsay.com

HARVEY LINDSAY
COMMERCIAL REAL ESTATE

± 1,634 SF OFFICE

**TOTAL SQUARE FOOTAGE: ± 90,475 SF
OFFICE SQUARE FOOTAGE: ± 1,634 SF
WAREHOUSE SQUARE FOOTAGE: ± 88,841 SF**

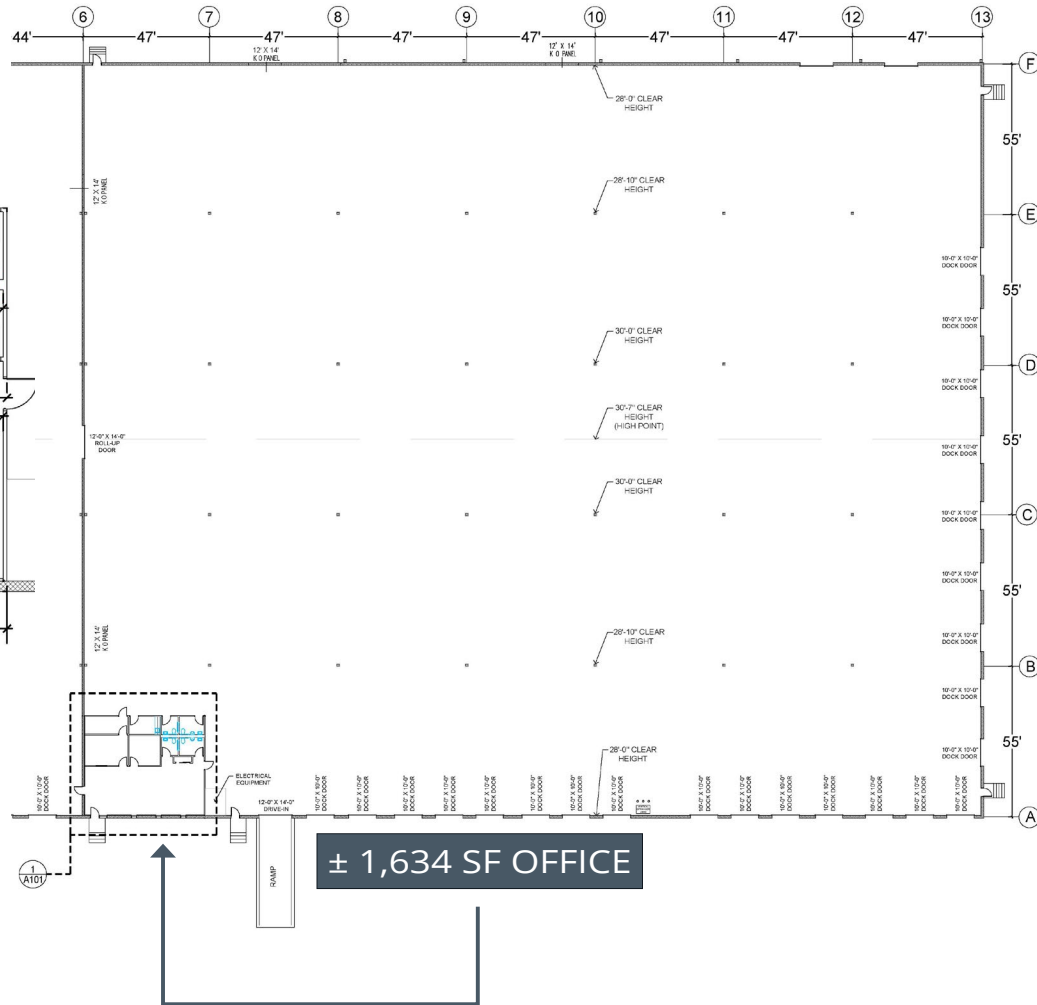
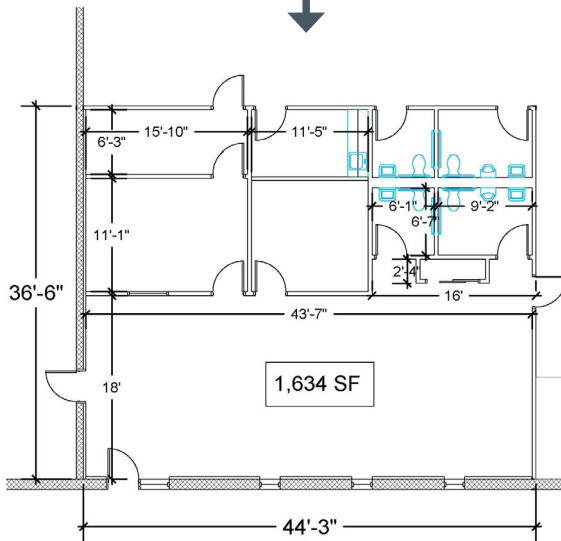

SPECIFICATIONS - SUITE 102

- ± 90,475 SF total
- ± 1,634 SF of office
- ESFR Sprinkler System Potential (Currently Wet System with High Pile ELO Sprinkler Heads)
- Modified Cross-Dock
- Twenty-four (24) 10' x 10' Dock Level Loading Doors with Dock Seals and Canopies
 - o 10 with in-ground pit levelers
 - o 14 with edge-of-dock levelers

- One (1) – 12' x 14' Grade Level Loading Doors
- Ceiling Height: ± 30'7"
- M-2 Zoning (Heavy Industrial)
- 3-Phase, 480 Volt, 800 Amps
- Column Spacing: Varies ± 47'W x ± 55'D

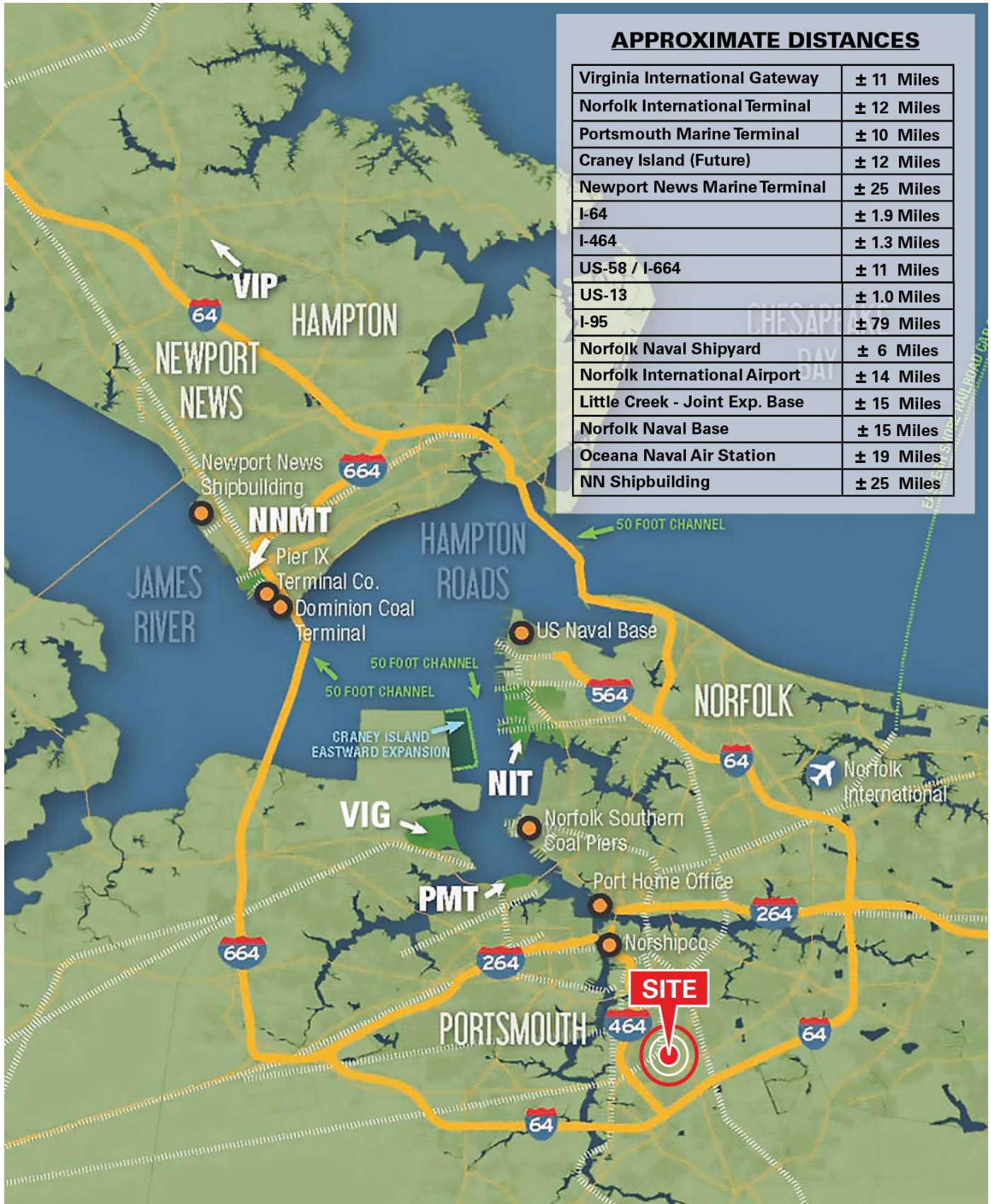

For more information:
CHARLES L. DICKINSON, SIOR
 757.640.9468
CharlesDickinson@HarveyLindsay.com

999 Waterside Drive • Suite 1400
 Norfolk, Virginia 23510
 757-640-8700
www.HarveyLindsay.com

HARVEY LINDSAY
 COMMERCIAL REAL ESTATE