

4017

TRAIL CREEK ROAD
RIVERSIDE | CALIFORNIA

4017

FOR LEASE | 6,300 SF

Voit
REAL ESTATE SERVICES

PROPERTY DETAILS & SITE PLAN

- Freestanding Industrial Building
- ± 1,020 SF of Office Space
- 1 Grade Level Loading Door
- 16' Minimum Warehouse Clearance
- 400 Amps of Power
- Secured Fenced Yard
- 2.5:1 Parking Ratio
- Located within Turner Riverwalk
- Excellent Proximity to Ontario 15 and Riverside 91 Freeways

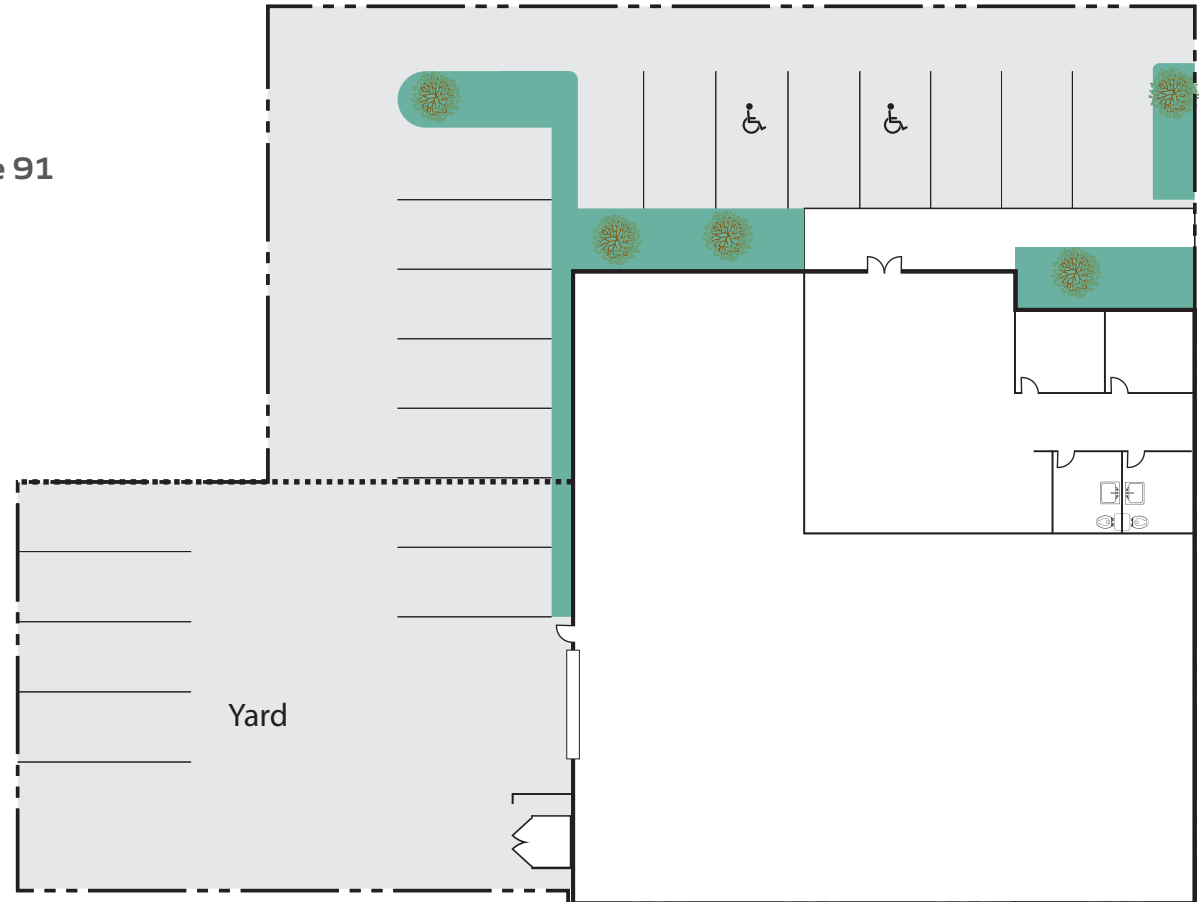

MICHAEL ZEHNER
SENIOR VICE PRESIDENT
714.935.2328
McZehner@voitco.com
Lic. #01917963

RYAN MOORE
SENIOR VICE PRESIDENT
909.545.8011
RMoore@voitco.com
Lic. #01821438

Voit
REAL ESTATE SERVICES

2020 Main Street | Suite 100
Irvine, California 92614
949.851.5100 | www.VoitCo.com

The information contained herein has been obtained from sources we deem reliable. While we have no reason to doubt its accuracy, we do not guarantee it. Licensed as Real Estate Salespersons by the DRE. ©2024 Voit Real Estate Services, Inc. All Rights Reserved. License #01991785.