

# 1,412 ± SF OFFICE SPACE FOR SALE



## 14333 LAUREL BOWIE RD UNIT 108 Laurel, MD 20708

### PROPERTY HIGHLIGHTS

- Approximately 1,412 ± SF Office
- Ground floor end unit
- Ample parking
- Zoned CGO (Commercial General Office)
- High Traffic Counts - 33,542 vpd on Laurel Bowie Road
- **SALE PRICE: \$300,000.00**

### LOCATION DESCRIPTION

Property is situated in South Laurel in Prince George's County, MD, a growth oriented corridor between the Washington, DC metro market. It links directly via feeder road to I-95, US Route 1, and Route 197.

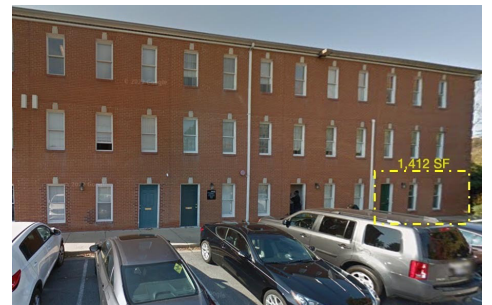

### TERRY ROGERS

O: 301.526.2584  
trogers@naimichael.com

### EDWARD LUCKETT

O: 301.318.3100  
eluckett@naimichael.com



10100 Business Pkwy | Lanham, MD 20706 | +1 301.459.4400 | [naimichael.com](http://naimichael.com)

The information contained herein has been given to us by the owner of the property or other sources we deem reliable. We have no reason to doubt its accuracy, but we do not guarantee it. Floor plans, site plans and other graphic representations of this property have been reduced and reproduced, and are not necessarily to scale. All information should be verified prior to purchase or lease.



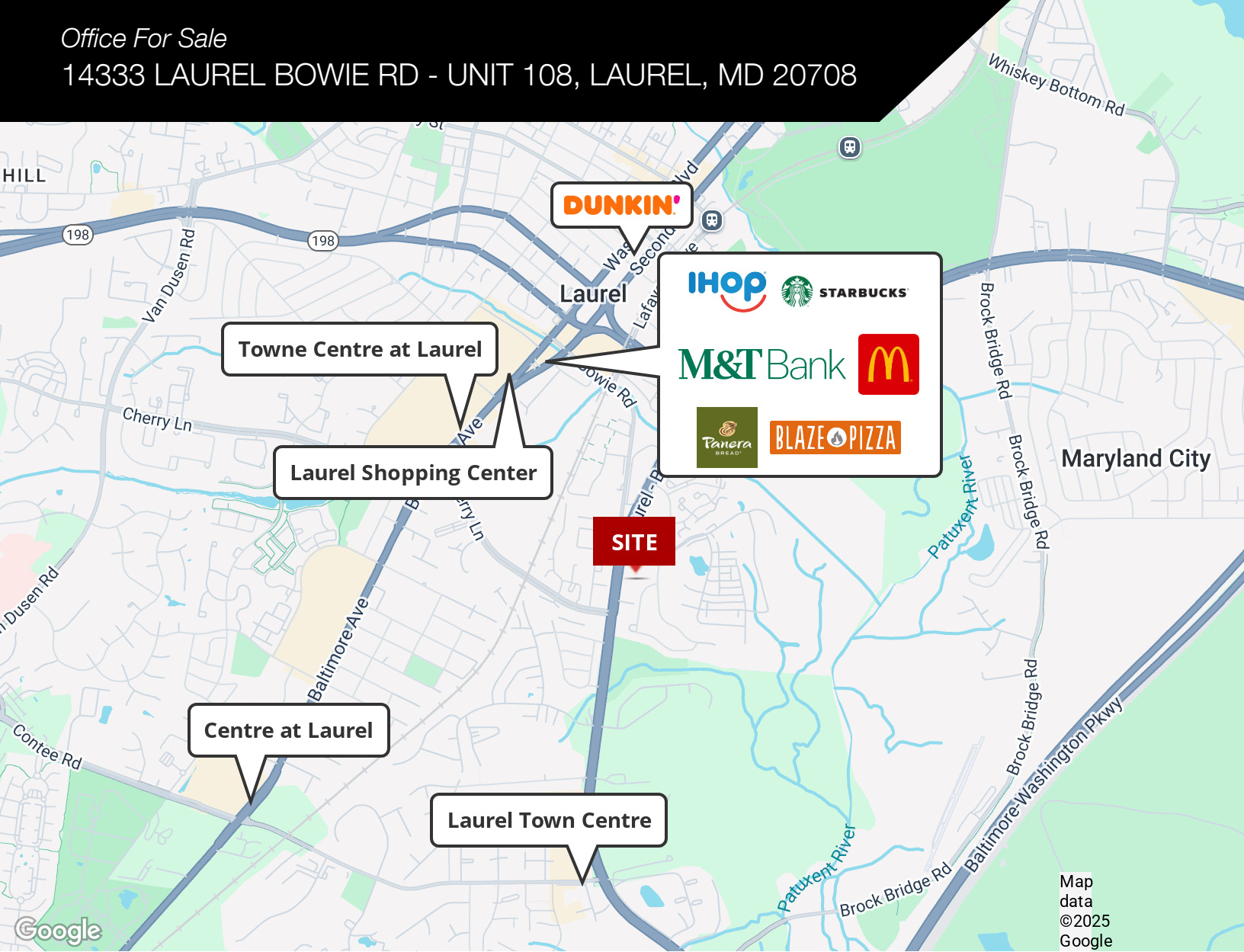

DEMOGRAPHICS



POPULATION



HOUSEHOLDS



AVG. HOUSEHOLD INCOME

1 Mile	16,000	6,256	\$88,924
3 Miles	99,000	37,174	\$122,481
5 Miles	160,219	58,258	\$137,208

Demographics data derived from AlphaMap

