

FOR LEASE

3218 North Street - Nacogdoches, TX



**SPACE FEATURES:**

- Commercial Retail Fronting North St
- Mixed Use Property with 92-unit Renovated Apartment Complex Behind
- 1.1 Miles North of SFA Campus
- In Growth Quadrant of Nacogdoches

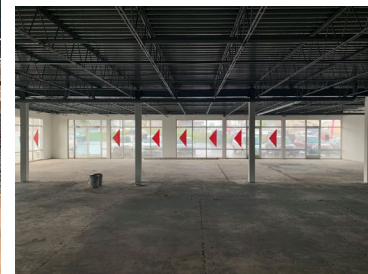

**FOR MORE INFORMATION PLEASE CONTACT:**

Jonathan Dunn  
713-319-4467  
[jdunn@cpre.com](mailto:jdunn@cpre.com)

**CPRE Commercial**  
3505 North Street  
Nacogdoches, TX 75965  
(936)564-2622

[www.commercial.cpre.com/properties-lease.php](http://www.commercial.cpre.com/properties-lease.php)

**RENTABLE BUILDING AREA:**  
8,400 SF

- VACANCY: (4,225 SF Contig in Suites 102/3)**
- Suite 5 – 1,692 SF 2nd Gen T-Mobile Store
  - Suite 3 – 1,245 SF 1<sup>st</sup> Gen
  - Suite 2 – 3,025 SF 1<sup>st</sup> Gen
  - Suite 1 – 785 SF 1<sup>st</sup> Gen

**NET RENTAL RATE:**  
\$15.00/SF/YR

**2025 Estimated OPEX:**  
\$4.61/SF/YR

**ALLOWANCE:**  
\$15.00/SF

**TERM:**  
5 Years Minimum

**PARKING:**  
5.6/1,000 SF

**TENANTS IN COMPLEX:**  
VIP Nail & Spa

2025 CPRE Commercial This information has been obtained from sources deemed to be reliable. We have not verified it and make no guarantee, warranty or representation about it. Any projections, assumptions or estimates used are for example only and do not represent the current or future performance of the property. You and your advisors should conduct a careful, independent investigation of the property to determine to your satisfaction the suitability of the property for your needs. Photos herein are the property of their respective owners and use of these images without the express written consent of the owner is prohibited.

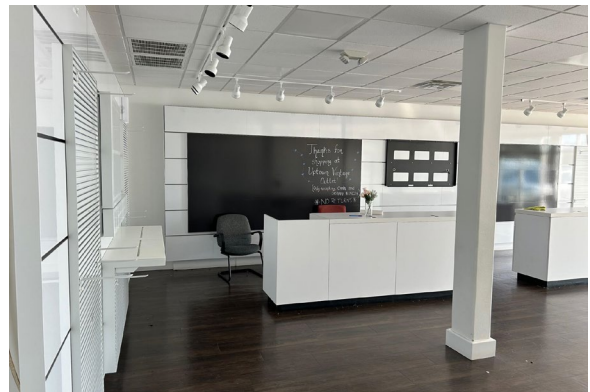

2025 CPRE Commercial This information has been obtained from sources deemed to be reliable. We have not verified it and make no guarantee, warranty or representation about it. Any projections, assumptions or estimates used are for example only and do not represent the current or future performance of the property. You and your advisors should conduct a careful, independent investigation of the property to determine to your satisfaction the suitability of the property for your needs. Photos herein are the property of their respective owners and use of these images without the express written consent of the owner is prohibited.

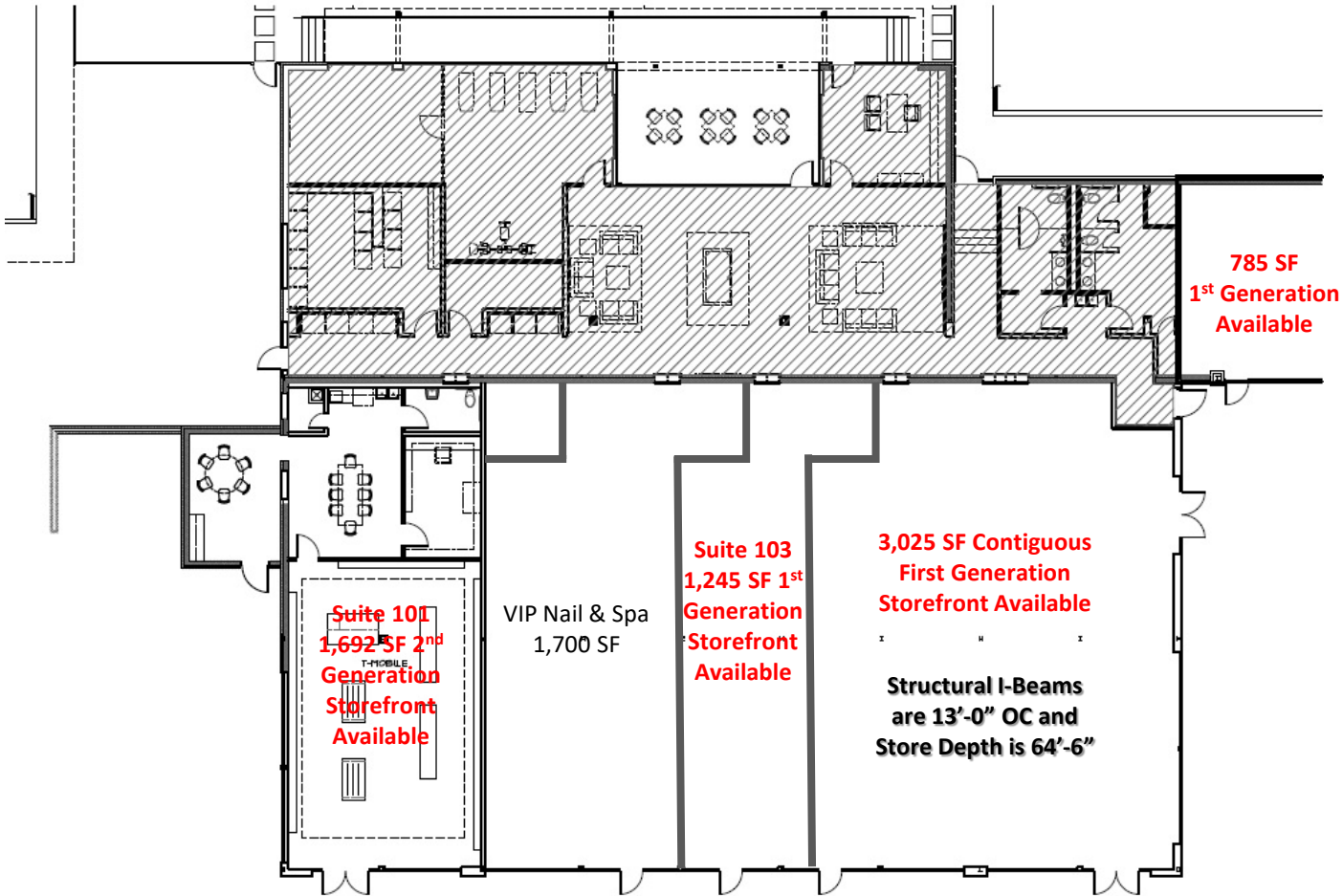

3220 North - FLOOR PLAN  
SCALE: 1/8" = 1'-0"