



SPORTS PARK PLAZA

5353 South 960 East, Murray, UT 84117

PROPERTY DESCRIPTION:

- Beautiful Atrium Lobby
- Panoramic Elevated East-Side Views
- Within Minutes from I-15 & I-215 Freeways
- Ample Parking
- Surrounded by Numerous Restaurants and Amenities
- Located Next to Sports Mall Tennis Club and Athletic Center
- Close Proximity Several Golf Courses

LEASE RATE:

\$19.75 SF/YR
(FULL SERVICE)

PROPERTY DETAILS:

SUITE 210: 2,703 SF
SUITE 200: 2,736 SF

ANDY RENFRO
801.706.7845
andy@iproperties.com

51 East 400 South Suite 210
Salt Lake City, UT 84111
801.355.0600 | iproperties.com



OFFERING SUMMARY

Lease Rate:	\$19.75 SF/yr (Full Service)
Available SF:	Suite 210: 2,703
	Suite 200: 2,736 SF (Avail 7/1/25)
Building Size:	37,926 SF

SPACES	LEASE RATE	SPACE SIZE
Suite 200	\$19.75 SF/yr	2,736 SF
Suite 210	\$19.75 SF/yr	2,703 SF

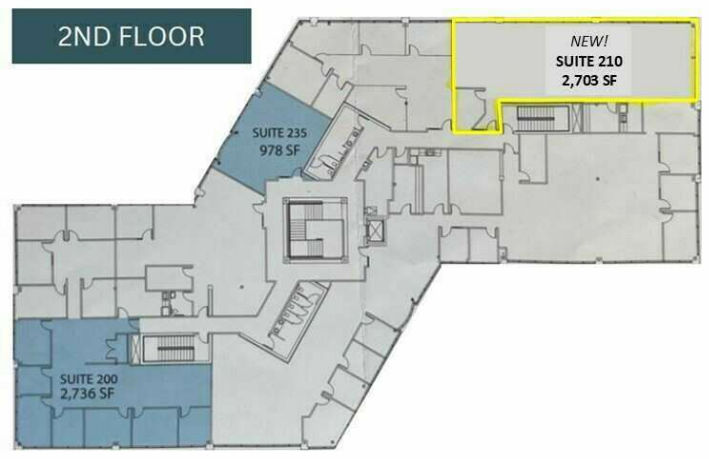

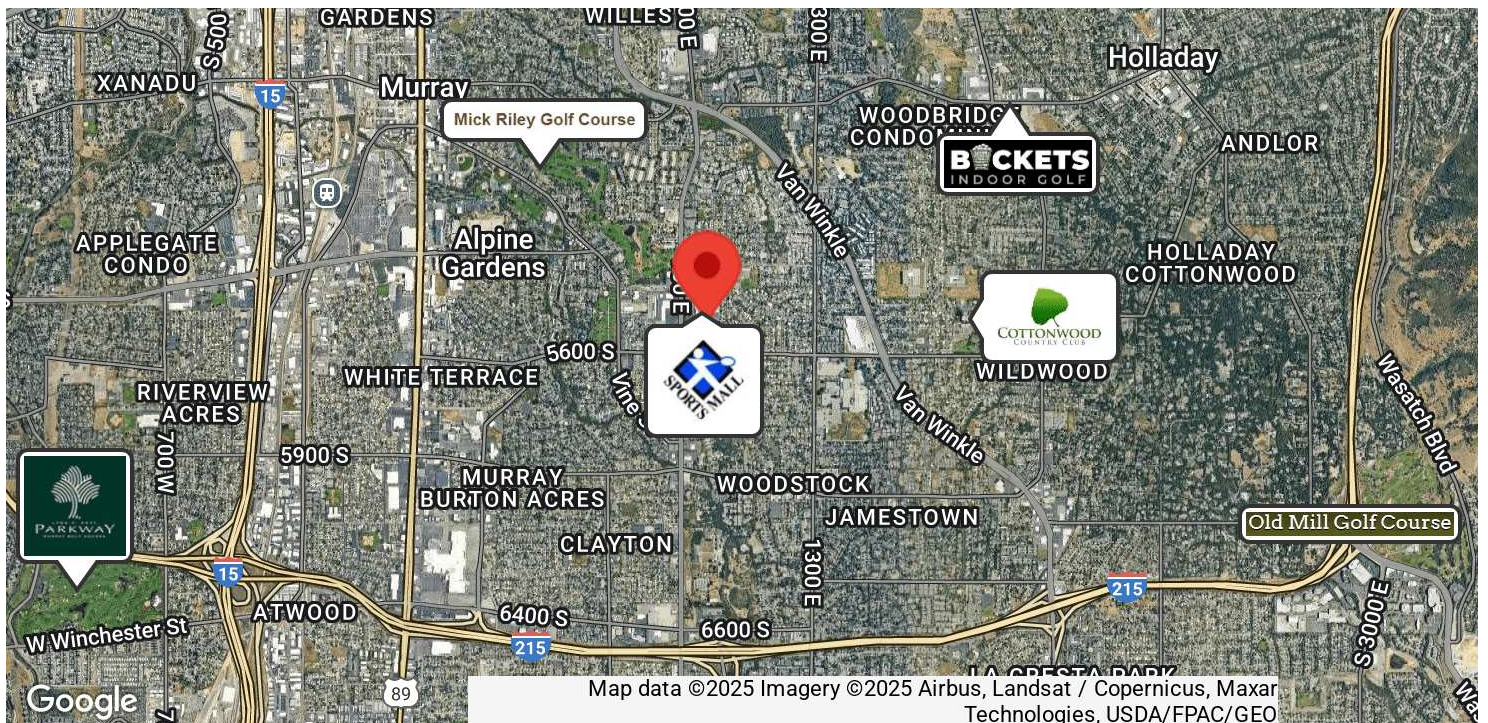

ANDY RENFRO
801.706.7845
andy@iproperties.com

51 East 400 South Suite 210
Salt Lake City, UT 84111
801.355.0600 | iproperties.com