

Retail Spaces For Lease in the Shrub Oak Shopping Center

**1335 EAST MAIN STREET
SHRUB OAK, NY 10588**

ASKING: \$25 PSF MODIFIED GROSS



Retail Spaces For Lease in the Shrub Oak Shopping Center located at 1335 East Main Street in Shrub Oak a Hamlet in the Town of Yorktown, NY.

Former Chase Bank - End Cap

- 3,600 SF
- Well suited for banks, financial services, attorneys, professional services and the like.

Former Tire & Auto Shop - Freestanding Building

- 6,300 SF
- Well suited for a day care facility, tutoring center, etc (non-automotive uses only)

Landlord will build to suit for well qualified tenants.

Town of Yorktown By the Numbers

Town Stats

Population: 36,618

37 Square Miles

Median Resident Age 45

Educated Workforce

Homeownerships 83%

Avg. HH Income \$142,152

60 miles of Hiking Trails

Home to Major Business: IBM,
Nestlé Water, UPS and Caremount,
among others

Close To

5 Majors Airports

2 Metro-North Train Lines

And

Bee-Line Bus Service

Only Northern Westchester
Municipality with East-West and
North-South Major Highway

Town of Yorktown Demographics

**1335 EAST MAIN STREET
SHRUB OAK, NY 10588**

ASKING: \$25 PSF MODIFIED GROSS

KEY FACTS

35,687

Population



Average
Household Size

46.0

Median Age

\$118,475

Median Household
Income

EDUCATION

5%

No High School
Diploma



20%

High School
Graduate



21%

Some College



54%

Bachelor's/Grad/Pr
of Degree

BUSINESS



1,328

Total Businesses



12,804

Total Employees

EMPLOYMENT



White Collar

73%



Blue Collar

12%



Services

15%



Unemployment
Rate

INCOME



\$118,475

Median Household
Income



\$55,593

Per Capita Income



\$587,416

Median Net Worth

Households By Income

The largest group: \$200,000+ (22.9%)

The smallest group: <\$15,000 (3.9%)

Indicator	Value	Difference	
<\$15,000	3.9%	-3.9%	
\$15,000 - \$24,999	4.5%	-1.8%	
\$25,000 - \$34,999	5.3%	-0.6%	
\$35,000 - \$49,999	6.7%	-1.0%	
\$50,000 - \$74,999	9.2%	-3.2%	
\$75,000 - \$99,999	10.1%	-0.4%	
\$100,000 - \$149,999	21.7%	+4.5%	
\$150,000 - \$199,999	15.6%	+5.9%	
\$200,000+	22.9%	+0.4%	

Bars show deviation from
Westchester County

Property Photos

**1335 EAST MAIN STREET
SHRUB OAK, NY 10588**

ASKING: \$25 PSF MODIFIED GROSS



Property Photos

**1335 EAST MAIN STREET
SHRUB OAK, NY 10588**

ASKING: \$25 PSF MODIFIED GROSS



Site Plan

**1335 EAST MAIN STREET
SHRUB OAK, NY 10588**

ASKING: \$25 PSF MODIFIED GROSS

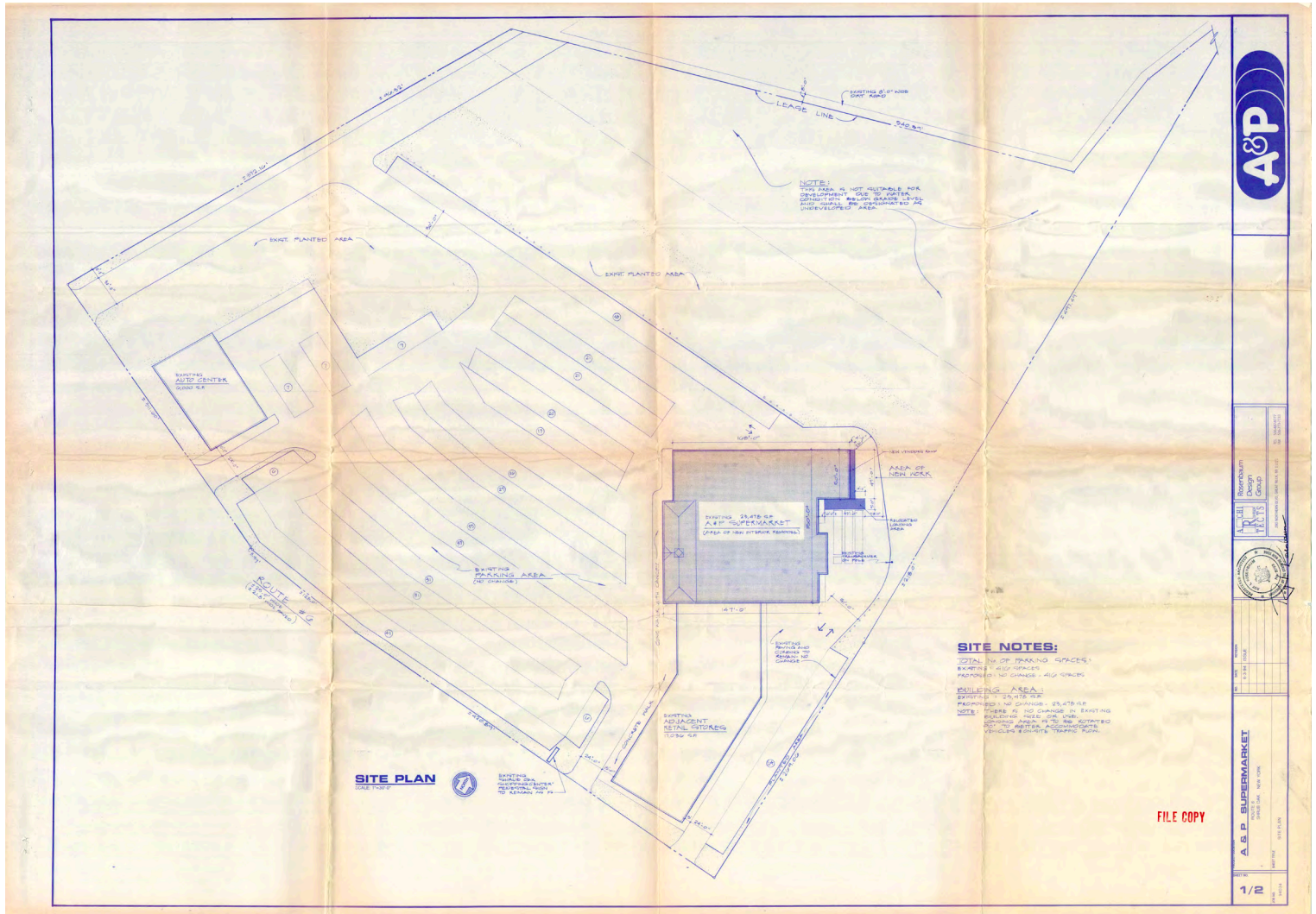

Aerial View and Regional Map

**1335 EAST MAIN STREET
SHRUB OAK, NY 10588**

ASKING: \$25 PSF MODIFIED GROSS

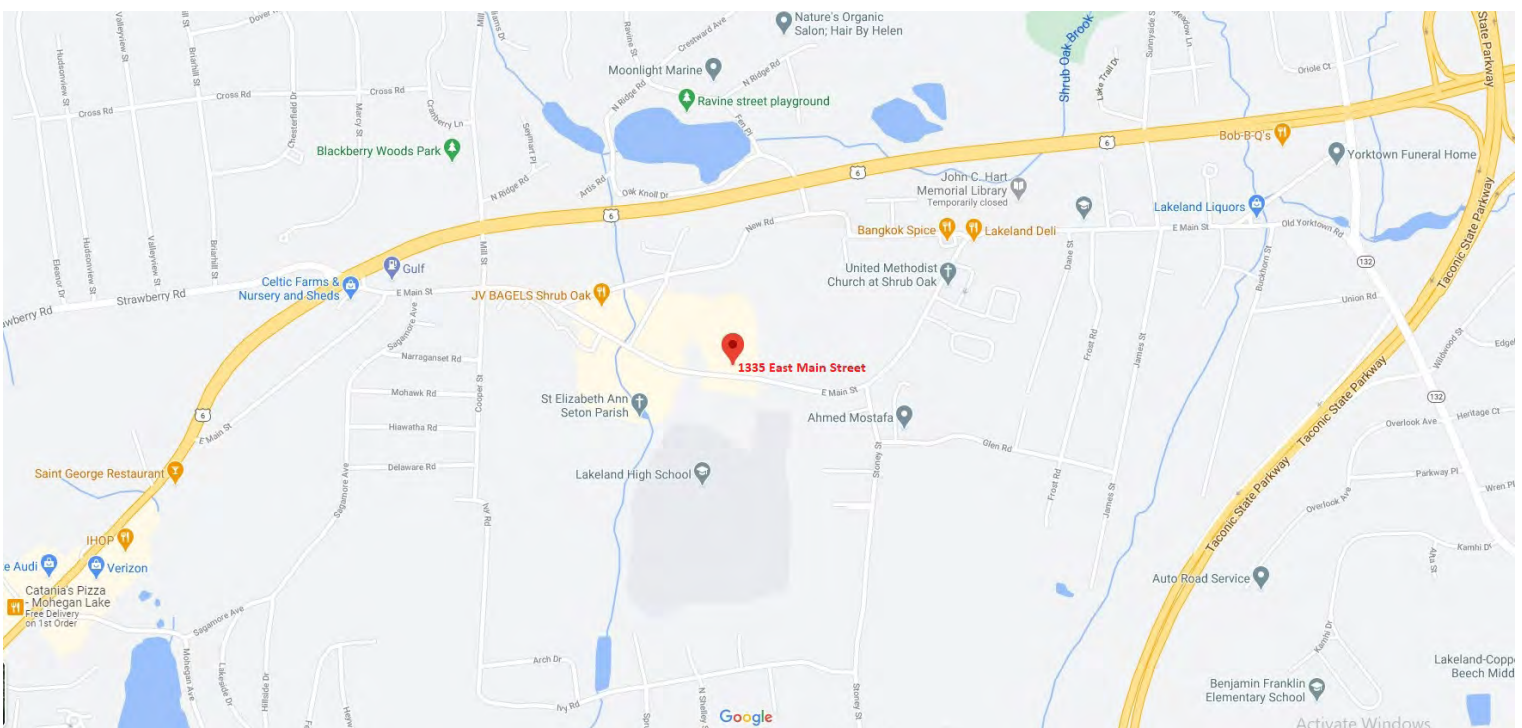

The information contained in this Offering Memorandum is confidential, furnished solely for the purpose of review by a prospective purchaser of certain information relating to the property mentioned herein (the "Property"), and is not to be used for any other purpose or made available to any other person without the prior written consent of HLC. The material is subject to errors and omissions and based on part upon information supplied by sources deemed reliable.