

840

GREAT SOUTHWEST PARKWAY

Arlington, Texas 76011

88,821 SF | 4.00 AC

For Lease or Sale

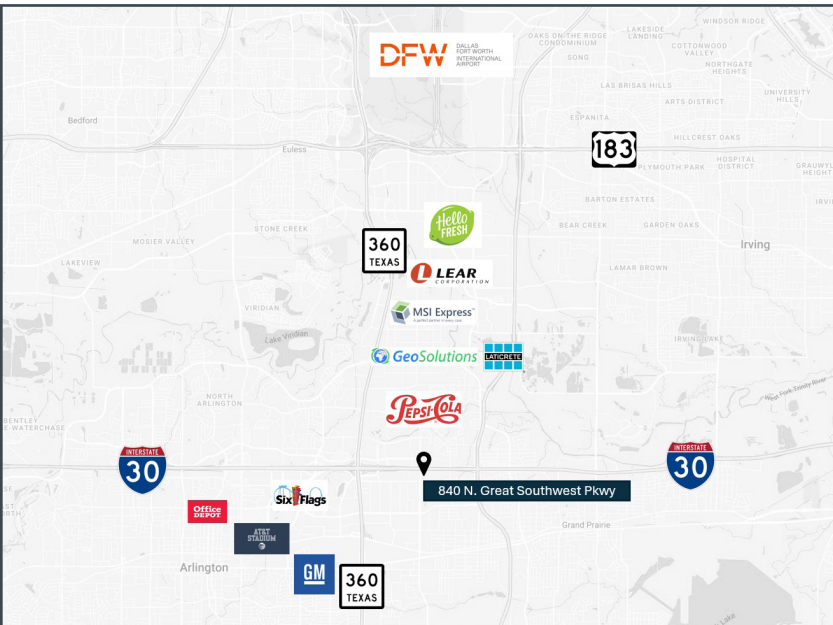

PROPERTY FEATURES

- Office SF: 5,292
- Parking: 38 Spaces
- Clear Height: 20'-21.5'
- Dock Doors: 8
- Column Spacing: 40'x25'
- Ramps: 2 (One 24'x14' Oversized Door)
- Fire Protection: Wet
- Fenced Yard for Secured Storage
- Power: 800 Amp 277/480v 3 Phase 4 Wire



HARRISON PUTT
214-945-7306
hputt@mercercapital.com

CORB Y HODGKISS
469-360-3918
chodgkiss@mercercapital.com



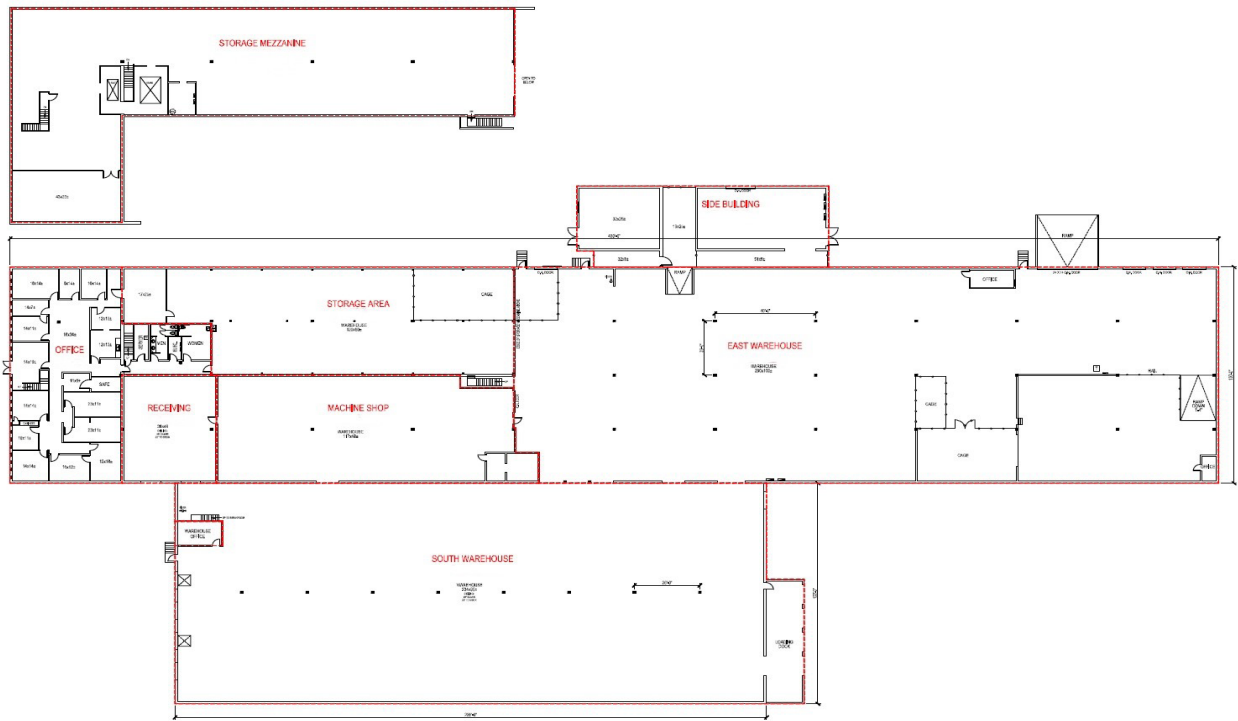

MARKET HIGHLIGHTS

12 Minutes
DFW AIRPORT

Located Off I-30
BETWEEN SH 360 & SH 161/PGBT

Great Southwest Industrial Park
ONE OF THE LARGEST INDUSTRIAL PARKS IN NORTH
AMERICA AT 102,500,000 SF

HARRISON PUTT
214-945-7306
hputt@mercero-company.com

CORBY HODGKISS
469-360-3918
chodgkiss@mercero-company.com

