

# 2160 Lundy Ave

SAN JOSE, CA 95131



## Location Description

2160 Lundy Ave is centrally located with easy access to I-880, I-680, Montague Expressway, HWY-87, and HWY-101, as well as a host of amenities, including Costco, Home Depot, Sprouts and the Great Mall. Additionally, it is only a short drive away from San Jose International Airport, downtown San Jose, and San Jose State University.

## Property Highlights

- Professionally managed office
- 4:1000 parking
- Call to tour

## Offering Summary

<b>Lease Rate:</b>	\$2.65/SF/mo
<b>Available SF:</b>	1,941 - 2,451 SF
<b>Lot Size:</b>	2.88 Acres
<b>Building Size:</b>	±50,000 SF

<b>Demographics</b>	<b>1 Mile</b>	<b>3 Miles</b>	<b>5 Miles</b>
<b>Total Households</b>	6,214	48,570	127,297
<b>Total Population</b>	19,800	163,826	403,756
<b>Average HH Income</b>	\$106,324	\$102,717	\$91,276



**NAI Northern California**  
NAINORCAL.COM

**Douglas Sharpe**  
Executive Vice President  
dsharpe@nainorcal.com  
408.740.7224  
CalDRE #00693583

**Lidia Buckovic**  
Associate Director  
lbuckovic@nainorcal.com  
408.740.7225  
CalDRE #02064692

## Additional Photos

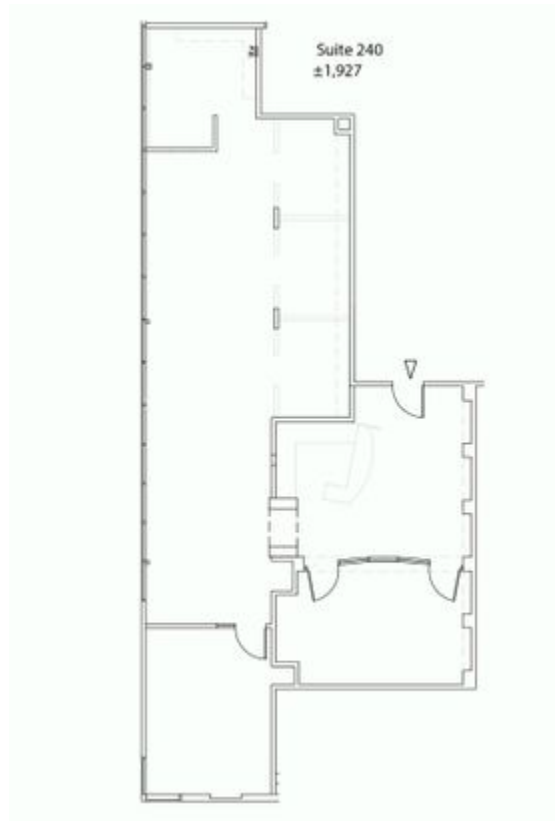

## Location Information



## For More Information

**Douglas Sharpe**  
Executive Vice President  
dsharpe@nainorcal.com  
408.740.7224  
CalDRE #00693583

**Lidia Buckovic**  
Associate Director  
lbuckovic@nainorcal.com  
408.740.7225  
CalDRE #02064692