



**Kalmon Dolgin**  
AFFILIATES INC.

**1827 Pacific St.**  
**Crown Heights**  
**Brooklyn, NY 11233**

**12,000 SF**  
**-FOR LEASE-**



Kalmon Dolgin Affiliates presents for lease 12,000 SF one story building in Crown Heights, Brooklyn. This warehouse is centrally located along a busy trucking route, moments to the Barclay's Center, Downtown Brooklyn & Manhattan. A/C Subway Lines are moments away.

## **PROPERTY FEATURES:**

**12,000 SQUARE FOOT**  
**ONE STORY BUILDING**  
**14' - 17' CEILING HEIGHT**  
**LARGE INTERIOR LOADING DOCK**  
**LARGE DRIVE IN DOOR**  
**FULLY SPRINKLERED**  
**HEAVY POWER**  
**OFFICE**

---

**FOR MORE INFORMATION**  
**CONTACT EXCLUSIVE**  
**BROKER**  
**JEFF UNGER**  
**347-390-1140 (office)**  
**917-971-0995 (mobile)**  
**JUNGER@KALMONDOLGIN.COM**

---



101 RICHARDSON ST. | BROOKLYN, NY 11211

718.388.7700

WWW.KALMONDOLGIN.COM

All information furnished regarding property for sale or rental is from sources deemed reliable but no warranty or representation is made as to accuracy thereof and same is submitted subject to error omissions, change of price rental or other conditions, prior sales, lease or withdraw without notice.



**Kalmon Dolgin**  
AFFILIATES INC.

**1827 Pacific St.**  
**Crown Heights**  
**Brooklyn, NY 11233**

**12,000 SF**  
**-FOR LEASE-**

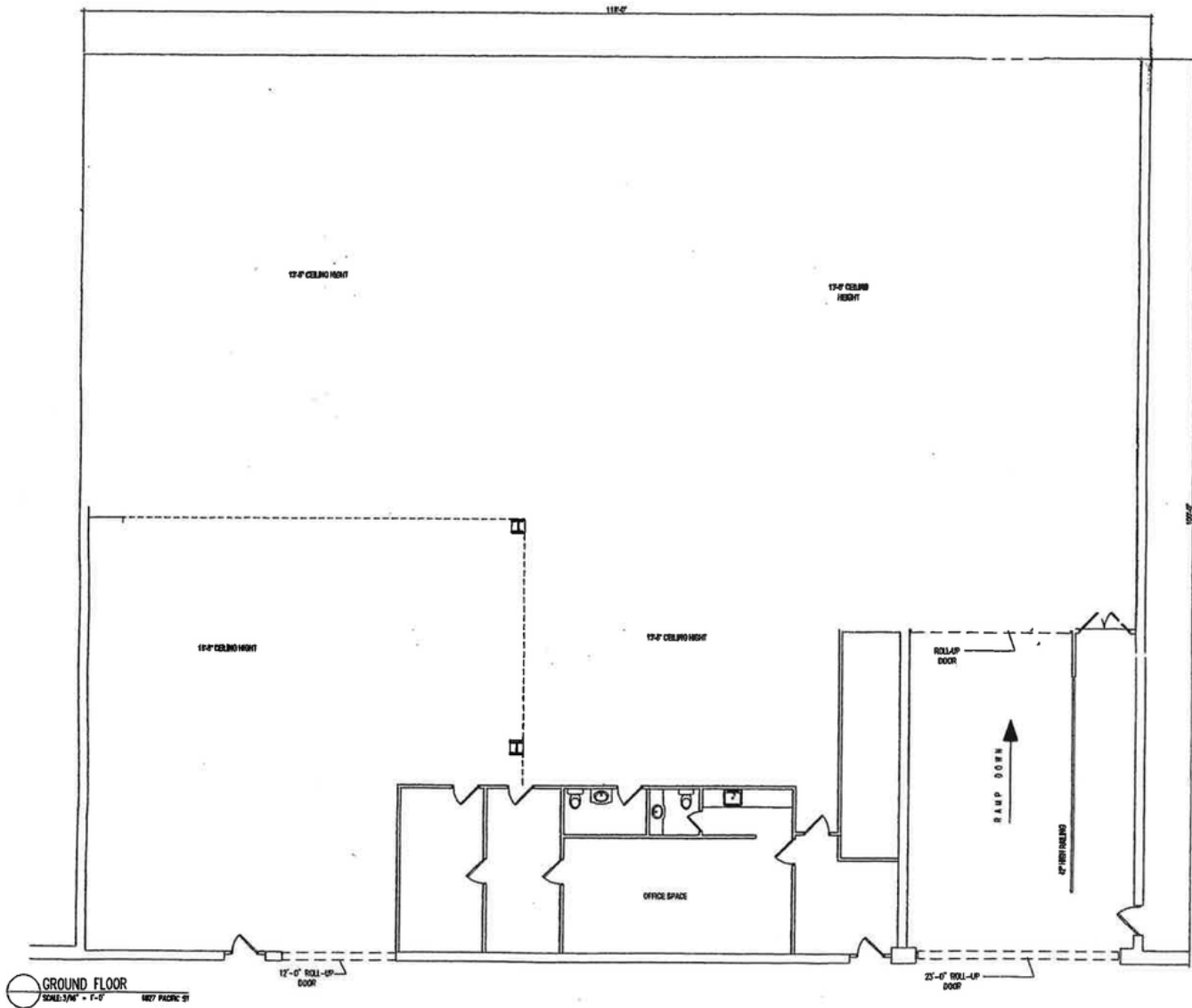

**1827 PACIFIC STREET**

**BROOKLYN, NY**

**12,000 SQ. FT.**



101 RICHARDSON ST. | BROOKLYN, NY 11211

718.388.7700

[WWW.KALMONDOLGIN.COM](http://WWW.KALMONDOLGIN.COM)

All information furnished regarding property for sale or rental is from sources deemed reliable but no warranty or representation is made as to accuracy thereof and same is submitted subject to error omissions, change of price rental or other conditions, prior sales, lease or withdraw without notice.