

**Private Offices & Open
Work Spaces Available**



1722 Keller Parkway Keller, TX 76248



PROPERTY HIGHLIGHTS

- Flexible terms & space options
- Located on the High Traffic Keller Parkway
- Single Executive Office or Multiple Office Suites
- Easily accessible to major restaurants, shopping centers and hotels





PROPERTY HIGHLIGHTS	
Address	1722 KELLER PARKWAY KELLER, TX 76248
Spaces For Lease	Single Executive Office & Multiple Office Suites
Year Built	2022
Zoning	Commercial Office Zoning
Building Size	8,526 SF
Great Location	Frontage on Keller Parkway (1709) Keller Parkway Traffic Count 41,000 VPD
Rent Rate	Varies by Office
Site Highlights	<ul style="list-style-type: none">• Move in Ready! Available Now• Our beautifully-designed office spaces suit any size of team• Centrally Located Office Building in Heart of Keller• Easy Ingress/Egress to Major Roads
Excellent Demographics	Primed to serve Keller's affluent, rapidly growing community with households boasting an average income of \$160,224/year
Parking	Plenty Surface Parking Spaces



LOCATION OVERVIEW

FLOOR
PLANS



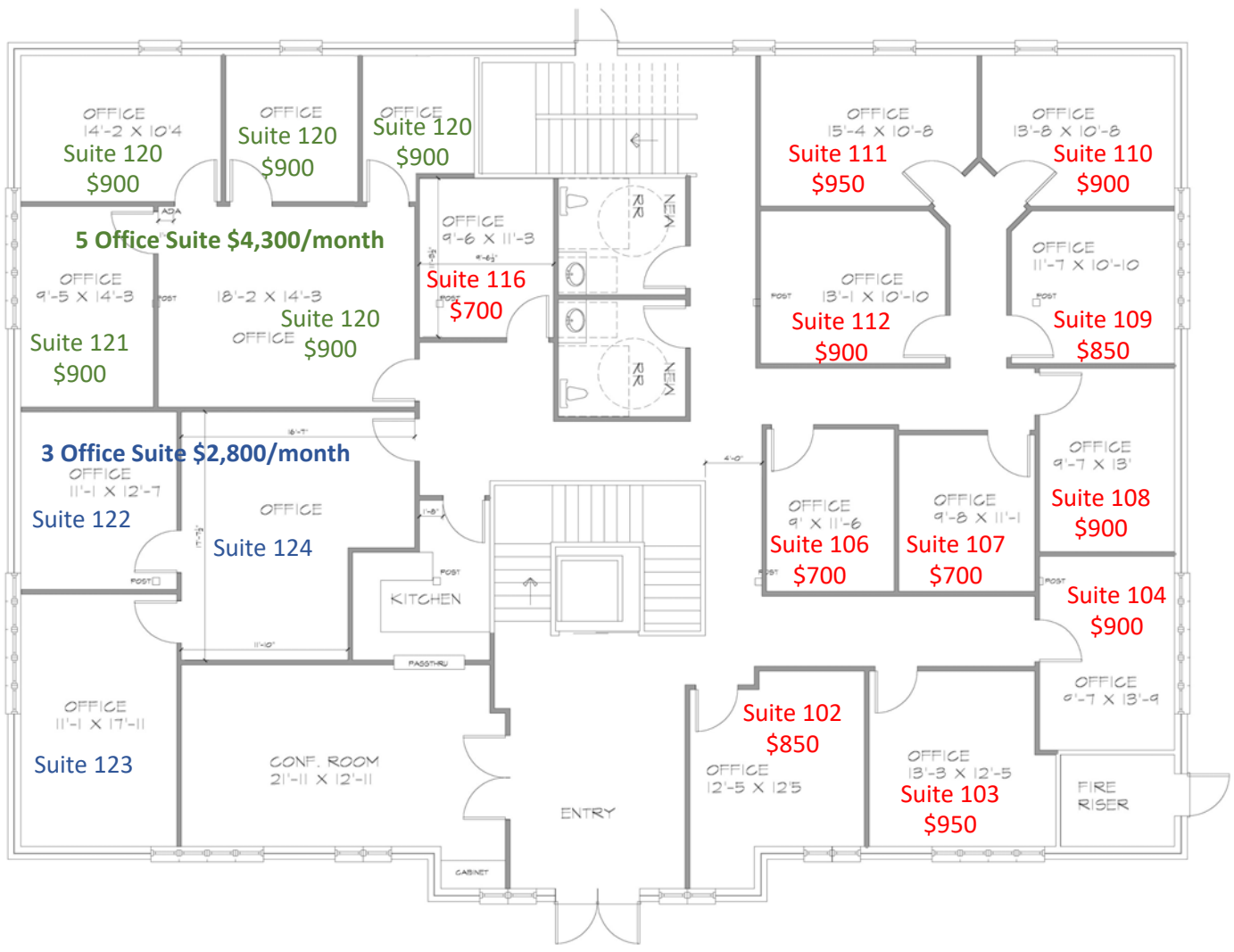

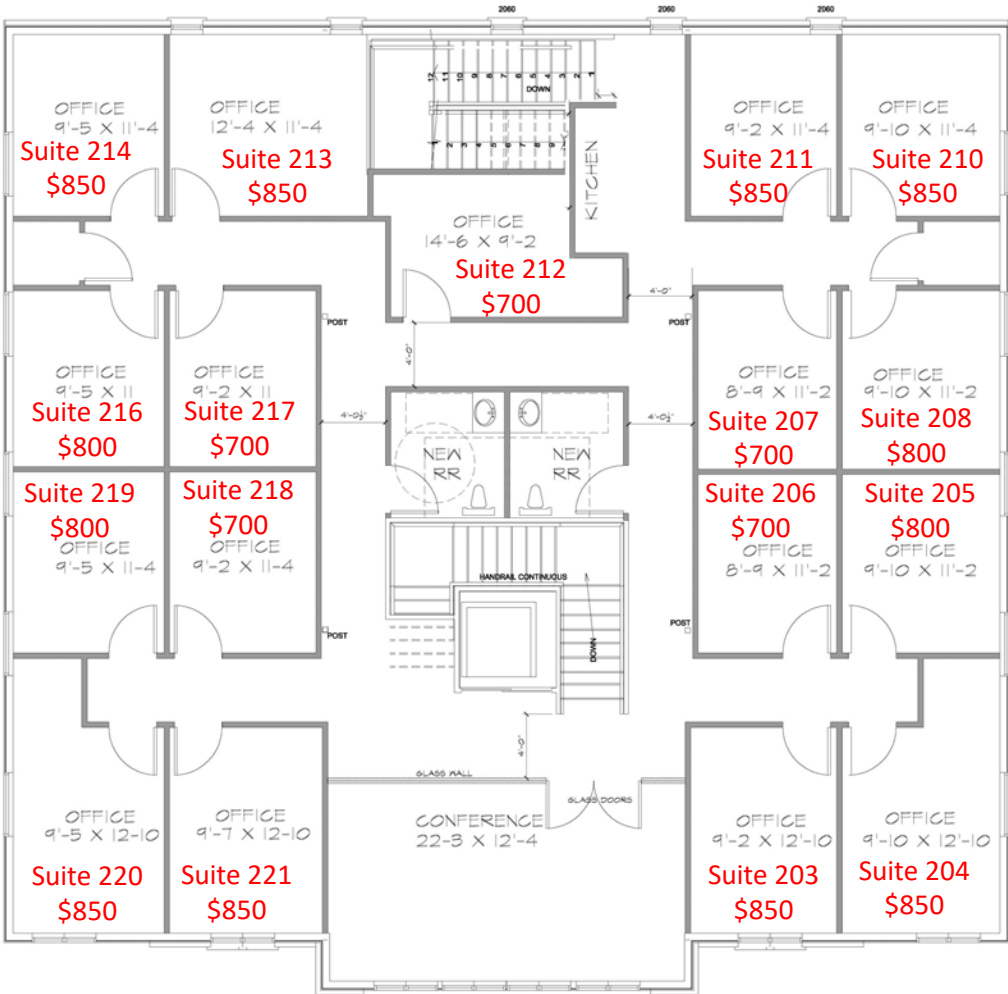

CONTACT INFORMATION



PAUL BLIGHT

Partner

C: 214.682.7192

O: 214.637.4300

pblight@glaciercommercial.com



STACEY YEARIAN

Vice President

C: 618.530.3550

O: 214.637.4300

yearian@glaciercommercial.com

1722 Keller Parkway Keller, TX 76248 | Keller Parkway Office Park



glaciercommercial.com

©2023 Glacier Commercial Realty L.P.

All rights reserved. The information contained herein was obtained from sources believed to be reliable. It is subject to verification. The presentation of this property is submitted subject to errors, omissions, change of price or conditions, prior to sale or lease, or withdrawal without notice