



FOR LEASE - OFFICE AND INDUSTRIAL SPACE

One Monitor Drive offers a unique leasing opportunity in Concord, NH. This well-maintained property totals approximately 73,830 square feet and consists of two buildings that combine professional office space with high-quality industrial and warehouse areas. The property has an emergency generator and is serviced by municipal water/sewer, natural gas heat. The site also features 187 parking spaces.



The office building is fully air-conditioned with elevator access. The available space ranging from 1,289± RSF to 13,540± RSF. Each floor features a combination of open area and offices, as well as a kitchenette and multiple restrooms.







The industrial building has space ranging from 654± RSF to 22,359± RSF. Clear height ranges from 12' to 28' with column spacing of 22'x40' in the warehouse and 22'x24 in the production area. There is 2500 amps, 480/277 v of power and three loading docks (2 w/levelers).

Property Specifications





BUILDING SIZE	73,830± SF
AVAILABLE SPACE	Office: 1,289± RSF to 13,540± RSF (1st & 2nd floors) Industrial: 654± RSF to 22,359± RSF
FLOORS	Three-stories (office)
LAND AREA	8.21± acres
ZONING	Industrial Office MDL-96
PARKING	187 spaces
HVAC	Natural gas, central A/C (office only)
POWER	2500 amp, 480/277 volts
LOADING	(3) loading docks (2 w/levelers)
UTILITIES	Municipal water, sewer, and natural gas, Electric: Unitil
TELECOMMUNICATIONS PROVIDERS	Comcast, Consolidated Communications
OTHER	<ul style="list-style-type: none">• Emergency generator• Elevator access (office)• Potential for building signage
AREA AMENITIES	<ul style="list-style-type: none">• Quick access to the area's major highways including I-93, I-293• A wide variety of restaurants, cafes, retail and entertainment options
LEASE RATE	\$8.00-\$12.00/SF NNN

Floor Plan

INDUSTRIAL TENANT SIZES

	11,069± RSF
	5,456± RSF
	5,180± RSF
	654± RSF
	COMMON AREA

OFFICE TENANT SIZES

	9,648± RSF
	2,603± RSF
	1,289± RSF
	COMMON AREA

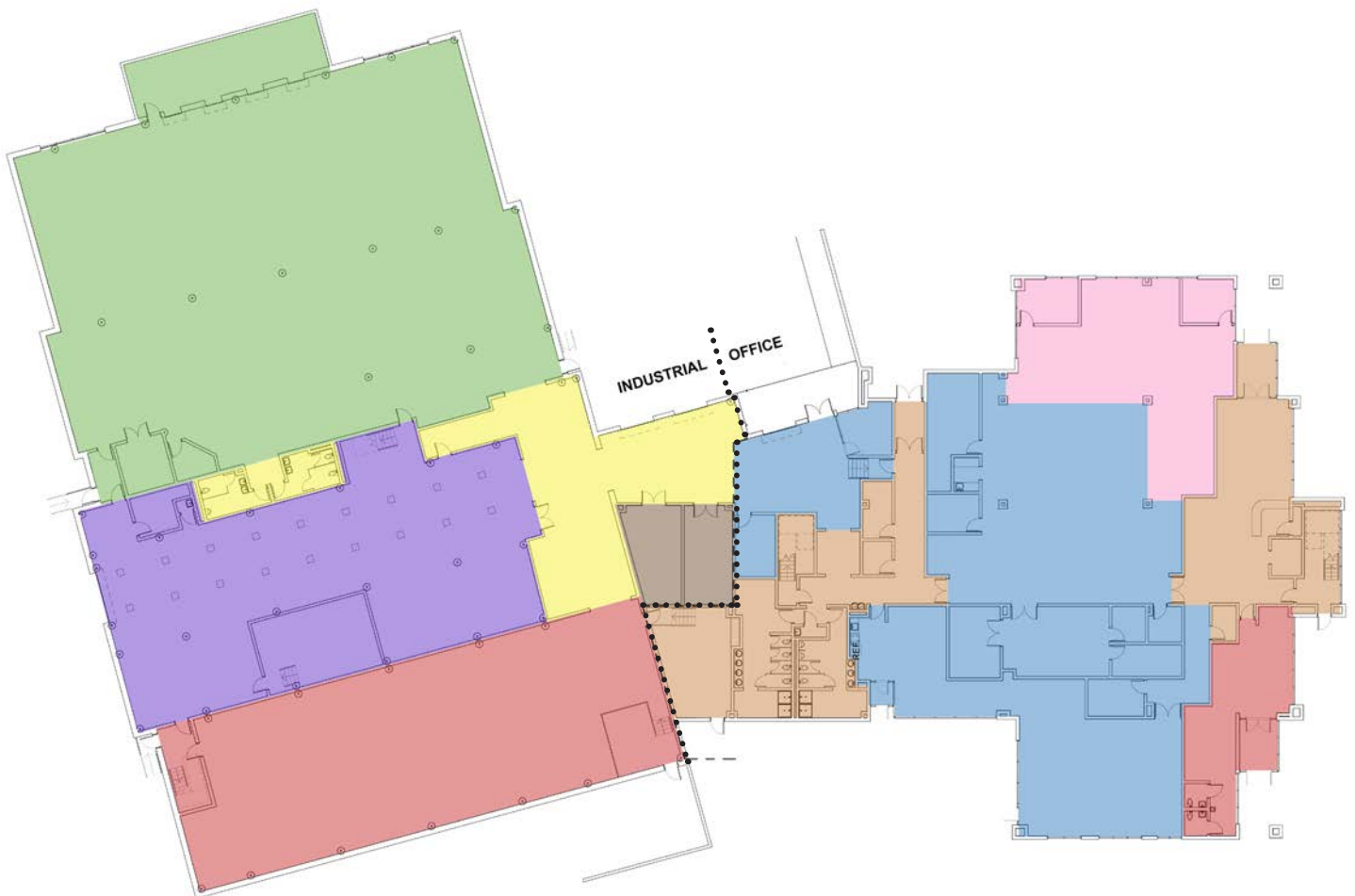

One Monitor Drive

CONCORD, NH 03301

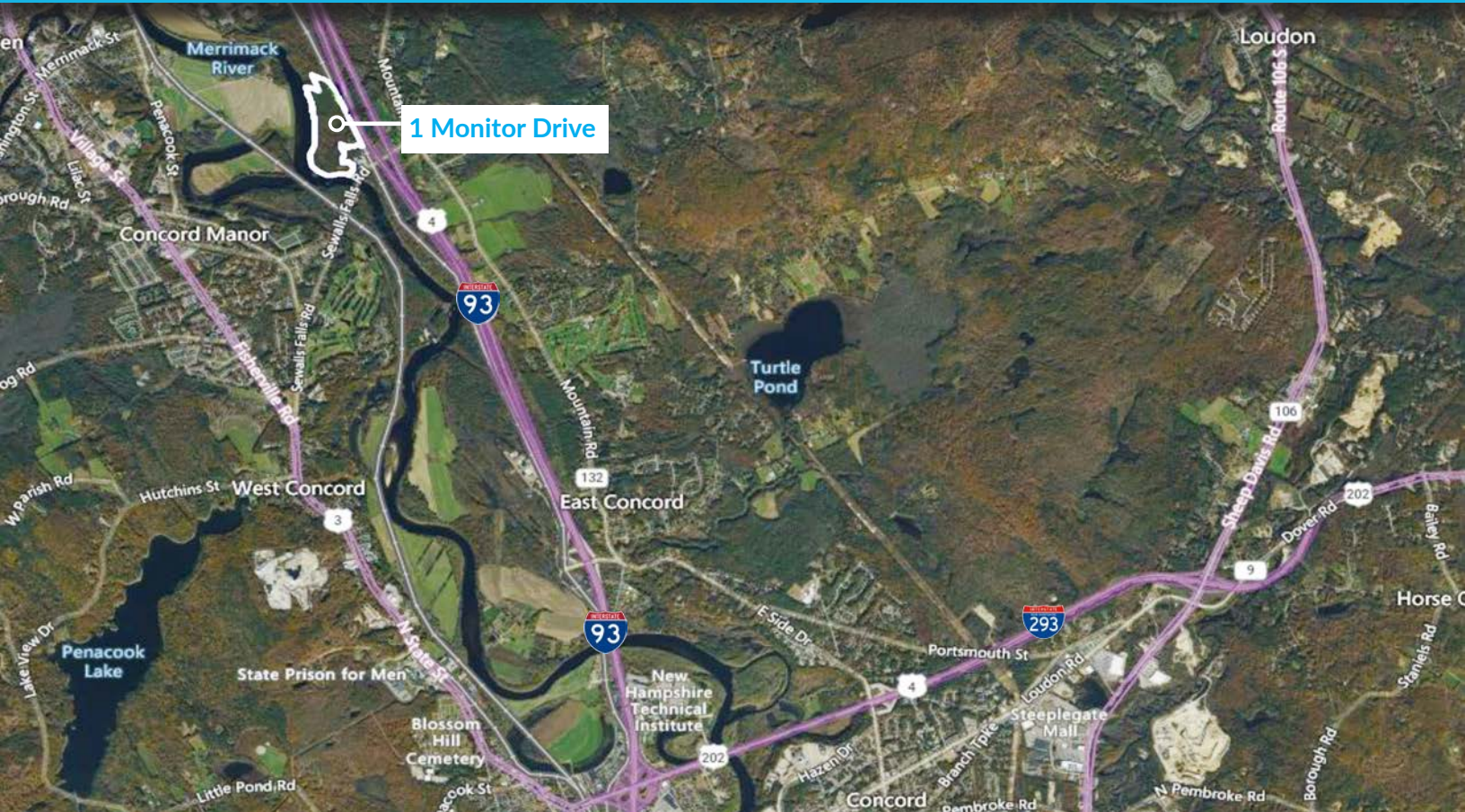

CONTACT US



ROGER DIEKER
MANAGING BROKER | PARTNER
+1 603 540 8315 C
+1 603 333 1333 T
RDIEKER@BOULOS.COM



NICK DENISCO
ASSOCIATE
+1 978 239 8128 C
+1 603 333 1333 T
NDENISCO@BOULOS.COM



650 ELM STREET, SUITE 102
MANCHESTER, NH 03101
603.333.1333 | boulos.com



State of New Hampshire
OFFICE OF PROFESSIONAL LICENSURE AND CERTIFICATION
DIVISION OF LICENSING AND BOARD ADMINISTRATION
7 Eagle Square, Concord, NH 03301-4980
Phone: 603-271-2152

BROKERAGE RELATIONSHIP DISCLOSURE FORM
(This is Not a Contract)

This form shall be presented to the consumer at the time of first business meeting, prior to any discussion of confidential information

***Right Now,
You Are a
Customer***

As a customer, the licensee with whom you are working is not obligated to keep confidential the information that you might share with him or her. As a customer, you should not reveal any confidential information that could harm your bargaining position.

As a customer, you can expect a real estate licensee to provide the following customer-level services:

- To disclose all material defects known by the licensee pertaining to the on-site physical condition of the real estate;
- To treat both the buyer/tenant and seller/landlord honestly;
- To provide reasonable care and skill;
- To account for all monies received from or on behalf of the buyer/tenant or seller/landlord relating to the transaction;
- To comply with all state and federal laws relating to real estate brokerage activity; and
- To perform ministerial acts, such as showing property, preparing, and conveying offers, and providing information and administrative assistance.

To Become a Client

Clients receive more services than customers. You become a client by entering into a written contract for representation as a seller/landlord or as a buyer/tenant.

As a client, in addition to the customer-level services, you can expect the following client-level services

- Confidentiality;
- Loyalty;
- Disclosure;
- Lawful Obedience; and
- Promotion of the client's best interest.
- For seller/landlord clients this means the agent will put the seller/landlord's interests first and work on behalf of the seller/landlord.
- For buyer/tenant clients this means the agent will put the buyer/tenant's interest first and work on behalf of the buyer/tenant.

Client-level services also include advice, counsel, and assistance in negotiations.

For important information about your choices in real estate relationships, please see page 2 of this disclosure form.

I acknowledge receipt of this disclosure as required by the New Hampshire Real Estate Commission (Pursuant to Rea 701.01).
I understand as a customer I should not disclose confidential information.

Name of Consumer (Please Print)

Name of Consumer (Please Print)

Signature of Consumer

Date

Signature of Consumer

Date

Provided by: Name & License #

Date

(Name and License # of Real Estate Brokerage Firm)

_____ consumer has declined to sign this form
(Licensees Initials)

Types of Brokerage Relationships commonly practiced in New Hampshire

SELLER AGENCY (RSA 331-A:25-b)

A seller agent is a licensee who acts on behalf of a seller or landlord in the sale, exchange, rental, or lease of real estate. The seller is the licensee's client, and the licensee has the duty to represent the seller's best interest in the real estate transaction.

BUYER AGENCY (RSA 331-A:25-c)

A buyer agent is a licensee who acts on behalf of a buyer or tenant in the purchase, exchange, rental, or lease of real estate. The buyer is the licensee's client, and the licensee has the duty to represent the buyer's best interests in the real estate transaction.

SINGLE AGENCY (RSA 331-A:25-b; RSA 331-A:25-c)

Single agency is a practice where a firm represents the buyer only, or the seller only, but never in the same transaction. Disclosed dual agency cannot occur.

SUB-AGENCY (RSA 331-A:2, XIII)

A sub-agent is a licensee who works for one firm but is engaged by the principal broker of another firm to perform agency functions on behalf of the principal broker's client. A sub-agent does not have an agency relationship with the customer.

DISCLOSED DUAL AGENCY (RSA 331-A:25-d)

A disclosed dual agent is a licensee acting for both the seller/landlord and the buyer/tenant in the same transaction with the knowledge and written consent of all parties.

The licensee cannot advocate on behalf of one client over another. Because the full range of duties cannot be delivered to both parties, written informed consent must be given by all clients in the transaction.

A dual agent may not reveal confidential information without written consent, such as:

1. Willingness of the seller to accept less than the asking price.
2. Willingness of the buyer to pay more than what has been offered.
3. Confidential negotiating strategy not disclosed in the sales contract as terms of the sale.
4. Motivation of the seller for selling nor the motivation of the buyer for buying.

DESIGNATED AGENCY (RSA 331-A:25-e)

A designated agent is a licensee who represents one party of a real estate transaction and who owes that party client-level services, whether or not the other party to the same transaction is represented by another individual licensee associated with the same brokerage firm.

FACILITATOR (RSA 331-A:25-f)

A facilitator is an individual licensee who assists one or more parties during all or a portion of a real estate transaction without being an agent or advocate for the interests of any party to such transaction. A facilitator can perform ministerial acts, such as showing property, preparing and conveying offers, and providing information and administrative assistance, and other customer-level services listed on page 1 of this form. This relationship may change to an agency relationship by entering into a written contract for representation, prior to the preparation of an offer.

ANOTHER RELATIONSHIP (RSA 331-A:25-a)

If another relationship between the licensee who performs the service and the seller, landlord, buyer or tenant is intended, it must be described in writing and signed by all parties to the relationship prior to services being rendered.