

720

EAST 42ND STREET

New York, NY

MARKET-
ADJUSTED
PRICING!

ELEVATE YOUR INNOVATION FUEL YOUR TECH VISION

Steps to Grand Central

27,532 RSF - 278,859 RSF Available

 CUSHMAN &
WAKEFIELD

220 EAST 42ND
STREET



**LARGE USABLE
PRIVATE 3RD
FLOOR TERRACE**

SUBLEASE HIGHLIGHTS

- Brand new installation with creative finishes
- Newly furnished, wired, move-in ready space
- 12' to 19' slab heights
- Will lease floors individually
- Short or Long term flexibility through to October 2048
- Large windows facing East and West provide tremendous natural light
- Private terrace with capacity for 250+



VIEW LOOKING EAST



Sublease Multiple Floors in PRIME GRAND CENTRAL LOCATION

Asking Rent: Upon Request Possession: Immediate Term: Flexible through October 2048

VIEW	AVAILABILITIES	SLAB HEIGHTS
	Partial 7th Floor (Divisible) – 27,532 RSF – 41,425	12'-2"
	Entire 6th Floor: 67,301 RSF	12'-2"
	Entire 5th Floor: 60,422 RSF	12'-2"
	Entire 3rd Floor: 65,310 RSF (Large Usable Terrace)	12'-2"
	Partial 2nd Floor: 44,401 RSF	19'
	TOTAL: 278,859 RSF	

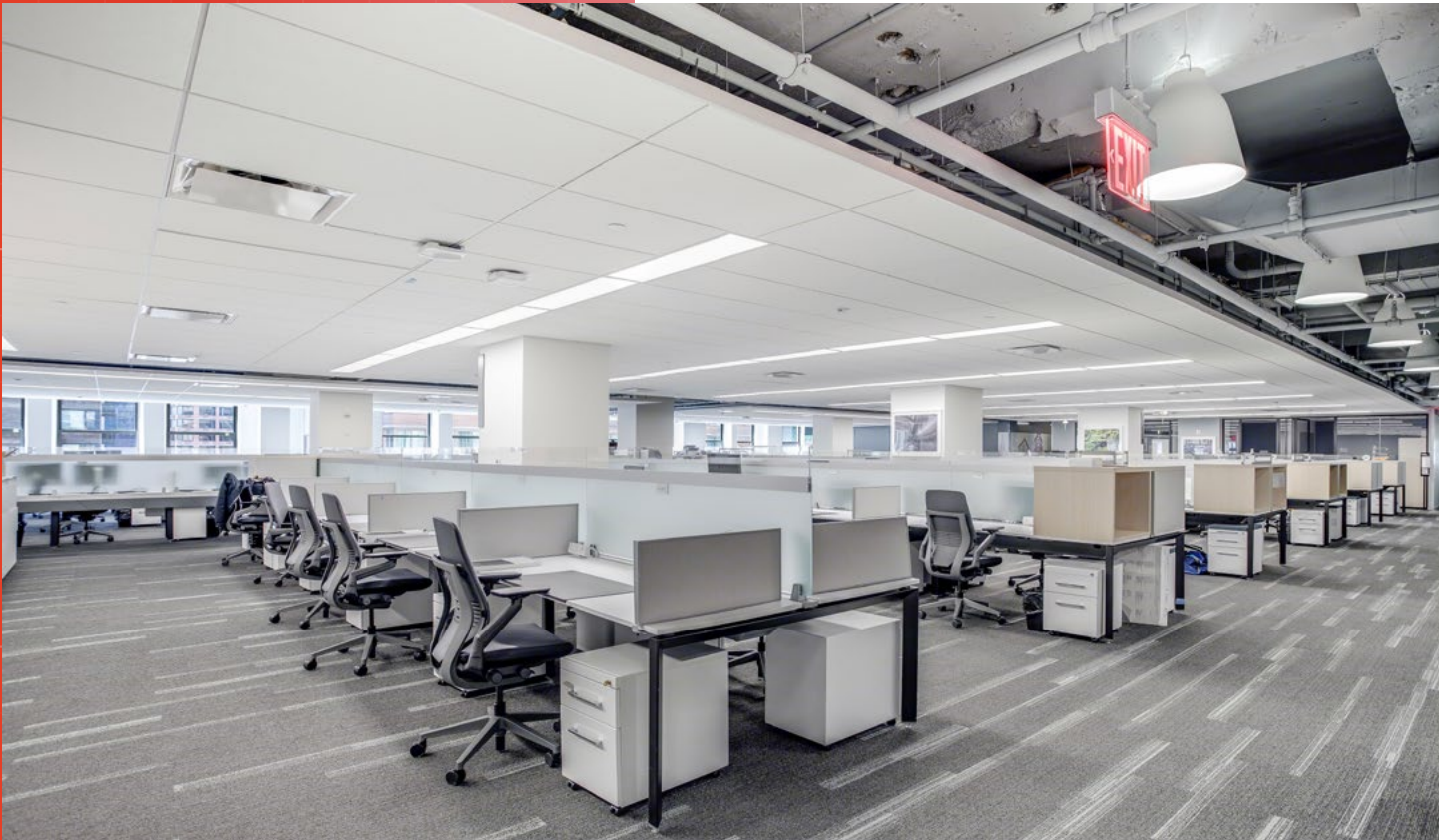

Premier Workplace Experience



Energizing Common Areas



Concourse Level – 15,107 RSF Training / conferencing with 18' ceilings



8 Conference/training rooms:

- Two (2) 35 person rooms
- Two (2) 24 person rooms
- Two (2) 30+ person rooms
- One (1) 22 person room
- One (1) 14 person room

Ground Floor — 14,618 RSF Private entrance



One (1) private entrance with reception

Ten (10) workstations

Forty (40) seats in waiting area

Five (5) Offices

Two (2) Phone rooms

Four (4) Conference/ Training rooms:

- Two (2) 36+ person rooms
- Two (2) 28 person rooms

Partial 2nd Floor — 44,401 RSF Creative installation with 19' ceilings



Ten (10) Offices

Two-hundred Fifty-five (255) Workstations

Seven (7) Conference rooms:

- Three (3) 6 person rooms
- Four (4) 4 person rooms

Six (6) Phone rooms

Five (5) Collab spaces

Entire 3rd Floor — 65,310 RSF Premier crossroads visibility



One (1) Large usable terrace

Four Hundred Twenty-five (425) Workstations

Seventeen (17) Offices

Eight (8) Conference rooms:

- Four (4) 10 person rooms
- Four (4) 6 person rooms

Six (6) Collab spaces

Entire 5th Floor – 60,422 RSF



- Three hundred fifty-five (355) Workstations
- Fifteen (15) Offices
- Thirteen (13) Conference rooms:
 - Three (3) 6 person rooms
 - Two (2) 21 person rooms
 - Two (2) 48 person rooms
 - Two (2) 24 person rooms
 - One (1) 20 person room
 - One (1) 16 person room
 - One (1) 12 person room

Entire 6th Floor – 67,301 RSF



- Three hundred sixty-four (364) Workstations
- Thirty (30) Offices
- Ten (10) Conference rooms:
 - Five (5) 6 person rooms
 - Two (2) 14 person rooms
 - One (1) 20 person room
 - One (1) 12 person room
 - One (1) 10 person rooms
- Six (6) Collab Spaces

Partial 7th Floor – 41,425 RSF



- Three hundred nine (309) Workstations
- Sixteen (16) Offices
- Three (3) Conference rooms:
 - Two (2) 6 person rooms
 - One (1) 12 person room
- Four (4) Collab Spaces

Partial 7th Floor Divided — 13,893 RSF - 27,532 RSF

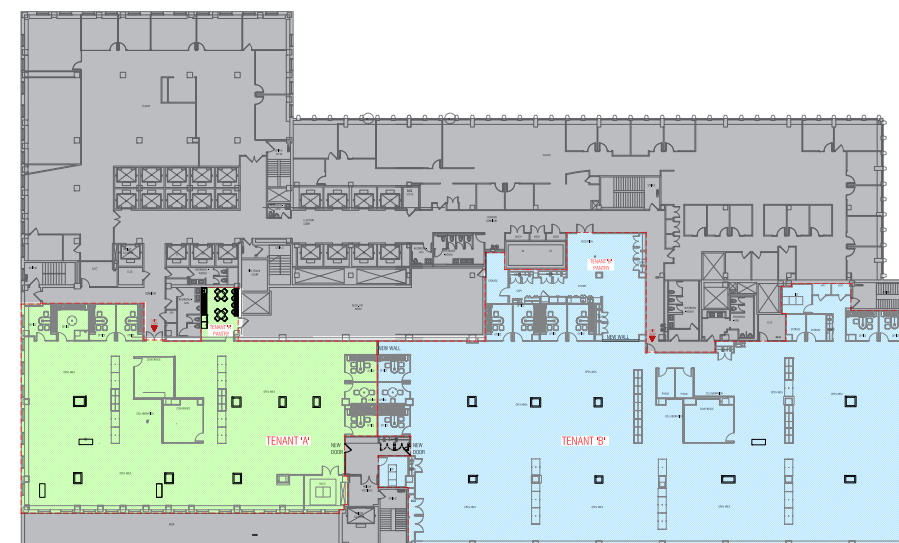

220 East 42nd Street allows for easy connection to major subway lines; commuter rail, bus, and airport access

Premier Access within Midtown Manhattan

TRANSIT/SUBWAY	DRIVE	WALK	DISTANCE
Grand Central-42 Street 4 5 6 7 S	1 min	5 min	0.3 mi
5 Avenue-Bryant Park 7	2 min	10 min	0.5 mi
33 Street 4 6	3 min	13 min	0.7 mi
51 Street 4 6	2 min	13 min	0.7 mi
42 Street-Bryant Park B D F M	3 min	14 min	0.7 mi
COMMUTER RAIL	DRIVE	WALK	DISTANCE
Grand Central Terminal	3 min	9 min	0.5 mi
New York Penn Station (NJT)	7 min	--	1.4 mi
AIRPORT	DRIVE	WALK	DISTANCE
La Guardia Airport	13 min	--	8.5 mi
Newark Liberty International Airport	24 min	--	15.0 mi
John F. Kennedy International Airport	23 min	--	16.4 mi

HOTELS

- 1

Club Quarters Grand Central
- 2

Hotel Boutique at Grand Central
- 3

Fitzpatrick Grand Central Hotel
- 4

Hyatt Grand Central New York
- 5

EVEN Hotel - Midtown East
- 6

Hotel 837
- 7

AKA United Nations
- 8

Hampton Inn Grand Central
- 9

Millennium Hilton One UN Plaza
- 10

The Westin Grand Central
- 11

The Renwick Hotel
- 12

The Court by St Giles
- 13

The Court - St Giles Premier Hotel
- 14

Westgate New York Grand Central
- 15

Pod 39 Hotel
- 16

Murray Hill East Suites
- 17

Eastgate Tower Hotel
- 9

Pickler
- 10

Kaoru
- 11

Ben & Jack's Steakhouse
- 12

NAYA - 44 & 3rd
- 13

Sushi Tsushima
- 14

Sakagura
- 15

MIFUNE New York
- 16

Los Tacos No. 1
- 17

Soba Totto
- 18

Pokeworks
- 19

Luke's Lobster Midtown East
- 20

The Capital Grille
- 21

Le Botaniste
- 22

Alcala Restaurant
- 23

Sushi Yasuda
- 24

MIGHTY Bowl
- 25

Previti Pizza
- 26

Osteria Laguna
- 27

Pietro's
- 28

Patsy's Pizzeria
- 29

Sandwicherie of New York
- 30

Sinigual
- 31

Ground Central
- 32

Momosan Ramen & Sake
- 33

Shake Shack
- 34

Docks Oyster Bar NYC
- 35

Sam's Place
- 36

Wokuni
- 37

wagamama
- 38

Sushi Ryusei
- 39

El Rio Grande

- 40

Tempura Matsui
- 41

Delectica
- 42

Ahimsa
- 43

Sachi Asian Bistro
- 44

El Pote Espanol Restaurant
- 45

Little Alley
- 46

Sarge's Delicatessen & Diner
- 47

Bravest

HEALTH CLUBS/GYMS

- 1

Vanderbilt Branch YMCA
- 2

New York Sports Clubs
- 3

Equinox East 44th Street
- 4

Blink Fitness
- 5

New York Sports Clubs
- 6

Vanderbilt Health Club
- 7

Blink Fitness - Murray Hill
- 8

Orangetheory Fitnes
- 9

BNL Fitness

ARTS & ENTERTAINMENT

- 1

Japan Society
- 2

Romanian Cultural Center
- 3

Grand Central Terminal
- 4

Chrysler Building
- 5

United Nations Headquarters

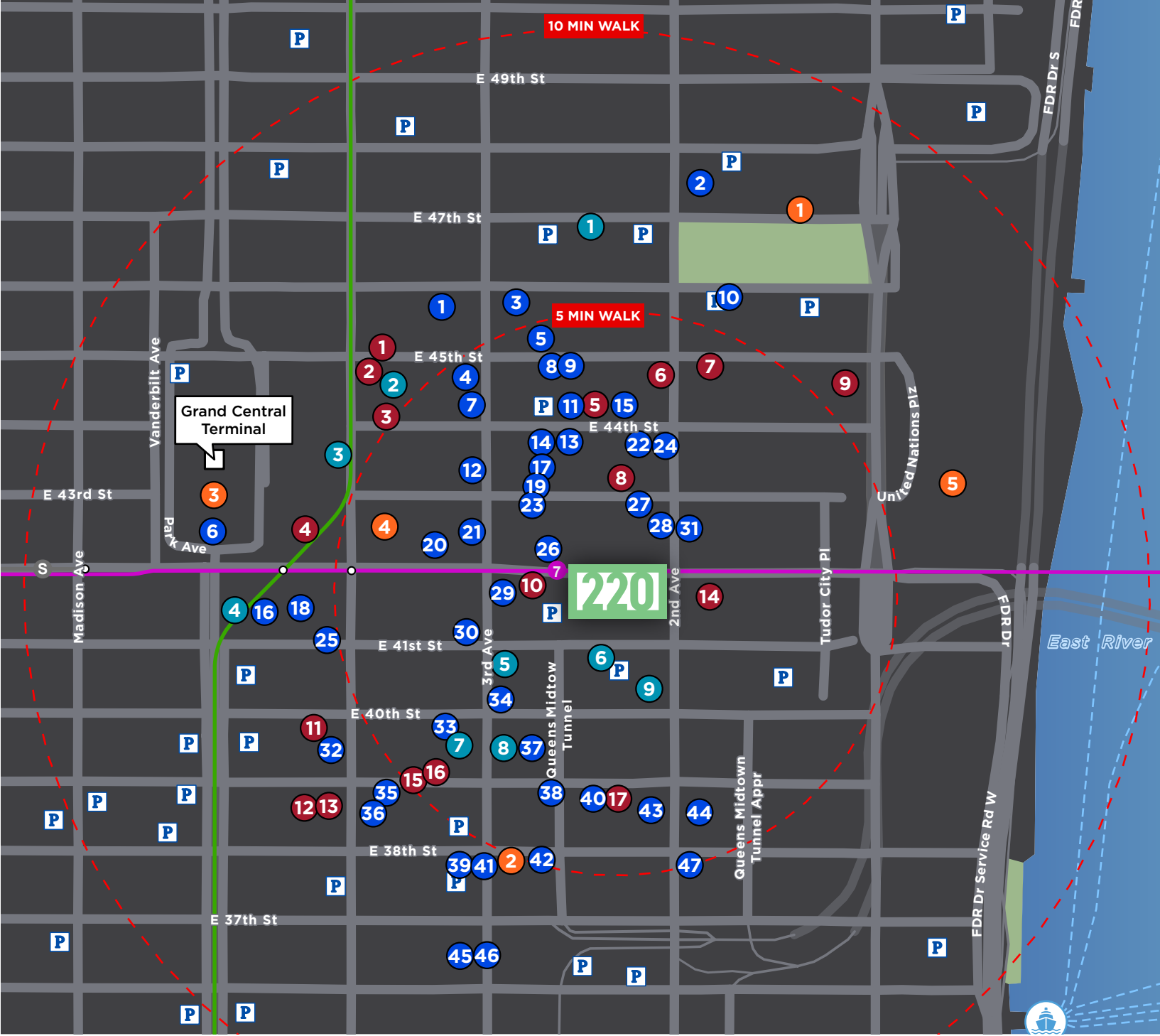

Demographics



POPULATION	2 MILE	5 MILE	10 MILE
2022 Population	658,970	2,920,210	7,536,620
Annual Growth 2010-2022	0.7%	0.6%	0.1%
Median Age	39.8	38.2	37.8



INCOME	2 MILE	5 MILE	10 MILE
Avg Household Income	\$157,397	\$128,165	\$103,470
Median Household Income	\$127,290	\$93,890	\$71,565
Median Age	39.8	38.2	37.8



EAST 42ND STREET

New York, NY

Contact us today to tour this unique opportunity
in the heart of Midtown East

TARA STACOM

+1 212 841 7843

tara.stacom@cushwake.com

PETER TRIVELAS

+1 212 328 4205

peter.trivelas@cushwake.com

REMY LIEBERSOHN

+1 212 841 7638

remy.liebersohn@cushwake.com

JUSTIN SODOKOFF

+1 212 589 5105

justin.sodokoff@cushwake.com



©2022 Cushman & Wakefield. All rights reserved. The information contained in this communication is strictly confidential. This information has been obtained from sources believed to be reliable but has not been verified. NO WARRANTY OR REPRESENTATION, EXPRESS OR IMPLIED, IS MADE AS TO THE CONDITION OF THE PROPERTY (OR PROPERTIES) REFERENCED HEREIN OR AS TO THE ACCURACY OR COMPLETENESS OF THE INFORMATION CONTAINED HEREIN, AND SAME IS SUBMITTED SUBJECT TO ERRORS, OMISSIONS, CHANGE OF PRICE, RENTAL OR OTHER CONDITIONS, WITHDRAWAL WITHOUT NOTICE, AND TO ANY SPECIAL LISTING CONDITIONS IMPOSED BY THE PROPERTY OWNER(S). ANY PROJECTIONS, OPINIONS OR ESTIMATES ARE SUBJECT TO UNCERTAINTY AND DO NOT SIGNIFY CURRENT OR FUTURE PROPERTY PERFORMANCE.