

WATERFRONT LAND FOR SALE

415-595 EAST 3RD STREET

PITTSBURG, CALIFORNIA



THREE CONTIGUOUS WATERFRONT PARCELS
TOTALING ± 18.38 AC

MICHAEL WALKER

Vice President
+1 510 874 1979
michael.walker@cbre.com
Lic. 00924838

GREG SMYTH

First Vice President
+1 925 296 7717
greg.smyth@cbre.com
Lic. 01131484

CBRE

415-595 EAST 3RD STREET

PROPERTY FEATURES

- Location: Three contiguous parcels located on the north line of E 3rd Street at the northern terminus of Harbor Street at E 3rd Street.
Abuts the southern waterfront of the New York Slough, East of Suisun Bay ($\pm 1,425$ linear feet).
- Parcel Number: Acreage:
073-010-008-8 ± 0.29 AC 415 E 3rd St, Pittsburg
073-010-014-6 ± 4.32 AC
073-010-015-3 ± 13.77 AC 595 E 3rd St, Pittsburg
Total ± 18.38 AC
- Zoning: CW (Waterfront Commercial) and IG (General Industrial)
- Rail: None (former rail service has been removed from site)
- Pier: Pier shown in aerials has been demolished.
- Price: Unpriced

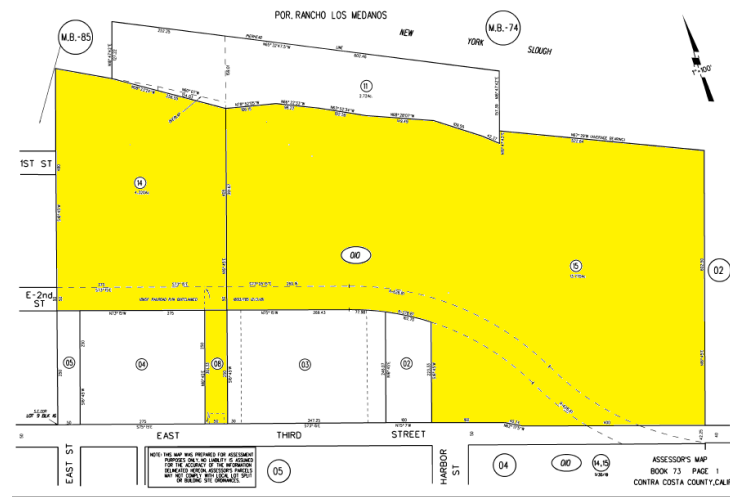



WATERFRONT LAND FOR SALE

415-595 EAST 3RD STREET

CONTACT BROKER

MICHAEL WALKER

Vice President
+1 510 874 1979
michael.walker@cbre.com
Lic. 00924838

GREG SMYTH

First Vice President
+1 925 296 7717
greg.smyth@cbre.com
Lic. 01131484

CBRE

© 2020 CBRE, Inc. All rights reserved. This information has been obtained from sources believed reliable, but has not been verified for accuracy or completeness. You should conduct a careful, independent investigation of the property and verify all information. Any reliance on this information is solely at your own risk. CBRE and the CBRE logo are service marks of CBRE, Inc. All other marks displayed on this document are the property of their respective owners, and the use of such logos does not imply any affiliation with or endorsement of CBRE. Photos herein are the property of their respective owners. Use of these images without the express written consent of the owner is prohibited.