



Colliers



For lease

7113 Three Chopt Road Richmond, VA

Triangle Park | Medical/Office Space Available

- Available Space:
 - Up to 9,799 RSF, medical office space
 - 3,690 RSF
 - 6,109 RSF
 - *Former Pediatric Associates of Richmond location with immediate access to parking lot*
- Suite 205 - 570 RSF
- Updated first floor lobby 2024
- Great access to I-64/Glenside Dr
- Great West End location, at intersection of Patterson Ave and Three Chopt Rd
- Within walking distance to numerous restaurants/retail amenities at the Village Shopping Center
- Verizon Fios available

Contact us:

Catherine Walker

Vice President

+1 804 968 1978

catherine.walker@colliers.com

Colliers International

2221 Edward Holland Dr

Suite 600 | Richmond, VA

P: +1 804 320 5500

7113 Three Chopt Road

Up to 9,799 RSF, medical office space

- 3,690 RSF

- 6,109 RSF

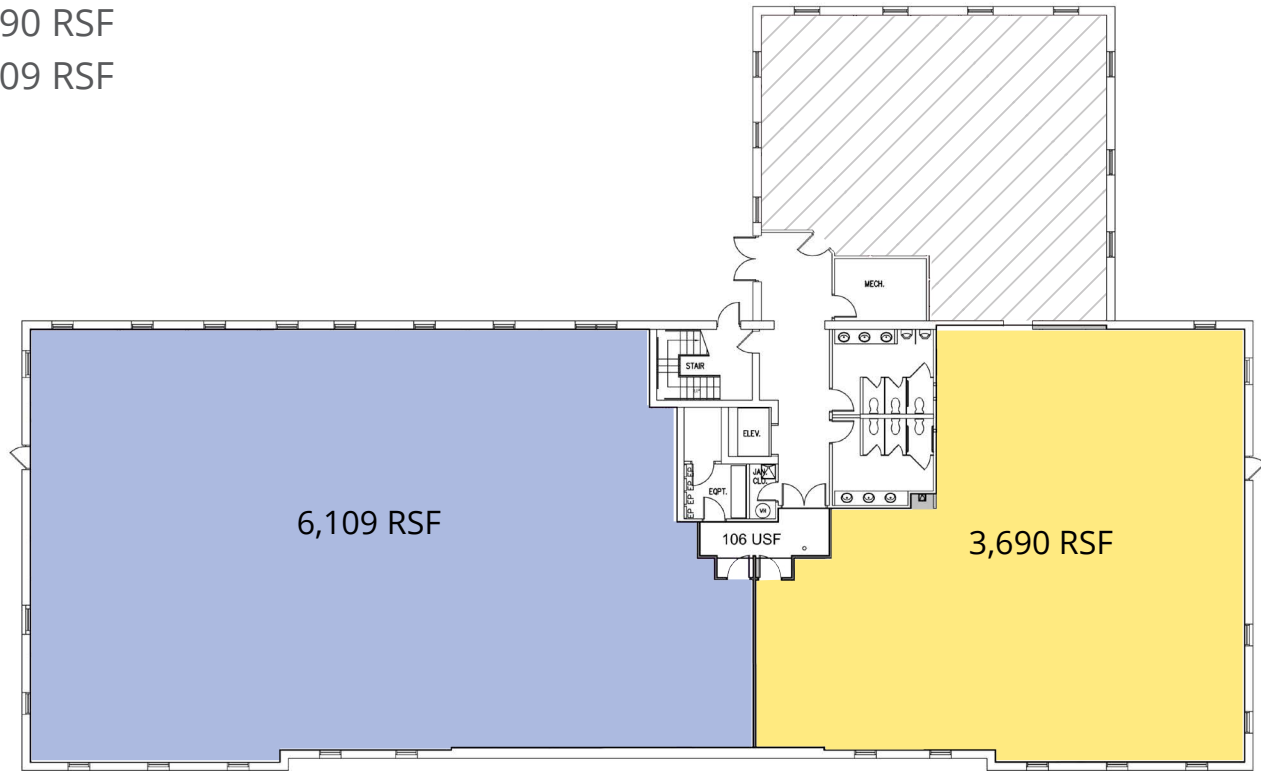

7113 Three Chopt Road



Contact us:

Catherine Walker

Vice President

+1 804 968 1978

catherine.walker@colliers.com

Copyright © 2026 Colliers International. Information herein has been obtained from sources deemed reliable, however its accuracy cannot be guaranteed. The user is required to conduct their own due diligence and verification.

Colliers International

2221 Edward Holland Dr

Suite 600 | Richmond, VA

P: +1 804 320 5500

colliers.com/richmond