



For Lease

914 Coolidge St Honolulu, HI 96826

One Block from Mo'ili'ili Neighborhood Park and Longs Drugs

In the heart of the Mo'ili'ili community, one block from S King Street and Mo'ili'ili Neighborhood Park and Longs Drugs. In close proximity to Japanese Culture Center and various grocery stores and restaurants such as Down to Earth, Raising Cane's, Burger King and Teddy's Burger. This property is only 1.7 miles from University of Hawaii at Manoa campus and Waikiki, with easy access from major thoroughfares such as H1, S King Street and University Avenue.

Modified Gross Rent:

\$4.00

PSF/Month

Contact us:

Maria Su (S)

Senior Associate
Retail Services Division

Lic# RS-79874

808 691 0405

maria.su@colliers.com

220 S. King Street, Suite 1800
Honolulu, Hawaii 96813
808 524 2666
colliers.com

For Lease

Property Highlights

Address	914 Coolidge St., Honolulu, HI 96826
TMK	(1) 2-7-9-45
Modified Gross Rent	\$4.00 PSF/Mo.
Term	3 - 10 Years
Zoning	BMX-3
Total Floors	2
Date Available	Immediately
Available Spaces	Unit 102 (500 SF) Unit 103 (720 SF)
Total Building Size	5,920 SF



Demographics (2023)

	1-mile	3-mile	5-mile
Population	65,306	221,533	314,541
Households	31,947	99,194	125,948
Families	13,883	50,060	69,540
Median Home Value	\$913,401	\$1,244,646	\$1,286,485
Median Age	44.2	45.8	44.8
Bachelor's Degree +	25.5%	27.7%	25.4%

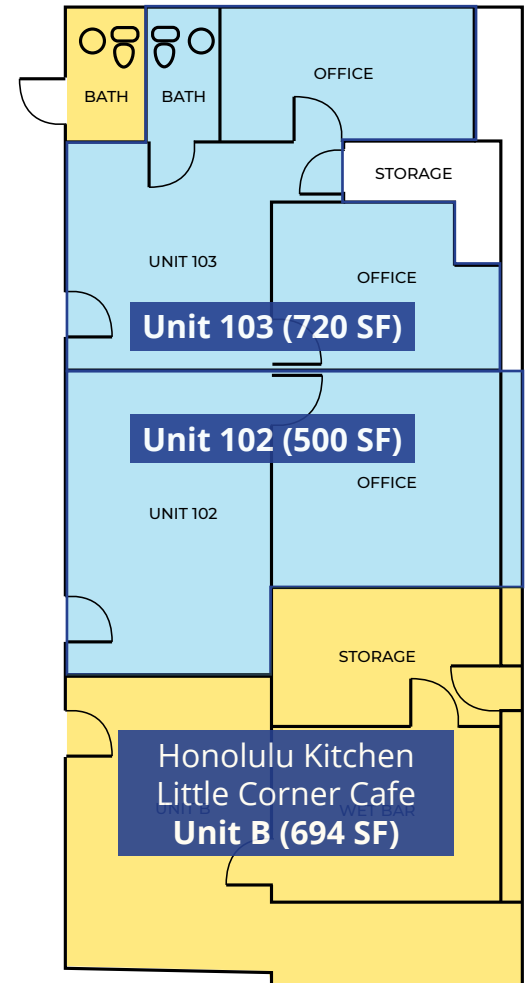

This document/email has been prepared by Colliers for advertising and general information only. Colliers makes no guarantees, representations or warranties of any kind, expressed or implied, regarding the information including, but not limited to, warranties of content, accuracy and reliability. Any interested party should undertake their own inquiries as to the accuracy of the information. Colliers excludes unequivocally all inferred or implied terms, conditions and warranties arising out of this document and excludes all liability for loss and damages arising there from. This publication is the copyrighted property of Colliers and /or its licensor(s). © 2024. All rights reserved. This communication is not intended to cause or induce breach of an existing listing agreement.

220 S. King Street, Suite 1800
Honolulu, Hawaii 96813
808 524 2666
colliers.com