



**PAD B**

**PAD D**

**CACTUS AVE**

**RAINBOW BLVD**

# CACTUS SHOPS

N-NWC CACTUS AVE & RAINBOW BLVD, LAS VEGAS, NV 89178

**RETAIL PADS AVAILABLE FOR BTS, RBTS AND GROUND LEASE**



roicre.com

# PROPERTY INFORMATION

**±8,260 SF**  
PAD B

**±3,200 SF**  
PAD D - WITH DRIVE THRU

Previously approved for free standing building with drive thru

Convenient cross-access to Cactus Ave & Rainbow Blvd with 41,000 VPD combined

Property is located in the high growth Southwest Las Vegas market, between Southern Highlands and Mountain's Edge communities

Less than 2 miles to Blue Diamond Rd and less than 4 miles to I-15 freeway



**±0.77 AC (Pad B)**

**±0.69 AC (Pad D)**

Parcel Size



**General Commercial (C-2)**

Zoning



**176-27-823-006**

**176-27-823-008**

Parcel Number

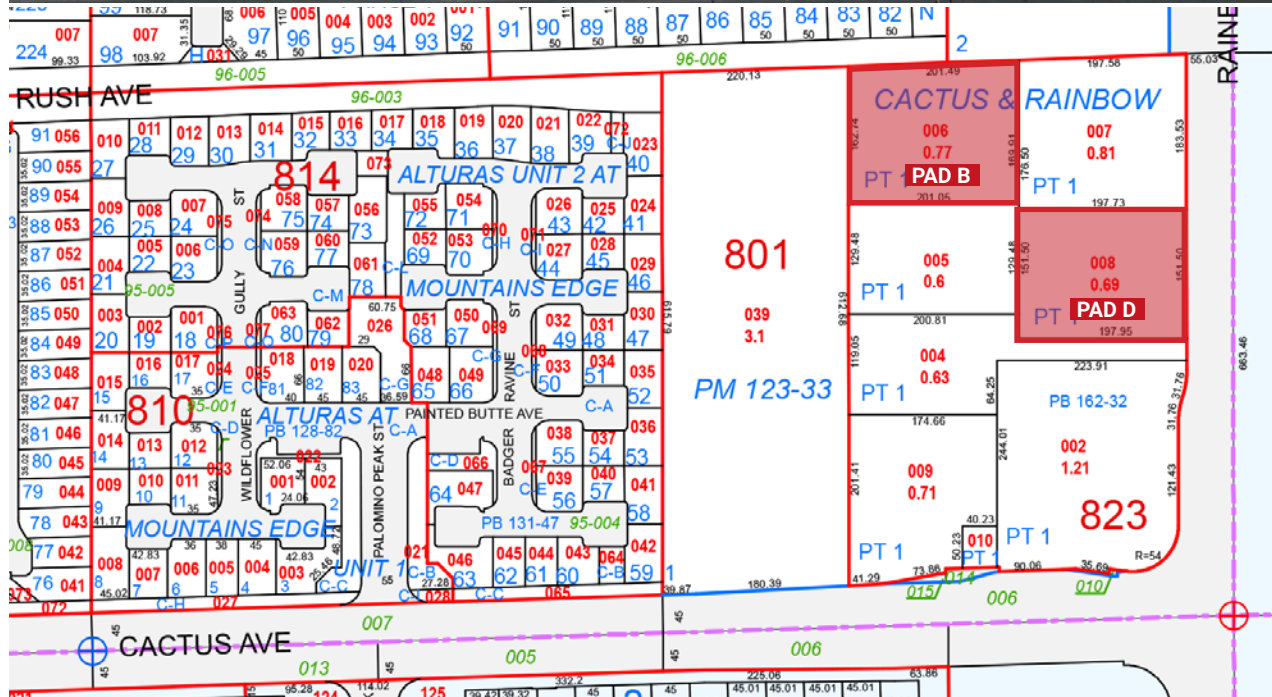

# SITE PLAN



# AREA DEMOGRAPHICS



## POPULATION

1 Mile	3 Miles	5 Miles
20,222	109,166	245,634



## AVERAGE HOUSEHOLD INCOME

1 Mile	3 Miles	5 Miles
\$141,765	\$143,229	\$136,363



## TRAFFIC COUNTS

Cactus Ave	Rainbow Blvd
22,100 VPD	19,600 VPD

Sources:  
SitesUSA 2025  
TRINA, NV DOT 2024



# HOUSING GROWTH

UNDER CONSTRUCTION

PLANNED

COMPLETED





[www.roicre.com](http://www.roicre.com)



9121 W Russell Rd  
Suite 111  
Las Vegas, NV 89148

# FOR MORE INFORMATION

DAN ADAMSON



702.550.4934



[dan@roicre.com](mailto:dan@roicre.com)



NV Lic# B.0026992.CORP

CHRIS WALDBURGER, CCIM



702.483.3683



[chris@roicre.com](mailto:chris@roicre.com)



NV Lic S.0190814

Let's Stay Connected!



[facebook.com/roicre](https://facebook.com/roicre)



[@roi.cre](https://instagram.com/roi.cre)



[linkedin.com/company/roicre/](https://linkedin.com/company/roicre/)

#### DISCLAIMER

All information contained herein is from sources we deem reliable, and we have no reason to doubt its accuracy; however, no guarantee or responsibility is assumed thereof, and it shall not form any part of future contracts. Properties are submitted subject to errors and omissions and all information should be carefully verified. All measurements quoted herein are approximate. Demographics are provided by SitesUSA using data from private and government sources deemed to be reliable. The information herein is provided without representation or warranty. Georeferenced data herein are provided by Placer Labs, Inc. and is provided without representation or warranty. Photos contained herein are property of their respective owners. Photos do not guarantee the current condition of the property.