

# FOR LEASE

8015 Mackenzie Rd.  
St. Louis, MO 63123



## PROPERTY HIGHLIGHTS

- 2,643± SF in retail strip center
- Last remaining retail space for lease
- Former physical therapy space
- Three office spaces, one large open floor space, reception area, storage/utility room, break room, & one restroom
- High-visibility retail center located at the corner of Mackenzie Rd. and Heege Rd.
- Close proximity to Tower Tee Golf, Affton High School, 9 Mile Garden, and Center St. Louis Sports Complex
- High foot traffic from neighboring tenants
- 1.80± acre site

**LEASE RATE: \$15.00 PSF**

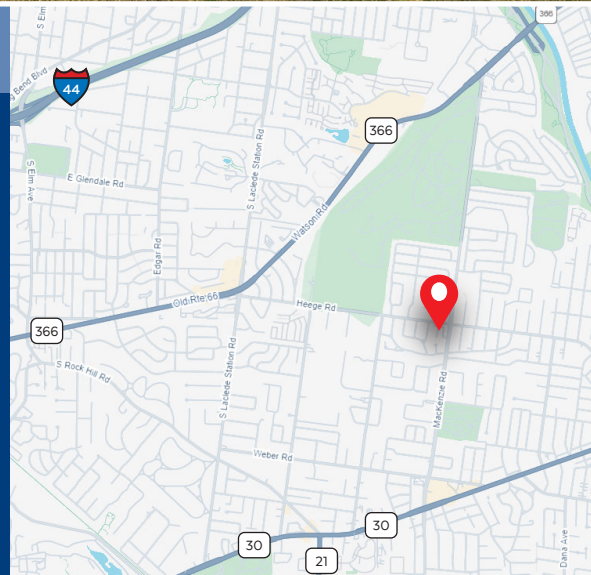

## CONTACT US:

**Michael Roberts Jr., Esq.**

## Vice President

Mobile: 314-363-6873

mroberts@gundakercommercial.com



**GUNDAKER**  
COMMERCIAL GROUP

55 Westport Plaza Drive, Ste. 200

St. Louis, MO 63146

M: 636-728-5100 | F: 636-728-5140

[gundakercommercial.com](http://gundakercommercial.com)   

The information contained herein was obtained from sources believed reliable. Gundaker Commercial Group makes no guarantees, warranties, or representation as to the completeness or accuracy thereof. The presentation of this property is submitted subject to errors, omissions, change of price or conditions prior to sale or lease, or withdrawal without notice.



# AERIAL

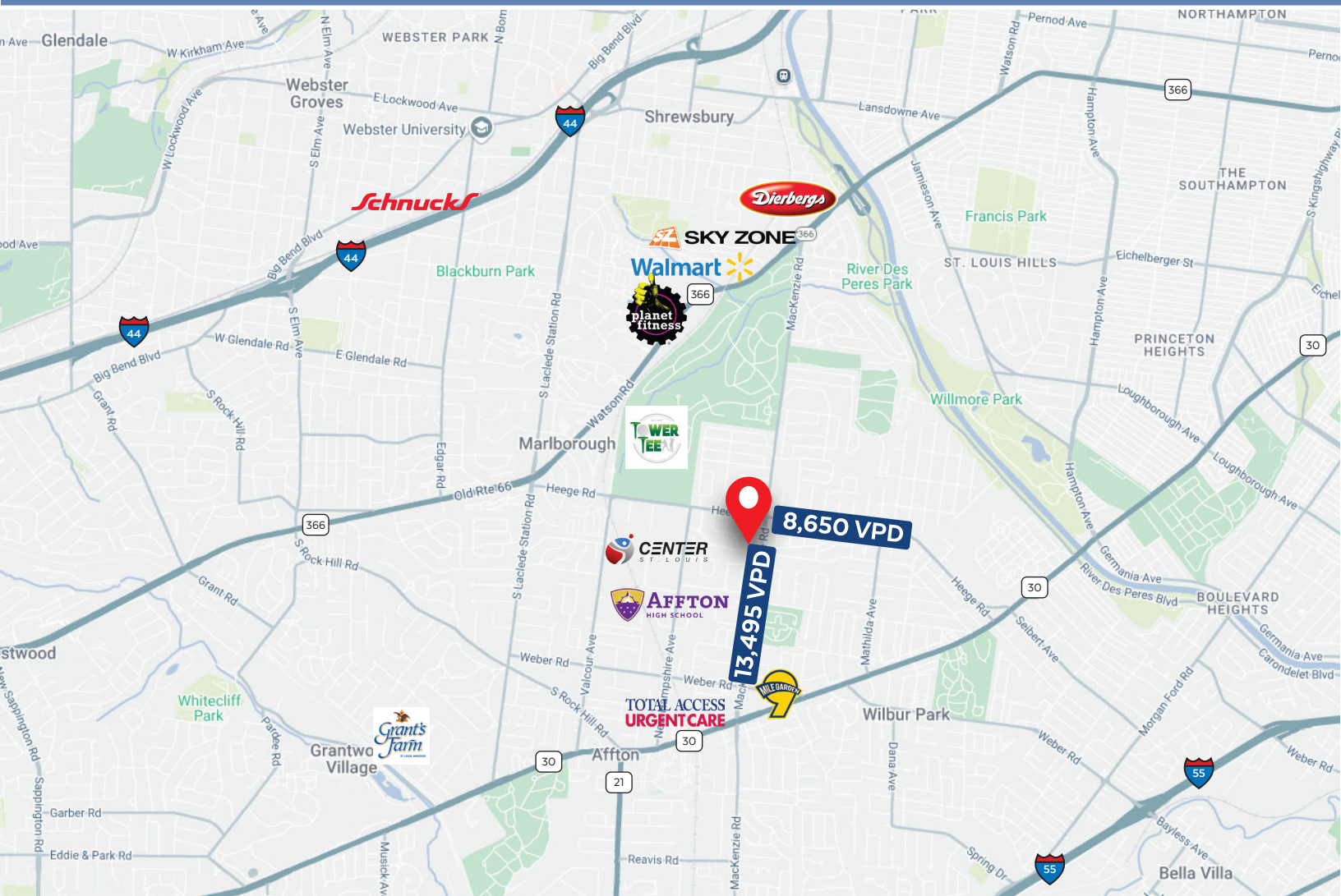

## EXTERIOR / INTERIOR

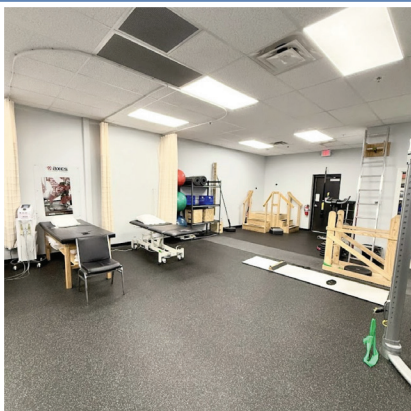
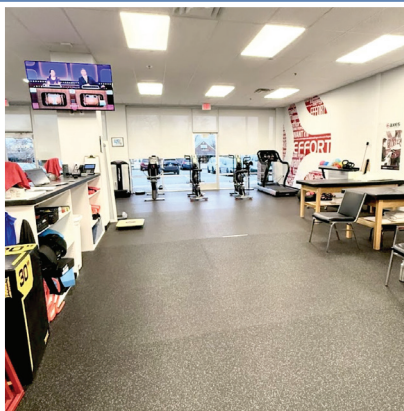

## CONTACT US:

**Michael Roberts Jr., Esq.**

Vice President

Mobile: 314-363-6873

mroberts@gundakercommercial.com



**GUNDAKER**  
COMMERCIAL GROUP

55 Westport Plaza Drive, Ste. 200

St. Louis, MO 63146

M: 636-728-5100 | F: 636-728-5140

[gundakercommercial.com](http://gundakercommercial.com) [in](#) [@](#) [f](#)

# FLOOR PLAN

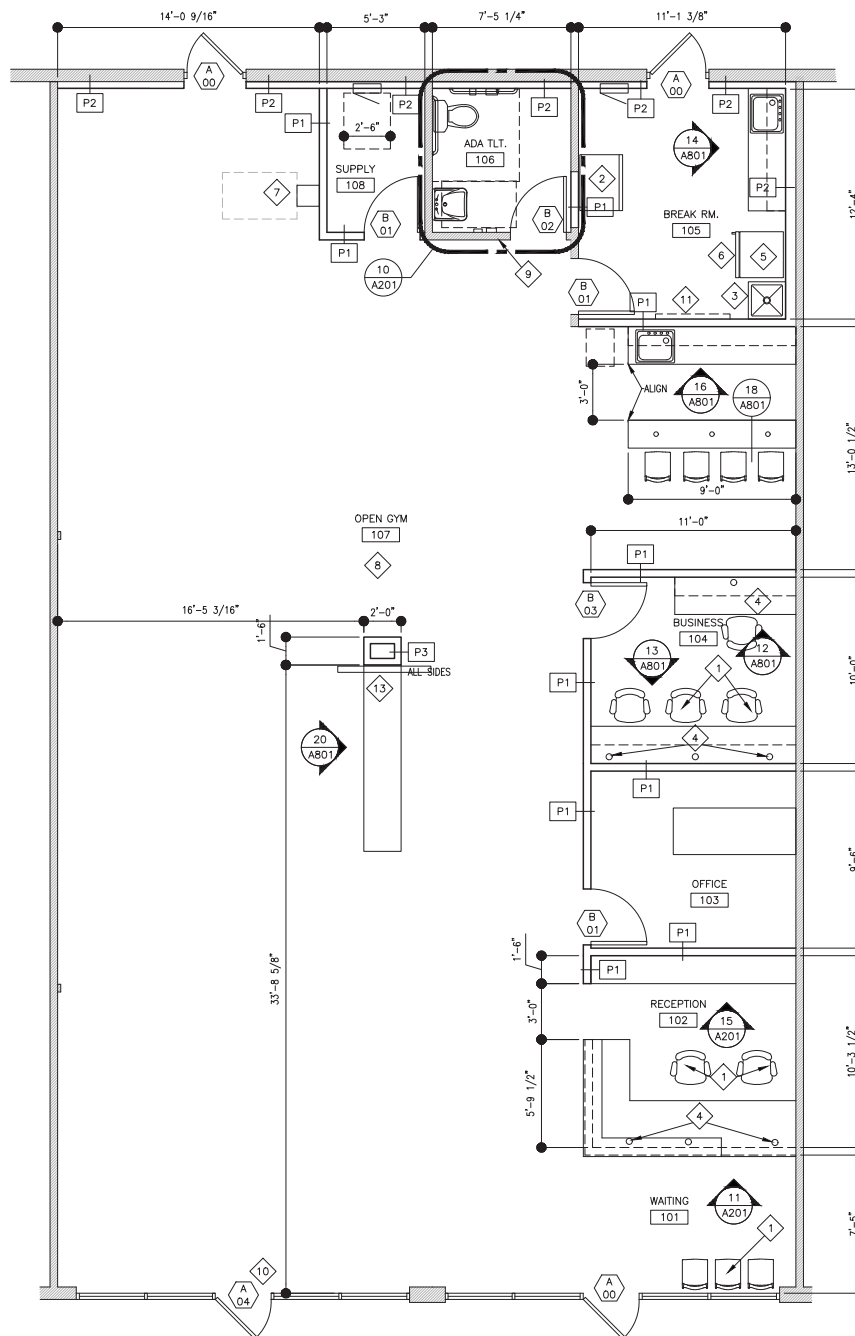

8

## FLOOR PLAN

SCALE: 1/4" = 1'-0"

## CONTACT US:

**Michael Roberts Jr., Esq.**

Vice President

Mobile: 314-363-6873

mroberts@gundakercommercial.com



**GUNDAKER**  
COMMERCIAL GROUP

55 Westport Plaza Drive, Ste. 200

St. Louis, MO 63146

M: 636-728-5100 | F: 636-728-5140

[gundakercommercial.com](http://gundakercommercial.com) [in](#) [@](#) [f](#)