

revisions:

CONSULTANTS:

Solver Structural Partnership, Inc.
 7500 N.W. 25th St.
 Miami, Florida 33122
 Phone: (305) 581-0841
 Fax: (305) 581-3472
 E-Mail: info@sspi.com
 DESIGN - INSPECTION - REPORTS

job name: **MIAMI AIRPORT CENTER**
7620 NW 25 ST
MIAMI, FL 33122

title: **GENERAL FLOOR PLAN BUILDING 7620**

date: _____

revised: _____

drawn: _____

checked: D.K.S.

project no.: _____

revisions: _____

sheet no.

GENERAL PLAN

BUILDING 7620

-Total common elements = 439 sf.
 (Includes area of demising partition walls)

-Total sellable area = 62,149 sf.
 (Includes only the interior area of units)

-% Common elements assigned = $\frac{\text{Area of common elements}}{\text{Sellable area}}$
 to each unit.

$$= \frac{439 \text{ sf}}{62,149 \text{ sf}} = 0.706 \%$$

Disclaimer:

- ① Tolerances of ± 1 sq. ft. per unit are expected.

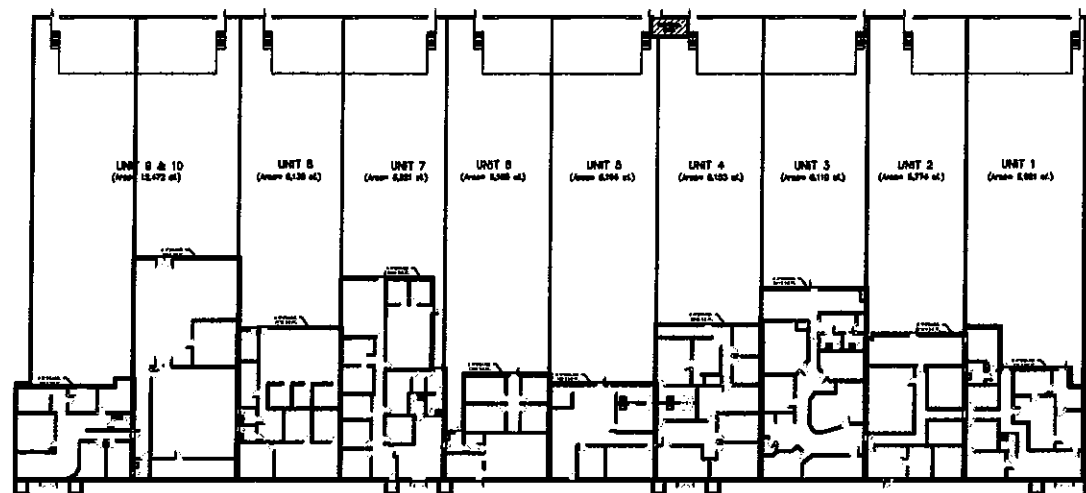

GENERAL FLOOR PLAN(BUILDING 7620)

SCALE: $\frac{1}{4}"=1'-0"$

LEGEND

- PARTITION WALL
 (4" PARTITION WALL PLUS 2 - 5/8" DRYWALL)
- DOOR
- WINDOW
- 8" MASONRY WALL
- UNOCCUPIED AREA.

NOTES:

- ① Area measurements were made from interior side of imaginary demising wall to interior side of other imaginary demising wall. For end space, area measurements were made from interior side of imaginary demising wall to interior side of masonry wall.
- ② For accurate information of each unit, see isolated unit layout.

Denis K. Solano
 P.E. 56902
 S.I. 2046