

# The Bristol at Southport

1083-1133 Lake Washington Blvd N, Renton, WA 98056

Prime Retail Opportunity:  
Waterfront Retail For Lease





## Welcome to The Bristol at Southport,

a modern, resort-style community in Renton, Washington. Join this waterfront, luxury community with 383 apartments between two buildings directly next to three Southport office campus buildings and the Hyatt Regency. Conveniently located near The Renton Landing, a high-end lifestyle and entertainment center, with easy access to I-405 to downtown Bellevue, I-90 corridor, 10 minutes to Sea-Tac International Airport, and less than 20 minutes from downtown Seattle. Prime opportunity for retailers to join this thoughtfully curated waterfront project.













# Demographics



## Population

1-Mile: 49,267  
2-Mile: 209,516  
5-Mile: 453,295



## Employees

1-Mile: 110,155  
2-Mile: 313,177  
5-Mile: 475,895



## Average Household Income

1-Mile: \$101,978  
2-Mile: \$135,623  
5-Mile: \$140,920



# Bristol I Site Plan

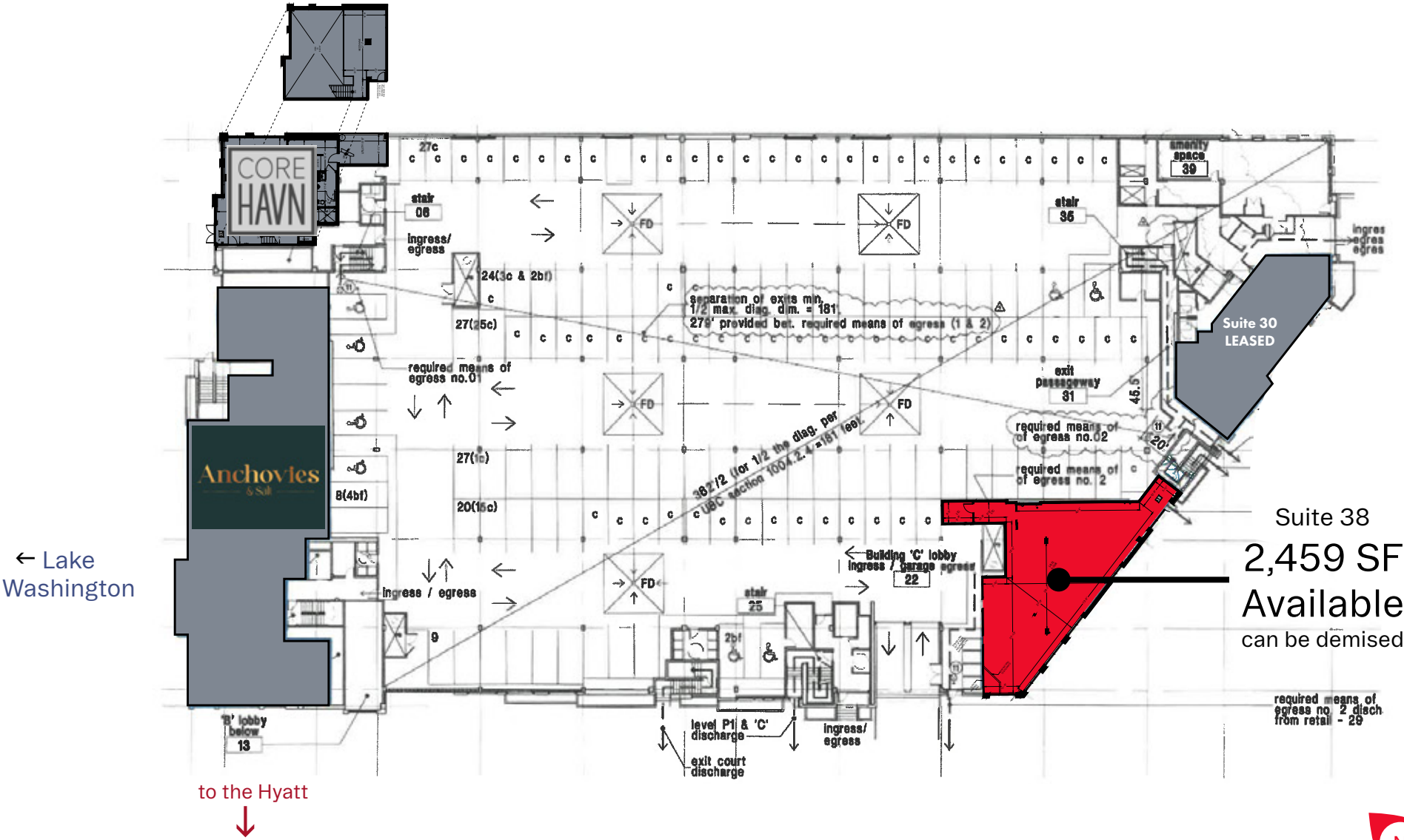



# Bristol II Site Plan

Suite 90  
4,084 SF  
Available  
can be demised

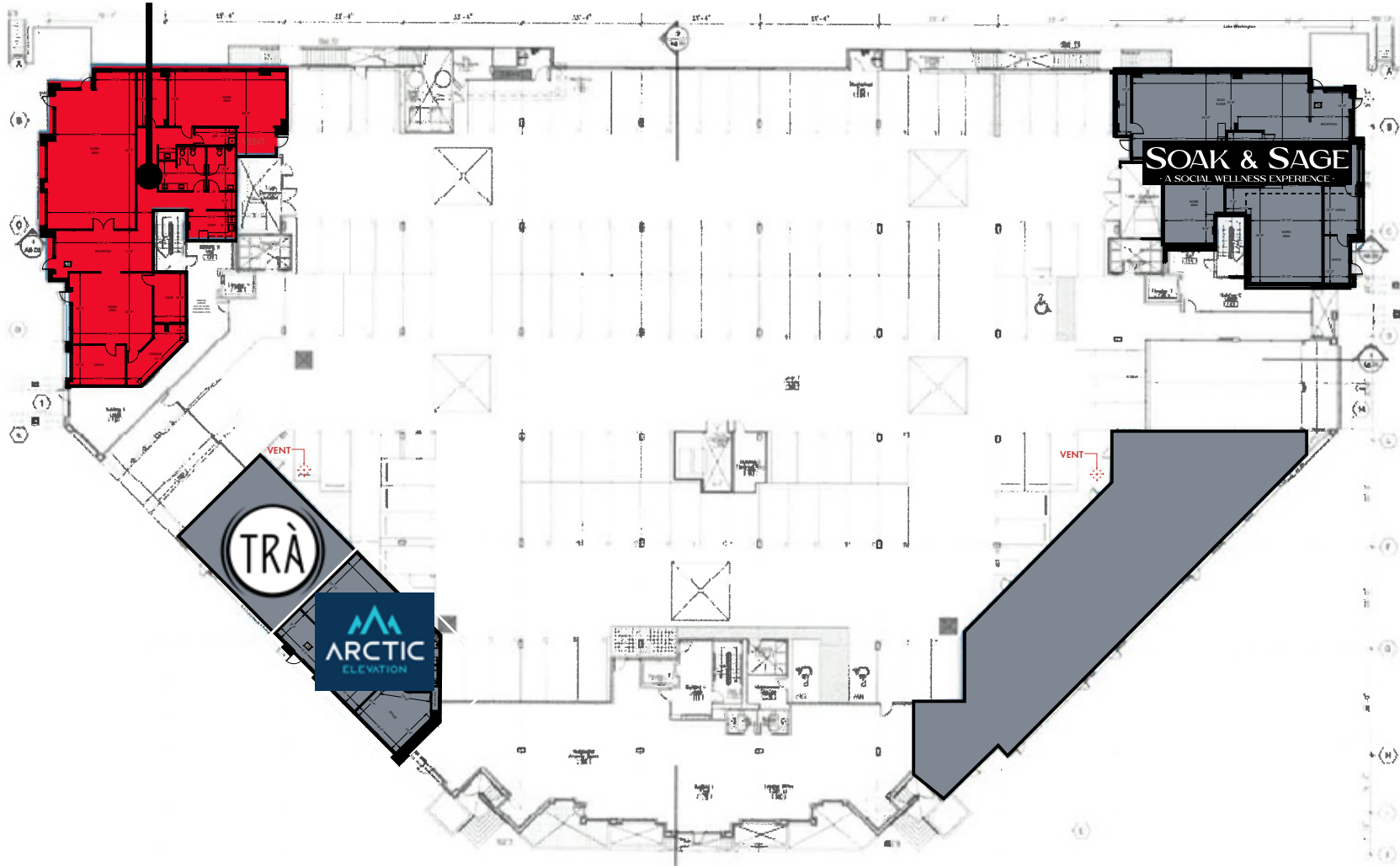

# The Bristol at Southport

1083-1133 Lake Washington Blvd N,  
Renton, WA 98056

**Tiffini Connell**

tiffini@wccommercialrealty.com  
206 854 1925

**Avery Connell**

avery@wccommercialrealty.com  
206 475 9637

DISCLAIMER: The above information has been secured from sources believed to be reliable, however, no representations are made to its accuracy. Prospective tenants or buyers should consult their professional advisors and conduct their own independent investigation. Site plan and configuration are subject to change. Properties are subject to change in price and/or availability without notice. West Coast Commercial Realty, LLC

MEMBER OF  
**SITE SOURCE**  
RETAIL BROKER NETWORK

CBA

ICSC

CoStar

**WCCR** | West Coast  
Commercial  
Realty

206 283 5212  
wccommercialrealty.com

