



**OFFICE FOR LEASE**  
*IMMEDIATE OCCUPANCY*

**1075 W. ENTRANCE DRIVE**

**AUBURN HILLS, MI**

For more information, contact:

**JOHN BOYD**

(248) 948 0102

[jboyd@signatureassociates.com](mailto:jboyd@signatureassociates.com)

**DAVE MILLER**

(248) 948 4183

[dmiller@signatureassociates.com](mailto:dmiller@signatureassociates.com)



**SIGNATURE  
ASSOCIATES**

KNOW SIGNATURE | KNOW RESULTS

Information is subject to verification and no liability for errors or omissions is assumed. Price is subject to change and listing withdrawal.



# PROPERTY SUMMARY



## OFFICE FOR LEASE

*RARE, FREESTANDING  
OFFICE/TECH BUILDING WITH  
FOUR FLOORS IN PRIME  
AUBURN HILLS LOCATION*

- 4,000 – 180,000 square feet available
- Will divide from 4,000 square feet – full floors available
- Available immediately
- Parking for 1,000+
- 3000 amps, 480 volts power
- Join FANUC, Comerica, VW, Oakland University and Oakland Community College
- Located on 14 acres
- Contact broker for lease rate



# INTERIOR SPACES







# FLOOR PLANS

FIRST FLOOR

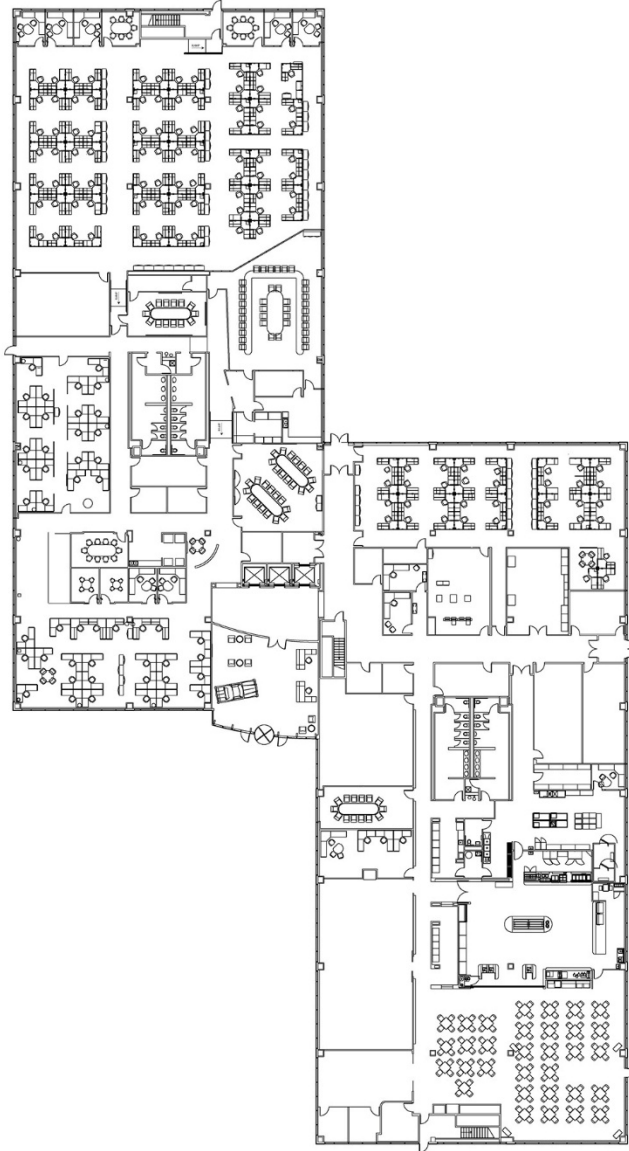

SECOND FLOOR

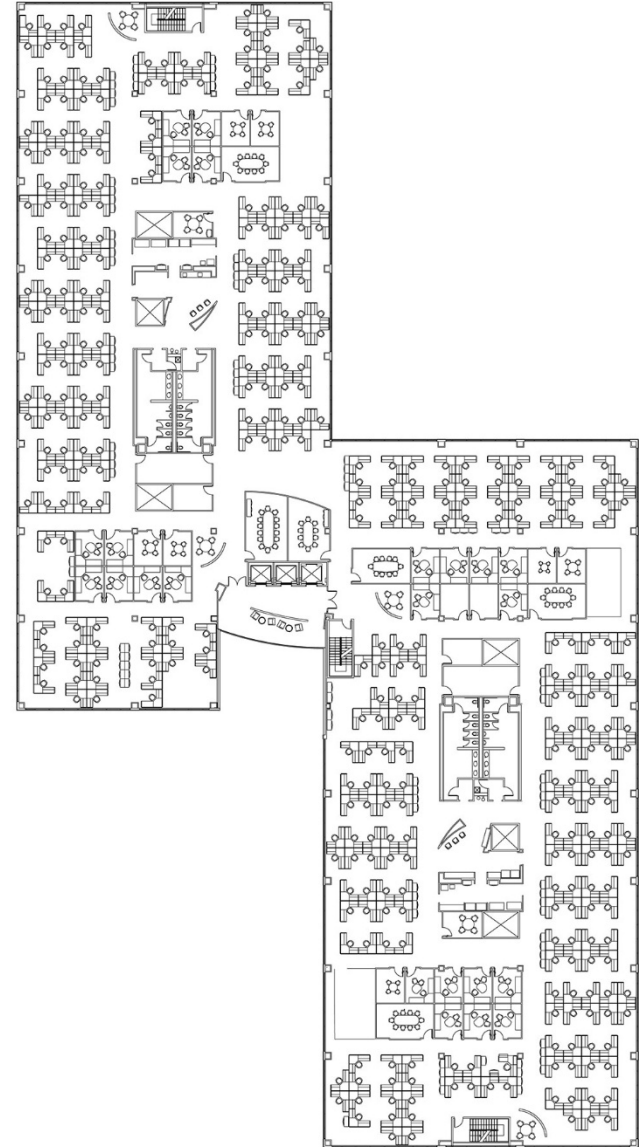



# FLOOR PLANS

THIRD FLOOR

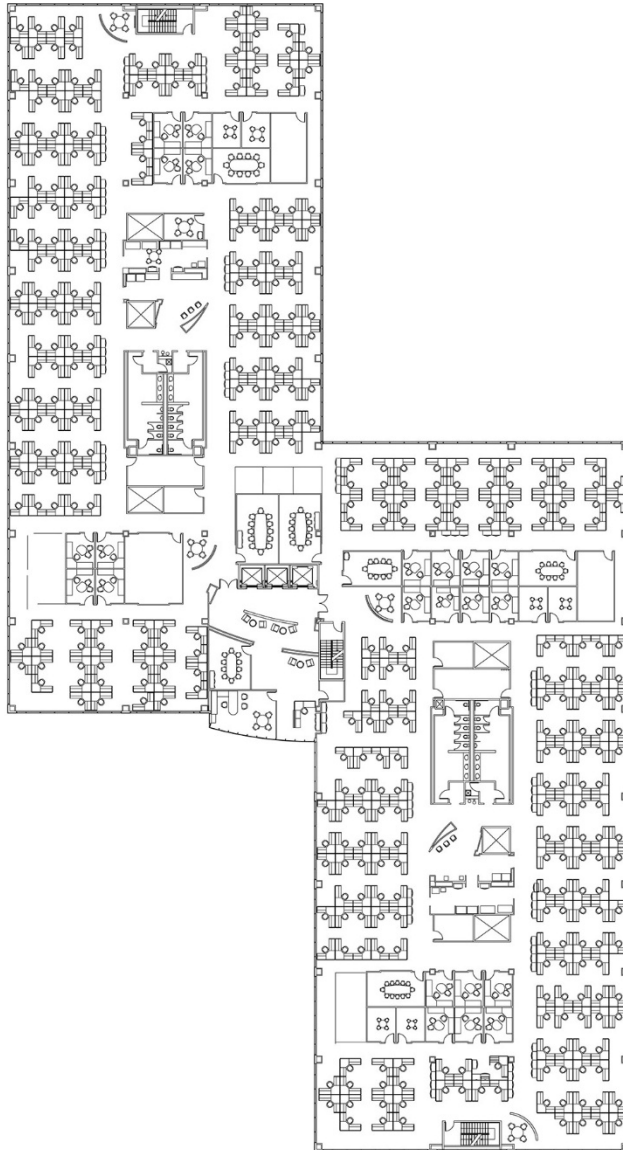

FOURTH FLOOR

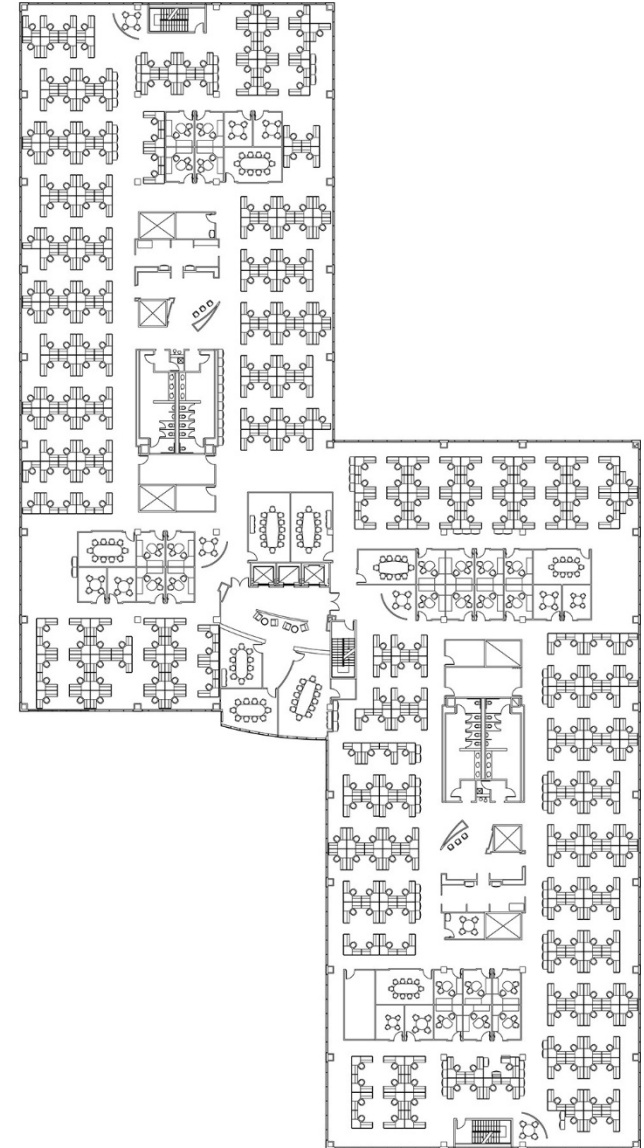



# AERIAL VIEW





# AREA MAP

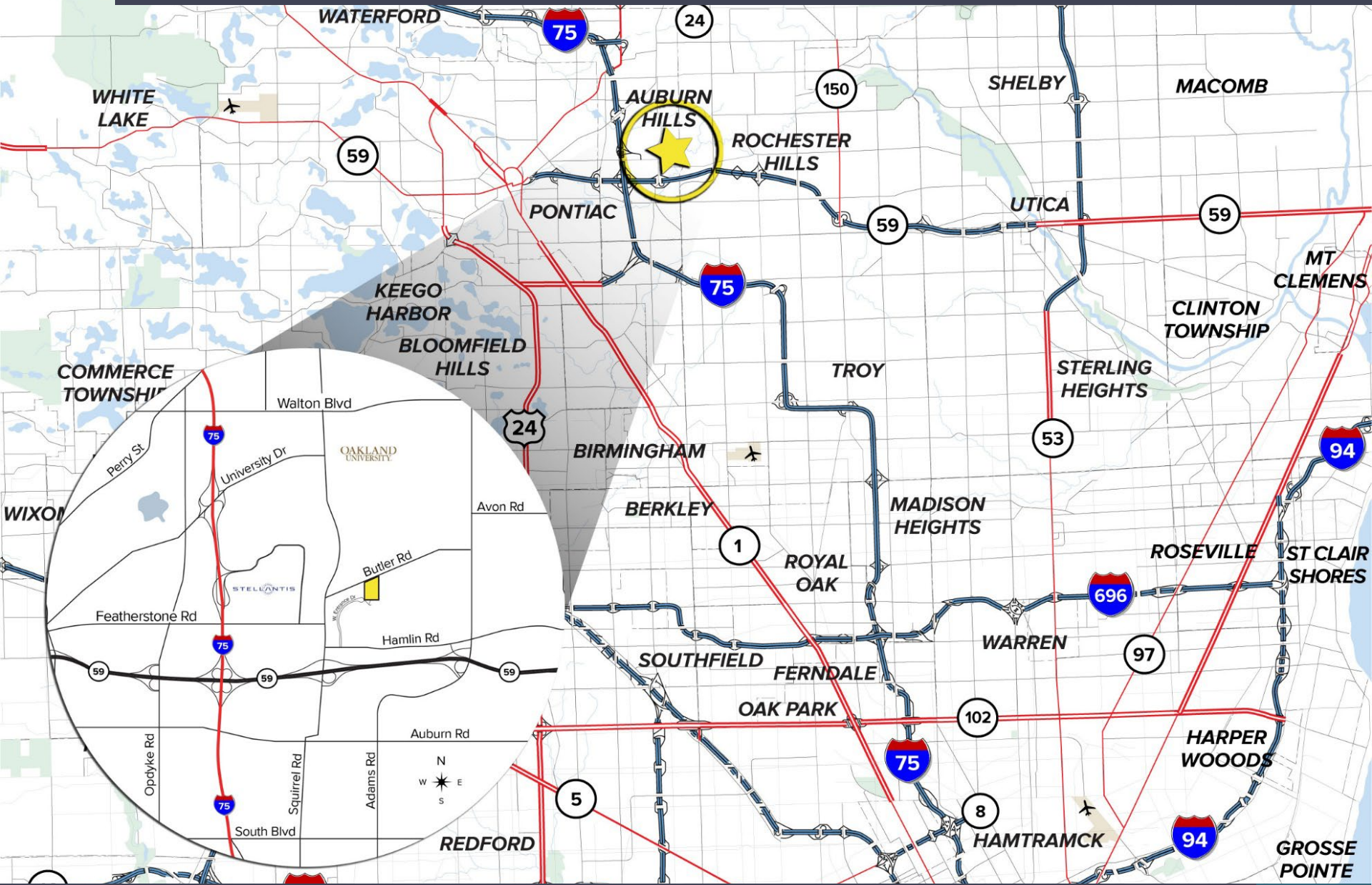

For more information, contact:

**JOHN BOYD**

(248) 948 0102

[jboyd@signatureassociates.com](mailto:jboyd@signatureassociates.com)

**DAVE MILLER**

(248) 948 4183

[dmiller@signatureassociates.com](mailto:dmiller@signatureassociates.com)

BROKERAGE SERVICES

TENANT REPRESENTATION

INVESTMENT SALES

BUSINESS SALES

VALUATION

ADVISORY SERVICES

PROPERTY/ASSET MANAGEMENT

CONSULTING

MARKET RESEARCH

MARKETING

**SIGNATURE ASSOCIATES**

One Towne Square, Suite 1200

Southfield, Michigan 48076

(248) 948 9000

[www.signatureassociates.com](http://www.signatureassociates.com)

Information is subject to verification and no liability for errors or omissions is assumed. Price is subject to change and listing withdrawal.

