

LAKEVIEW SHOPPING CENTER

2213 – 2333 US 19 (34th St S) | St Petersburg, FL 33711

PROPERTY HIGHLIGHTS:

- Outparcel Available for Ground Lease
- Highly-visible center on the corner of US 19 (34th St S) and 22nd Ave S
- Easy ingress/egress at lighted intersection with immediate access to I-275
- Demographics include a population of over 229,000 with an average household income of more than \$115,000 within a 5-mile radius
- Shopping center total GLA: 56,227 SF (MOL)



KEY DEMOS	1 MILE	3 MILES	5 MILES
POPULATION			
2024 Estimated Population	12,174	111,144	229,807
2024 Estimated Households	4,983	51,873	110,718
INCOME			
2024 Estimated Avg HH Income	\$79,590	\$101,603	\$115,956
AGE			
Median Age	37	42	45
DAYTIME DEMOS			
Number of Businesses	472	6,838	15,790
Number of Employees	3,049	48,567	103,745
Total Daytime Population	7,026	86,749	183,246
TRAFFIC COUNTS			
34th Street S (US 19) (N/S)	28,000 AADT		
22nd Ave S (E/W)	16,500 AADT		
I-275 (N/S)	103,000 AADT		



FOR LEASING INFORMATION:

Erica Nelson
813.712.3055
enelson@rmcpg.com

8902 N Dale Mabry Hwy
Tampa, FL 33614
800.728.5379
www.RMCPG.com

LAKEVIEW SHOPPING CENTER

2213 – 2333 US 19 (34th St S) | St Petersburg, FL 33711

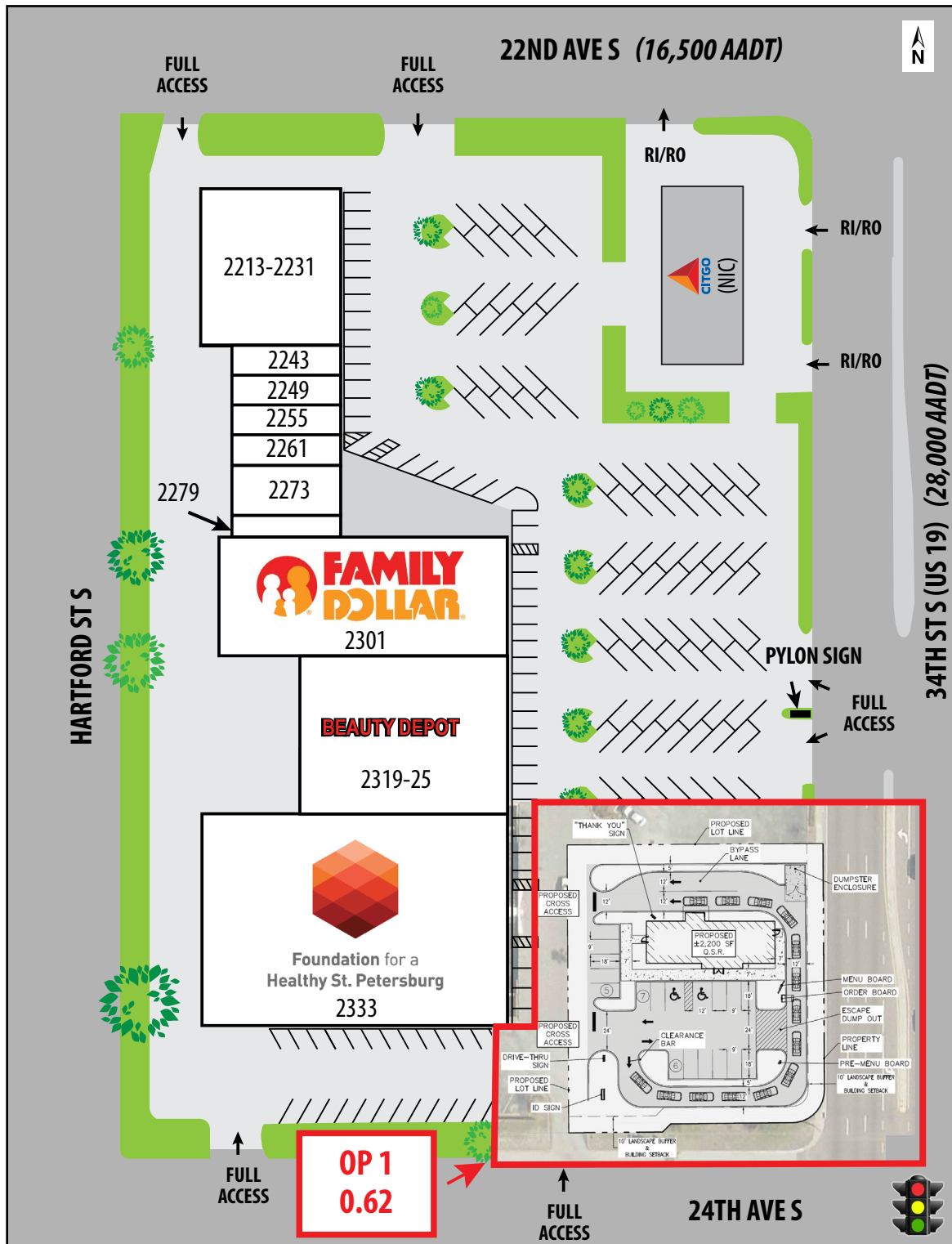

All information given herein is obtained from sources considered reliable. However, we are not responsible for misstatement of facts, errors, omissions, prior sale, withdrawal from market, modification of mortgage commitment, terms and considerations, or change in price without notice. The information supplied herein is for informational purposes only and shall not contain a warranty or assurance that said information is correct. Any person intending to rely upon the information supplied herein should verify said information independently. UPDATED: 040825



FOR LEASING INFORMATION:

Erica Nelson
813.712.3055
enelson@rmcpg.com

8902 N Dale Mabry Hwy
Tampa, FL 33614
800.728.5379
www.RMCPG.com