

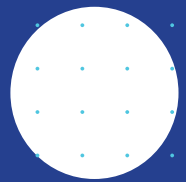

For Lease

Warehouse/Manufacturing

±108,893 SF Available



ARDEN | GROUP

CBRE

60 Maple Street
Mansfield, Massachusetts

Building Specifications

Total Building	±227,166 SF
Available SF	±108,893 SF SUITE A : ±68,970 SF (Vacant) SUITE B : ±39,923 SF (Available 7/1/2025), Mezzanine: ±7,200 SF
Land	±15.90 acres
Clear Height	SUITE A : 16'8" - 21'6" SUITE B : 16'8"
Column Spacing	40' x 40'
Loading Docks	SUITE A : Five (5) tailboard loading docks, One (1) drive-in door SUITE B : One (1) tailboard loading dock, One (1) drive-in door Ability to add additional loading docks
Sprinklers	100% wet system
Year Built	1968 (renovated in 1999/2014/2015)
Parking	±0.88/1,000 SF (200 automobile spaces plus truck court)
Roof	Rubber EPDM
Zoning	Industrial
Lighting	LED
Power	Suite A: 1,000 amps
Heating	Gas-fired radiant heat and rooftop units
Utilities	Gas: Columbia Gas Electric: Mansfield Municipal Electric Department Water/Sewer: Town of Mansfield



6
Loading Docks



3 Miles
From I-95



Outdoor Storage
Available

Site Plan

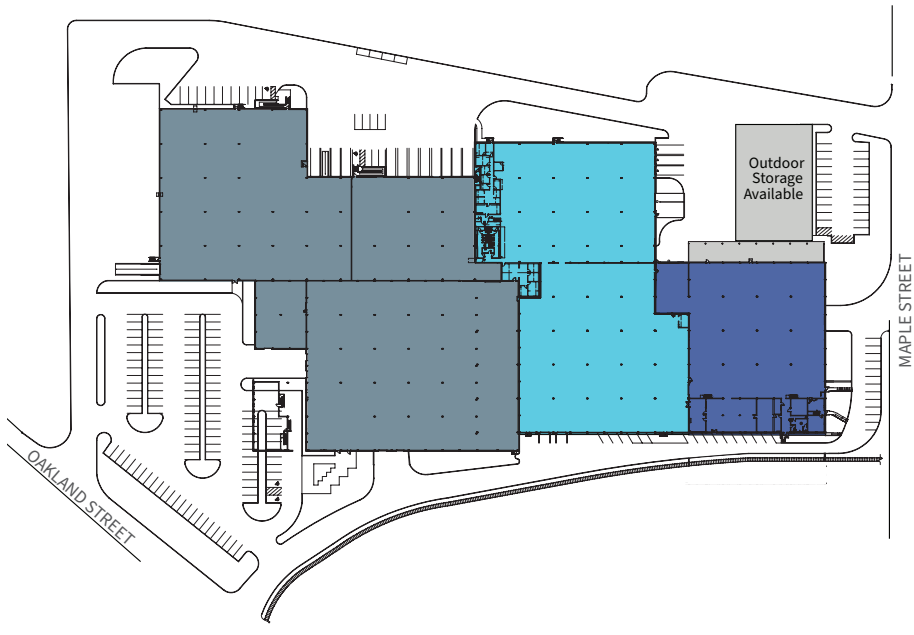

Floor Plan

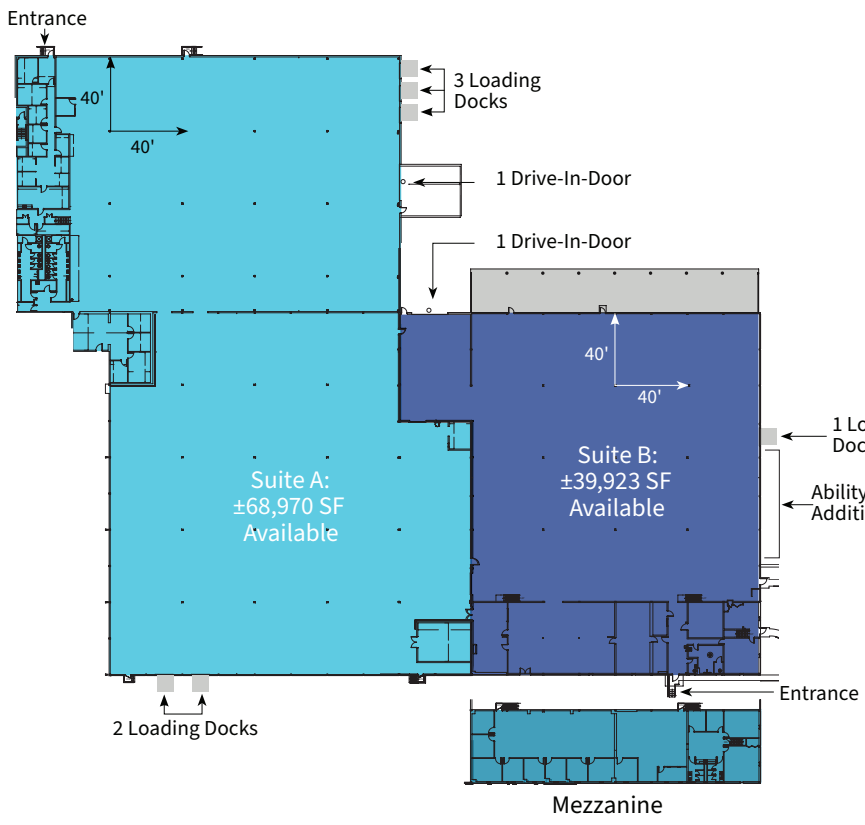

- Suite A:**
 ±68,970 SF
- Suite B:**
 ±32,723 SF
- Mezzanine: ±7,200 SF



Commercial Rail Line & Providence
Stoughton Commuter Rail Line

60 Maple Street

TigheLogistics
GROUP

CAR-O-LINER

AMERISTAR
ASSA ABLOY
VIKING

dgs
retail
Clopay

**FUTURE
FOAM**

**NATIONAL
Lumber**
Builders FirstSource

**KITCHEN
VIEWS**

ADVANCED WAREHOUSES, INC.
Public Warehousing and Distribution Experts

BASS RESORT SALES CORP.

Michael J Connolly & Sons







BIO MANSFIELD INCUBATOR **SHEEHAN PERSONAL TRAINING**
PERSONAL TRAINING
Strength Endurance Nutrition

DOORSCAPES, INC.

MINI WAREHOUSING, INC. **INTRANSIT CONTAINER**

VAM REALTY TRUST

PRECISION BIOSCIENCES **FLM**

TRAVEL DISTANCES		
	Mansfield Commuter Rail Station	1.1 Miles
	Route 140	1.7 Miles
	I-95	2.7 Miles
	I-495	2.8 Miles
	Providence, RI	21.1 Miles
	Boston, MA	25.5 Miles

2.0 MILES TO CABOT BUSINESS PARK

Contacts

Chris Mullen
Senior Vice President
+1 781 801 4432
chris.mullen2@cbre.com

Kendall Lynch
Vice President
+1 781 812 6435
kendall.lynch@cbre.com

Caroline Munn
Senior Associate
+1 516 851 6261
caroline.munn@cbre.com

ARDEN | GROUP

CBRE

© 2024 CBRE, Inc. All rights reserved. This information has been obtained from sources believed reliable, but has not been verified for accuracy or completeness. You should conduct a careful, independent investigation of the property and verify all information. Any reliance on this information is solely at your own risk. CBRE and the CBRE logo are service marks of CBRE, Inc. All other marks displayed on this document are the property of their respective owners, and the use of such logos does not imply any affiliation with or endorsement of CBRE. Photos herein are the property of their respective owners. Use of these images without the express written consent of the owner is prohibited.