

AVAILABILITY

Voit

REAL ESTATE SERVICES

421 Commercial Way | La Habra, CA 90631

421 Commercial Way

Address	Suite	Total Size ¹ Sq. Ft.	Office Size ¹ Sq. Ft.	Asking Rate Per Month Mod. Gross	Comments
421 Commercial Way	C,D	4,100	±500	\$1.29 PSF \$5,289.00 per mo.	Reception, 2 private offices, restrooms, and large warehouse with 2 ground level loading doors.

¹Approximate total square footage

HAYDEN SOCCI, CCIM

Senior Vice President | Partner

714.935.2379

hsocci@voitco.com

Lic #01705038

2400 East Katella Avenue | Suite 750 | Anaheim, CA 92806 | 714.978.7880 | 714.978.9431 FAX | Lic #01991785 | www.voitco.com

FOR LEASE

421 Commercial Way | La Habra, CA 90631

Voit

REAL ESTATE SERVICES



PROJECT FEATURES

- ±1,300 - 5,400 Sq. Ft.
- Multi-Tenant Units
- Separately Metered
- 20' Foot Warehouse Clearance (rare)
- Ground Level Loading
- Bonus Mezzanine
- Multiple Restrooms (plumbing stubbed for additional restrooms)
- Pride of Ownership Property

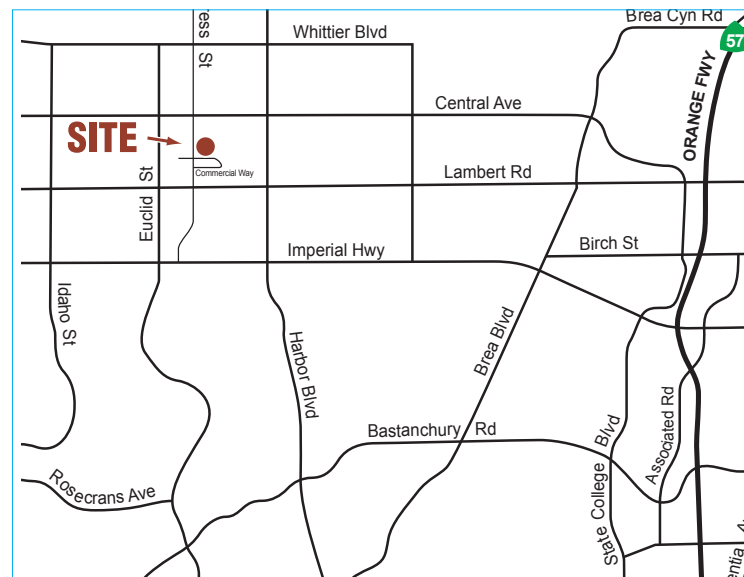

HAYDEN SOCCI, CCIM

Senior Vice President | Partner

714.935.2379

hsocci@voitco.com

Lic #01705038

2400 East Katella Avenue | Suite 750 | Anaheim, CA 92806 | 714.978.7880 | 714.978.9431 FAX | Lic #01991785 | www.voitco.com

AVAILABILITY

Voit

REAL ESTATE SERVICES

421 Commercial Way | La Habra, CA 90631
Suite C,D | 4,100 Sq. Ft.

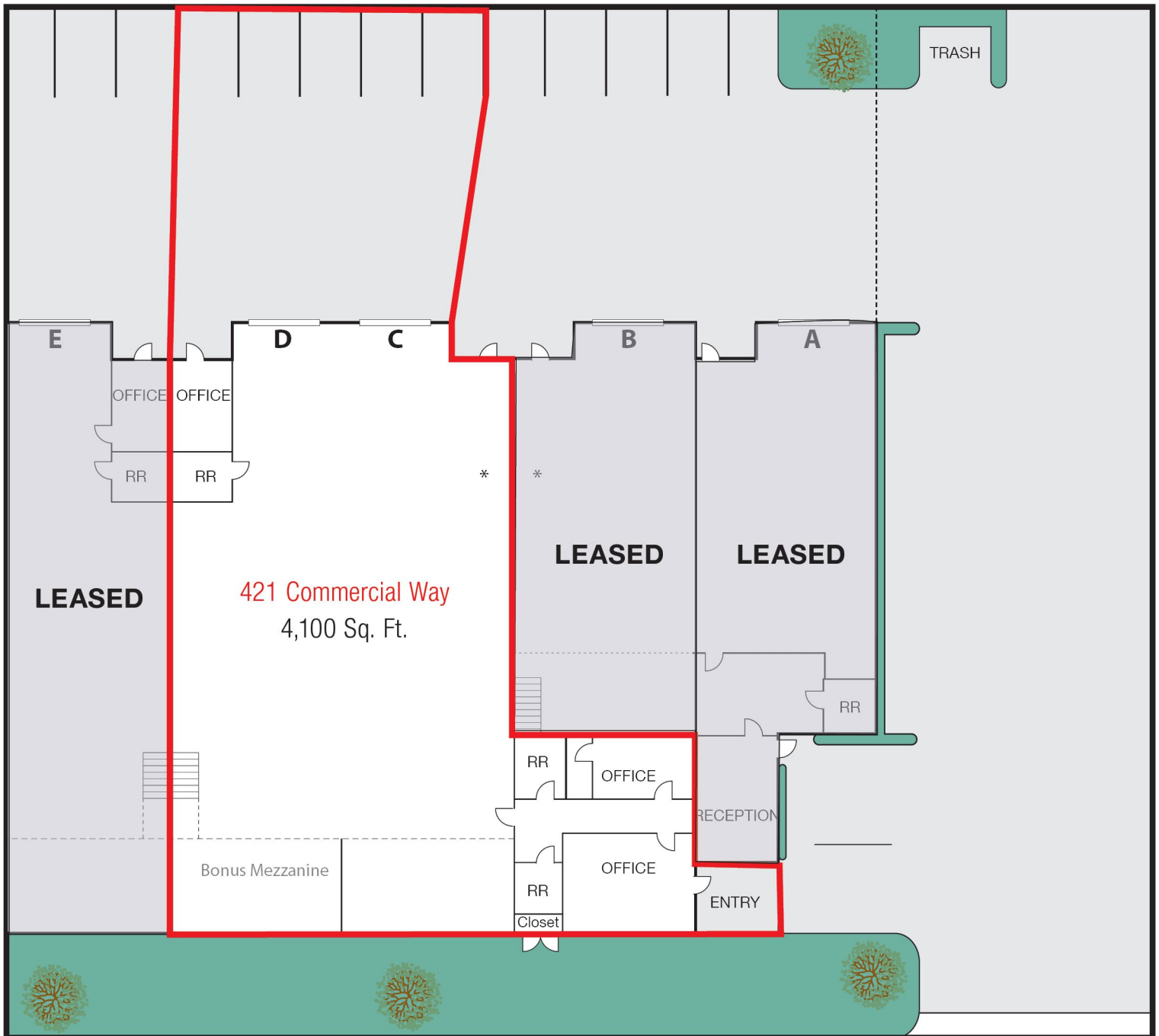

Please note floor plan not to scale.

* Plumbing in place for restroom

HAYDEN SOCCI, CCIM

Senior Vice President | Partner

714.935.2379

hsocci@voitco.com

Lic #01705038

2400 East Katella Avenue | Suite 750 | Anaheim, CA 92806 | 714.978.7880 | 714.978.9431 FAX | Lic #01991785 | www.voitco.com