



841 WOBURN ST

WILMINGTON, MA

FOR LEASE | 28,800 SF +/- INDUSTRIAL BUILDING ON 2.75 AC

- 1.5 Miles to Route 93
- 3.2 Miles to Route 95
- 0.9 Miles to Route 38



THE
STUBBLEBINE
COMPANY

CORFAC INTERNATIONAL

PROPERTY SUMMARY



PROPERTY DESCRIPTION

28,800 SF +/- Industrial Building on 2.75 AC for Lease

PROPERTY HIGHLIGHTS

- 1.5 Miles to Route 93
- 3.2 Miles to Route 95
- 0.9 Miles to Route 38

PROPERTY SPECIFICATIONS

Building Size:	28,800 SF
Lot Size:	2.75 AC
Ceiling Height:	16'
Zoning:	Industrial
Sprinklers:	Wet System
Lighting:	New LED Lights
Electric:	800 Amp / 480Y/277 V 3 Phase, 4 Wire
Column Spacing:	40' x 40'
Water/Sewer:	Municipal System
HVAC:	100% Forced Air
Lease Rate:	Market

DEMOGRAPHICS	3 MILES	5 MILES	10 MILES
Total Households	25,602	71,173	368,247
Total Population	67,879	185,952	953,813
Average HH Income	\$183,086	\$176,623	\$169,900





SITE PLAN

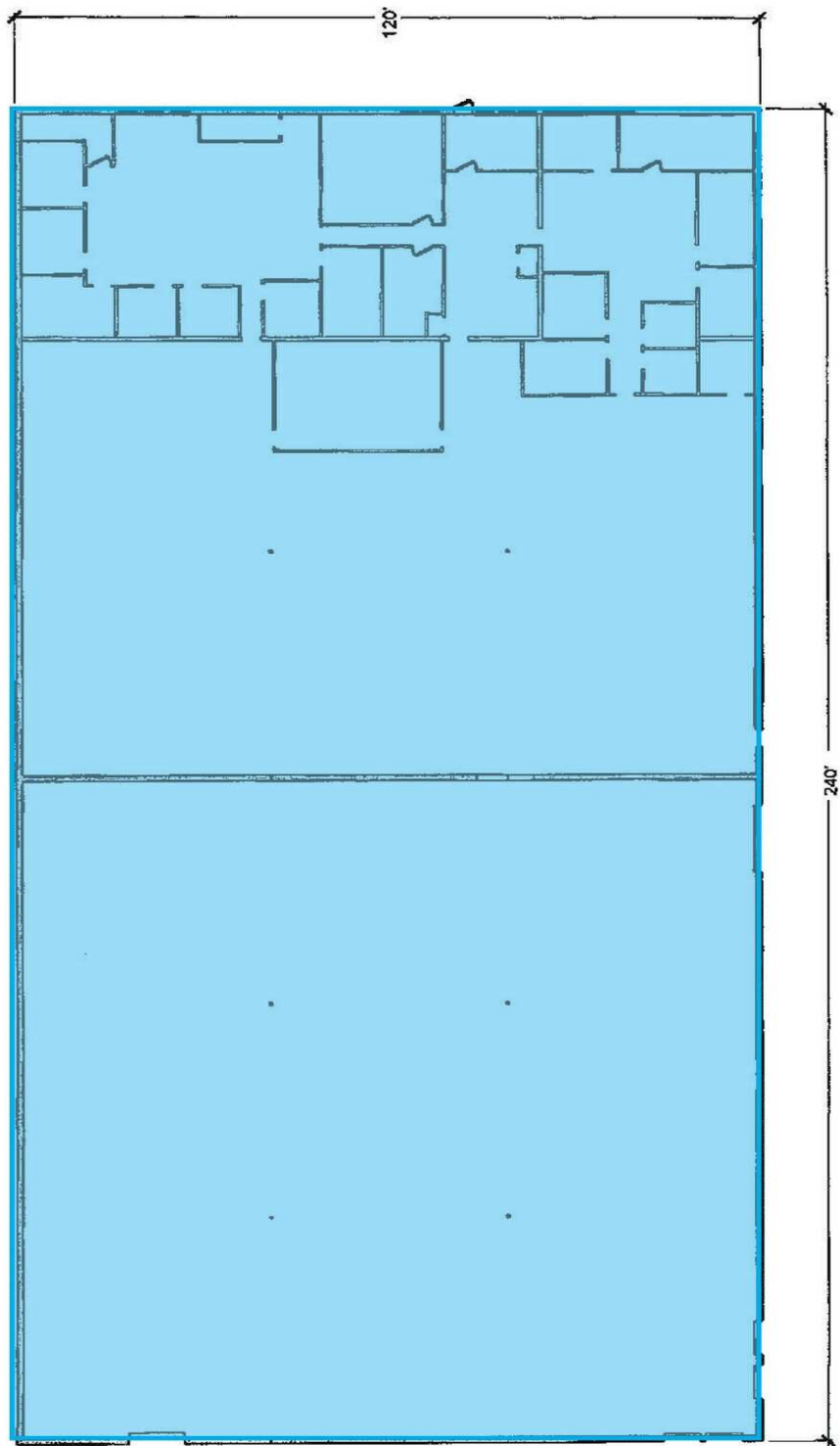

DISTANCE TO



1.5 MILES
4 MIN



3.2 MILES
8 MIN

WILMINGTON

amazonrobotics



TERADYNE



Milton CAT

FERGUSON

841 Woburn St. Wilmington, MA



BAY CRANE



BURLINGTON



STANDARD ELECTRIC



PEAK
EVENT SERVICES

Kirkwood



STONEHAM

3

BOSTON



841 Woburn St. Wilmington, MA



841 WOBURN ST

WILMINGTON, MA

FOR LEASE | 28,800 SF +/- INDUSTRIAL BUILDING ON 2.75 AC

MICAH STUBBLEBINE

978.265.8101

micah@stubblebinecompany.com

JAMES STUBBLEBINE

617.592.3388

james@stubblebinecompany.com

DAVID STUBBLEBINE

617.592.3391

david@stubblebinecompany.com

We obtained the information above from sources we believe to be reliable. However, we have not verified its accuracy and make no guarantee, warranty or representation about it. It is submitted subject to the possibility of errors, omissions, change of price, rental or other conditions, prior sale, lease or financing, or withdrawal without notice. We include projections, opinions, assumptions or estimates for example only, and they may not represent current or future performance of the property. You and your tax and legal advisors should conduct your own investigation of the property and transaction.



THE
STUBBLEBINE
COMPANY

CORFAC INTERNATIONAL