

1200033000006

11/17/2025



**J. Craig Snodgrass CPA,  
CGFM**  
**County Auditor**  
**Lorain County, Ohio**  
**loraincountyauditor.gov**

Parcel

1200033000006

111 - CASH-GRAIN GEN FARM - ...

Owner

WOLF DAMON

SOLD: 9/24/2021 \$390,000.00

Address

17500 EAST RIVER RD COLUMBIA STATION OH 44028

COLUMBIA TWP

Appraised

\$466,720.00

ACRES: 13.5700

## Sketches

Sketch 1

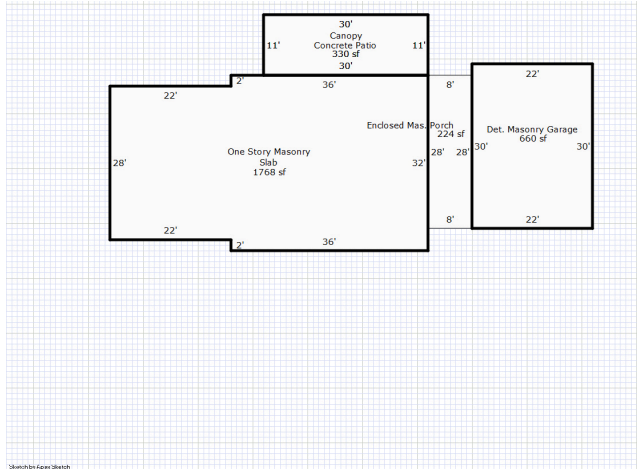

Sketch 2

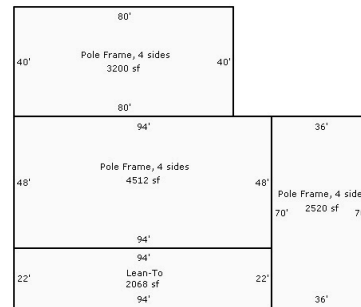

## Special Notices

None at this time.

## Location

Parcel	1200033000006
Owner	WOLF DAMON
Address	17500 EAST RIVER RD COLUMBIA STATION OH 44028
City / Township	COLUMBIA TWP
School District	COLUMBIA LSD
Neighborhood	13015 - COLUMBIA TWP S/COLUMBIA LSD
Tax District	25

## Deeded Owner Address

Owner Name	WOLF DAMON
Owner Address	17500 EAST RIVER RD
City, State, Zip	COLUMBIA STATION OH 44028

## Tax Payer Address

Mailing Name	WOLF DAMON
Mailing Address	17500 EAST RIVER RD

City, State, Zip	COLUMBIA STATION OH 44028
------------------	---------------------------

Valuation

Appraised (100%)				Assessed (35%)		
Year	Land (CAUV)	Improvements	Total	Land (CAUV)	Improvements	Total
2024	\$241,890.00	\$224,830.00	\$466,720.00	\$84,660.00	\$78,690.00	\$163,350.00
2023	\$133,260.00	\$196,220.00	\$329,480.00	\$46,640.00	\$68,680.00	\$115,320.00
2022	\$133,260.00	\$196,220.00	\$329,480.00	\$46,640.00	\$68,680.00	\$115,320.00
2021	\$133,260.00 (\$79,290.00 🏠)	\$196,220.00	\$329,480.00	\$46,640.00 (\$27,750.00 🏠)	\$68,680.00	\$96,430.00
2020	\$133,260.00 (\$81,340.00 🏠)	\$196,220.00	\$329,480.00	\$46,640.00 (\$28,470.00 🏠)	\$68,680.00	\$97,150.00
2019	\$133,260.00 (\$81,340.00 🏠)	\$196,220.00	\$329,480.00	\$46,640.00 (\$28,470.00 🏠)	\$68,680.00	\$97,150.00

Historic Appraised (100%) Values

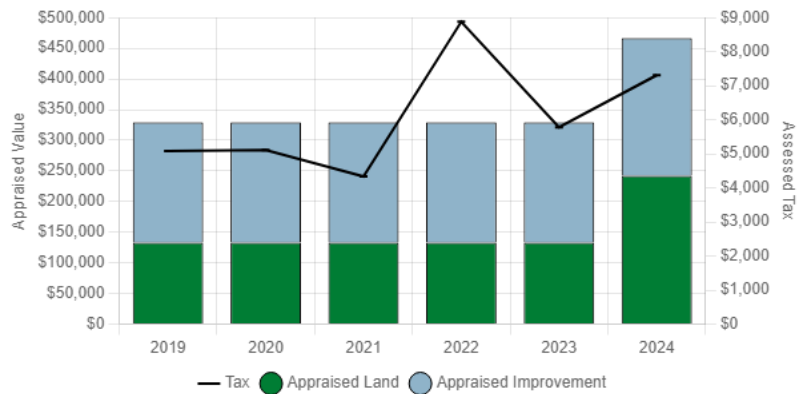

Current Abatements And/Or Exemptions

No Abatement or Exemption Record Found.

Legal

Homestead	False	Owner Occupied Credit	True
-----------	-------	-----------------------	------

Description

""

Dwellings

Dwelling ID	Year Built	Finished SQFT	Total Rooms	Bedrooms	Full Bathrooms	Half Bathrooms	Fireplace	Central AC
2318023	1959	1768	6	3	2	0	Y	N

Improvements

Associated Dwelling ID	Group	Label	Type	Size
2179663	PORCHES	Porches	Enclosed Masonry Porch	224 sqft

#### Agricultural

No Agricultural Records Found.

#### Sales

Date	Buyer	Seller	Instrument Number	Document Number	Valid	Parcels In Sale	Amount
9/24/2021	WOLF DAMON	SOUTH DENISE ANNE	0	2021006456	True	1	\$390,000.00
7/15/2021	FUNK SUSAN	BROWN BETTY	0	2021092793	False	1	\$0.00
7/15/2021	SOUTH DENISE ANNE	FUNK SUSAN	0	2021092794	False	1	\$0.00

#### Images

The Lorain County Auditor is in the midst of an appraisal software conversion that is preventing the displaying of imaged documents. Imaged documents will be accessible in early 2026. If you need a copy of a specific conveyance form please contact the Auditor's Office by phone or email.

No Image Records Found.

#### Tax

2024 Payable 2025

	Year Total
Gross Tax	\$13,570.30
Reduction	-\$5,740.26
Effective Tax	\$7,830.04
Non-Business Credit	-\$640.36
Owner Occupancy Credit	-\$84.60
Homestead Reduction	\$0.00
Net General	\$7,105.08
Net Special Assessment	\$206.01
Taxes Billed	\$7,311.09
Penalties and Delinquencies	\$0.00
Balance	\$7,311.09
Payments & Adjustments	-\$7,311.09
Owed	\$0.00

## Yearly Tax Value Summary

Year	Effective Tax	Net General	Taxes Billed
2024	\$7,830.04	\$7,105.08	\$7,311.09
2023	\$6,335.16	\$5,738.56	\$5,785.07
2022	\$6,223.50	\$8,832.60	\$8,877.76
2021	\$5,256.06	\$4,294.64	\$4,338.48
2020	\$5,898.10	\$4,825.42	\$5,111.38
2019	\$5,872.82	\$4,798.64	\$5,081.97

### Tax Payments

Payment Date	Cycle	Prior Paid	First Half Paid	Second Half Paid	Surplus Paid
7/9/2025	2-2024	\$0.00	\$0.00	\$3,655.54	\$0.00
2/11/2025	1-2024	\$0.00	\$3,655.55	\$0.00	\$0.00
7/9/2024	2-2023	\$0.00	\$0.00	\$2,892.53	\$0.00
2/2/2024	1-2023	\$0.00	\$2,892.54	\$0.00	\$0.00
7/7/2023	2-2022	\$0.00	\$0.00	\$4,438.87	\$0.00
2/10/2023	1-2022	\$0.00	\$4,438.89	\$0.00	\$0.00
7/8/2022	2-2021	\$0.00	\$0.00	\$2,169.24	\$0.00
2/9/2022	1-2021	\$0.00	\$2,169.24	\$0.00	\$0.00
7/9/2021	1-2020	\$0.00	\$2,677.40	\$2,433.98	\$0.00
11/10/2020	2-2019	\$0.00	\$0.00	\$242.00	\$0.00
7/30/2020	2-2019	\$0.00	\$0.00	\$2,419.98	\$0.00
2/10/2020	1-2019	\$0.00	\$2,419.99	\$0.00	\$0.00

### Tax Distributions

2024

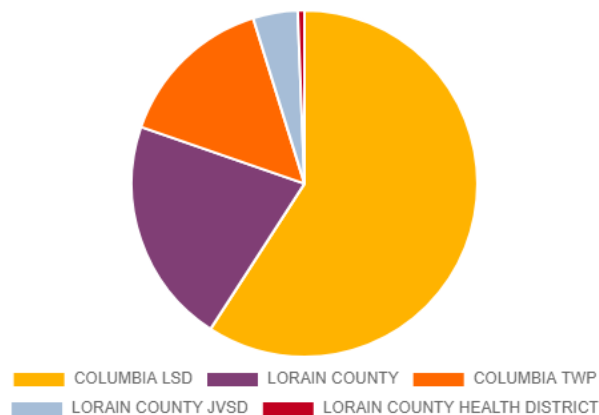

Tax Unit Name	Levy Name	Amount	Percentage
LORAIN COUNTY	GENERAL FUND	\$177.87	2.50%
LORAIN COUNTY	DEVELOPMENTALLY DISABLED (2013)	\$144.57	2.03%
LORAIN COUNTY	COMMUNITY COLLEGE (2010)	\$154.25	2.17%
LORAIN COUNTY	CHILDREN SERVICES (2010)	\$128.54	1.81%
LORAIN COUNTY	MENTAL HEALTH (2005)	\$102.83	1.45%
LORAIN COUNTY	ANTIDRUG LAB UNIT (1977)	\$5.92	0.08%
LORAIN COUNTY	DEBT SERVICE	\$59.29	0.83%
LORAIN COUNTY	911 EMERGENCY SYSTEM (2013)	\$42.85	0.60%
LORAIN COUNTY	COMMUNITY COLLEGE (2004)	\$128.54	1.81%
LORAIN COUNTY	DEVELOPMENTALLY DISABLED (2001)	\$140.62	1.98%
LORAIN COUNTY	MENTAL HEALTH (2003)	\$47.52	0.67%
LORAIN COUNTY	COMMUNITY COLLEGE (2013)	\$51.42	0.72%
LORAIN COUNTY	CRIMINAL JUSTICE SERVICES (2013)	\$6.86	0.10%
LORAIN COUNTY	CHILDREN SERVICES (2015)	\$25.73	0.36%
LORAIN COUNTY	COMMUNITY COLLEGE (2020)	\$48.53	0.68%
LORAIN COUNTY	9-1-1 EMERGENCY SYSTEM (2023)	\$56.40	0.79%
LORAIN COUNTY	METRO PARK (2024)	\$181.13	2.55%
COLUMBIA LSD	GENERAL FUND	\$755.95	10.64%
COLUMBIA LSD	CURRENT EXPENSE (1976)	\$1,475.00	20.76%
COLUMBIA LSD	CURRENT EXPENSE (1980)	\$239.04	3.36%
COLUMBIA LSD	PERMANENT IMPROVEMENT (2010)	\$169.65	2.39%
COLUMBIA LSD	BOND (\$6,000,000) (2011)	\$140.07	1.97%
COLUMBIA LSD	CURRENT EXPENSE (2013)	\$494.53	6.96%
COLUMBIA LSD	SUBSTITUTE (R.C. 5705.199) (2013)	\$928.34	13.07%
LORAIN COUNTY JVSD	CURRENT EXPENSE (1976)	\$205.47	2.89%
LORAIN COUNTY JVSD	CURRENT EXPENSES (1997)	\$90.98	1.28%
COLUMBIA TWP	GENERAL FUND	\$115.62	1.63%
COLUMBIA TWP	ROAD AND BRIDGE	\$284.59	4.01%
COLUMBIA TWP	HOSPITAL (1976)	\$12.02	0.17%
COLUMBIA TWP	CEMETERY	\$14.82	0.21%
COLUMBIA TWP	ROAD IMPROVEMENT (2011)	\$87.42	1.23%
COLUMBIA TWP	LIBRARY (2010)	\$152.12	2.14%
Totals		\$7,105.08	100%

Tax Unit Name	Levy Name	Amount	Percentage
COLUMBIA TWP	FIRE & E.M.S (2020)	\$105.23	1.48%
COLUMBIA TWP	FIRE & E.M.S (2023)	\$286.84	4.04%
LORAIN COUNTY HEALTH DISTRICT	CURRENT EXPENSE (2017)	\$44.50	0.63%
Totals		\$7,105.08	100%

Special Assessments

Name	Expiration	Delinquent	Principal	Half Year	Full Year	Admin Fee	Future Year	Total
10117 LC Pub Health, Delq OM permits res 24TY 2024	2024	0.00	\$0.00	\$77.50	\$155.00	\$3.10	\$0.00	\$0.00
10119 LC Storm Water Billing, 24TY 2024	2024	0.00	\$0.00	\$23.49	\$46.97	\$0.94	\$0.00	\$0.00