



ONION CREEK CENTER

11111 S. I-35, Austin, TX 78747

RETAIL/OFFICE SPACE - FOR LEASE





- **Built Out Office/Retail Space**
- **Great Location and Visibility from I-35**
- **Move In Ready Office/Retail Space - End Cap Space!**
- Pylon Signage Fronting I-35 Available
- 15 minutes to Austin-Bergstrom Airport
- 10 minutes to Downtown Austin
- **Call Today to Schedule a Tour!**



NEARBY

BB&T

ROSS
DRESS FOR LESS



REGIONS



WESTERN UNION

For more information please contact:

Nick Tarantino, CCIM nick@tarantino.com

Chad Folts cfolts@tarantino.com

502 East 11th St., Suite 400

Austin, Texas 78701

Tel (512) 302-4500

www.tarantino.com



Move In Ready Office/Retail Space

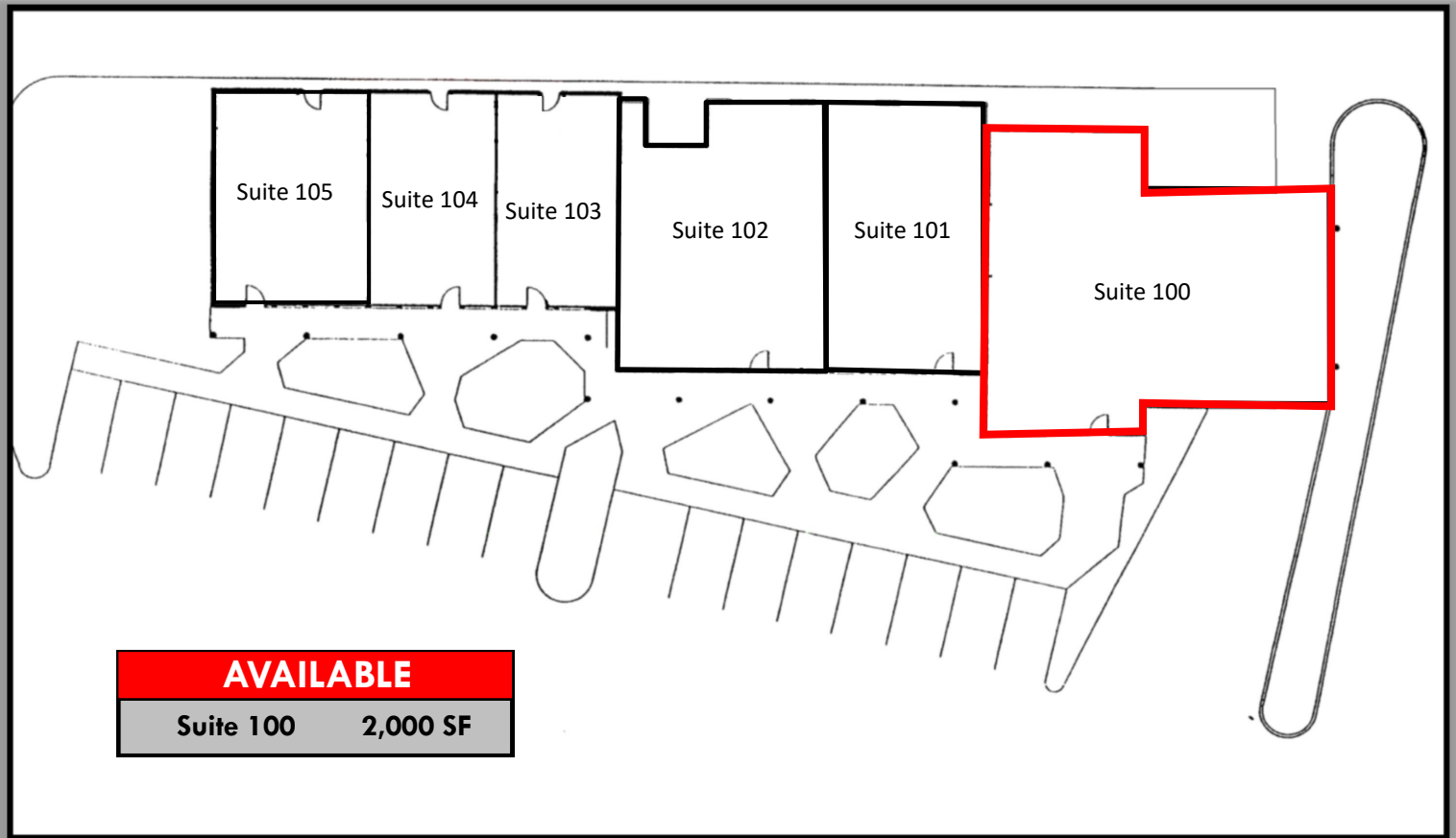

AVAILABLE	
Suite 100	2,000 SF

DEMOGRAPHICS (2024)

Mile(s)	1	3	5
Total Population	10,968	66,050	181,198
Total Households	5,125	27,466	76,487
Average HH Income	\$95,888	\$102,696	\$102,985
Daytime Employment	1,806	12,750	37,678

For more information please contact:

Nick Tarantino, CCIM nick@tarantino.com

Chad Folts cfolts@tarantino.com

502 East 11th St., Suite 400

Austin, Texas 78701

Tel (512) 302-4500

www.tarantino.com

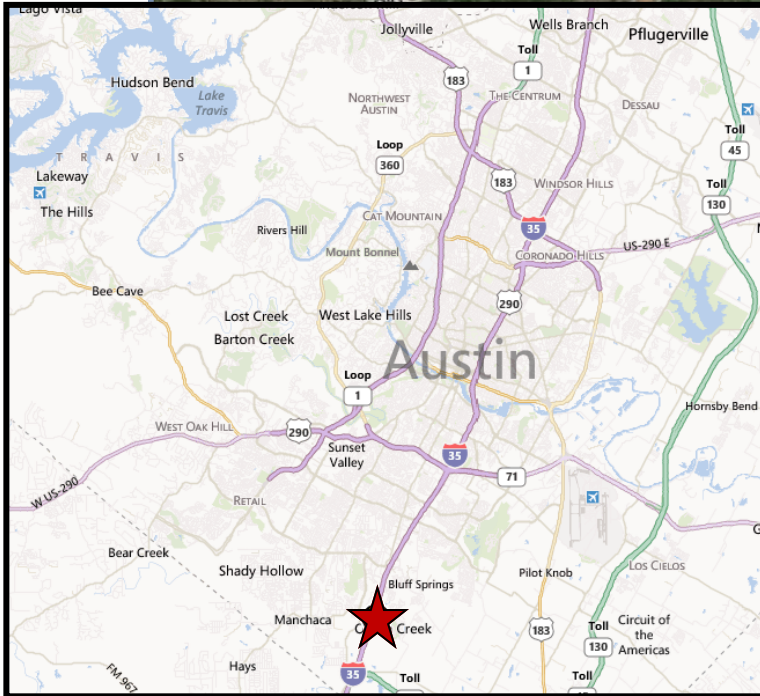

For more information please contact:

Nick Tarantino, CCIM nick@tarantino.com

Chad Folts cfolts@tarantino.com

502 East 11th St., Suite 400

Austin, Texas 78701

Tel (512) 302-4500

www.tarantino.com