

FOR LEASE

# 2350 PARK CENTER DRIVE

MEBANE, NORTH CAROLINA 27302

**READY TO OCCUPY:** ±232,336 SF CLASS A INDUSTRIAL FACILITY WITH IMMEDIATE ACCESS TO I-85/40



OWNED BY AN AFFILIATE OF

**EQUUS**  
CAPITAL PARTNERS, LTD.

**CBRE | Triad**  
A JOINT VENTURE

# PROPERTY HIGHLIGHTS

## INDUSTRIAL WAREHOUSE FACILITY

- **Building Size:** ±232,336 SF
- **Construction Type:** Tilt-up concrete
- **Sprinkler Type:** ESFR
- **Ceiling Height:** ±26'
- **Year Built:** 2016; expanded in 2023
- Excellent location along I-40/85 corridor between Greensboro and Raleigh-Durham
- First-class business park setting
- Very well-maintained property
- Property can be subdivided





# PROPERTY SUMMARY

<b>PROPERTY TYPE/SUBTYPE</b>	Industrial
<b>ADDRESS</b>	2350 Park Center Drive, Mebane, NC
<b>BUILDING SQUARE FEET</b>	232,336
<b>OFFICE SQUARE FEET</b>	1,907
<b>ACRES</b>	15.75
<b>YEAR CONSTRUCTED</b>	2016; expanded in 2023
<b>PARKING TYPE</b>	Surface, 103 Parking Spaces
<b>ACCESS</b>	S Third Street and Corporate Park Drive
<b>STRUCTURE</b>	Concrete and steel
<b>FIRE SPRINKLER TYPE</b>	ESFR
<b>LIGHTING</b>	T-5
<b>CEILING HEIGHT</b>	26'
<b>BUILDING DEPTH</b>	310'
<b>COLUMN SPACING</b>	50'x 54'
<b>DOCK LOADING (# OF DOORS)</b>	45 (9'x10'); 20 pit levelers rated at 30,000 lbs
<b>DRIVE-IN LOADING (# OF DOORS)</b>	2 (12'x14')
<b>LOADING POSITION</b>	Side-Loading
<b>POWER</b>	1200 amp, 277/408V



# SITE PLAN

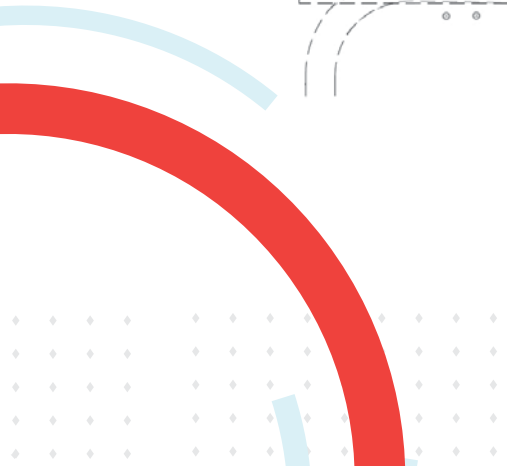
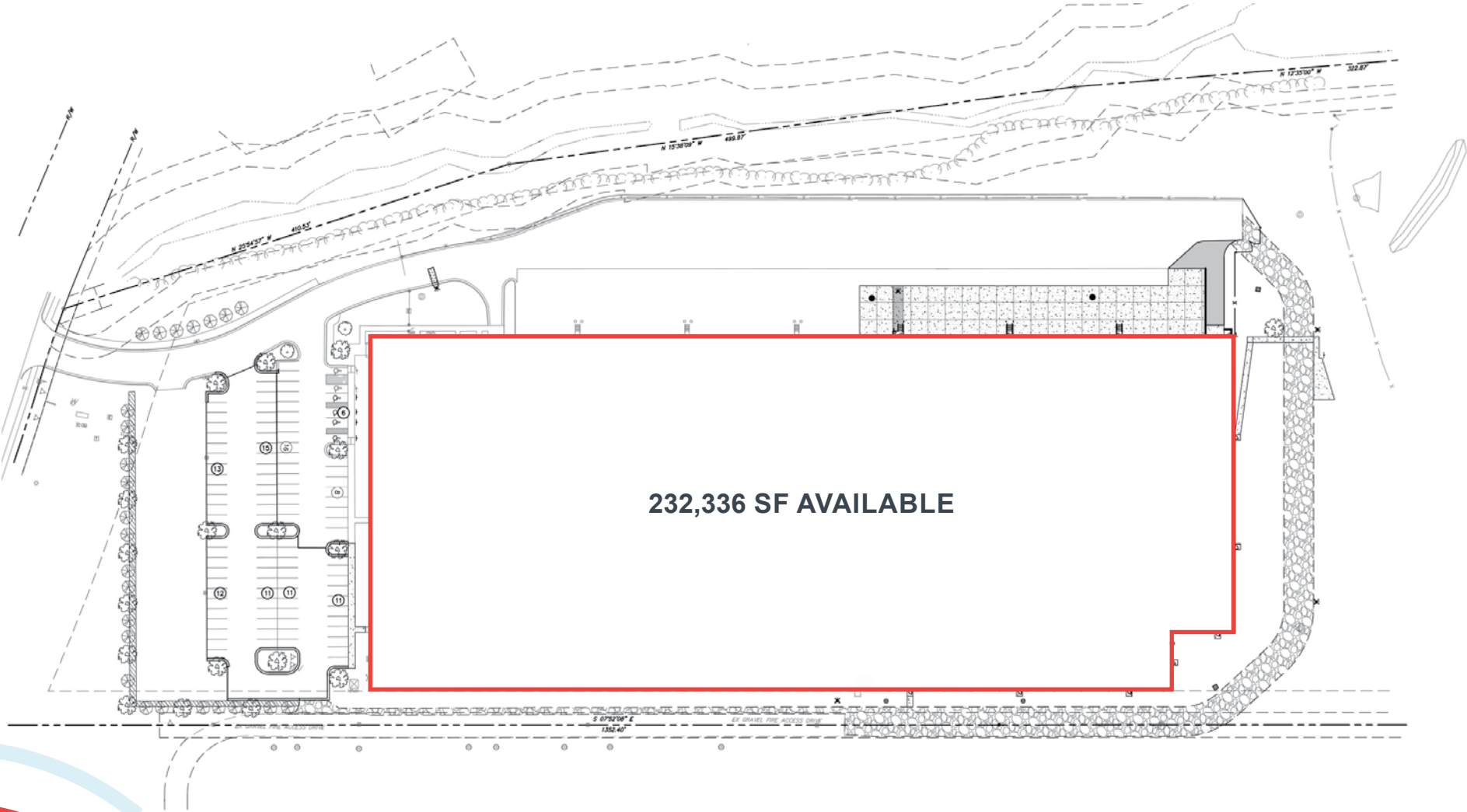



# INTERIOR PHOTOS







# LOCATION INFO

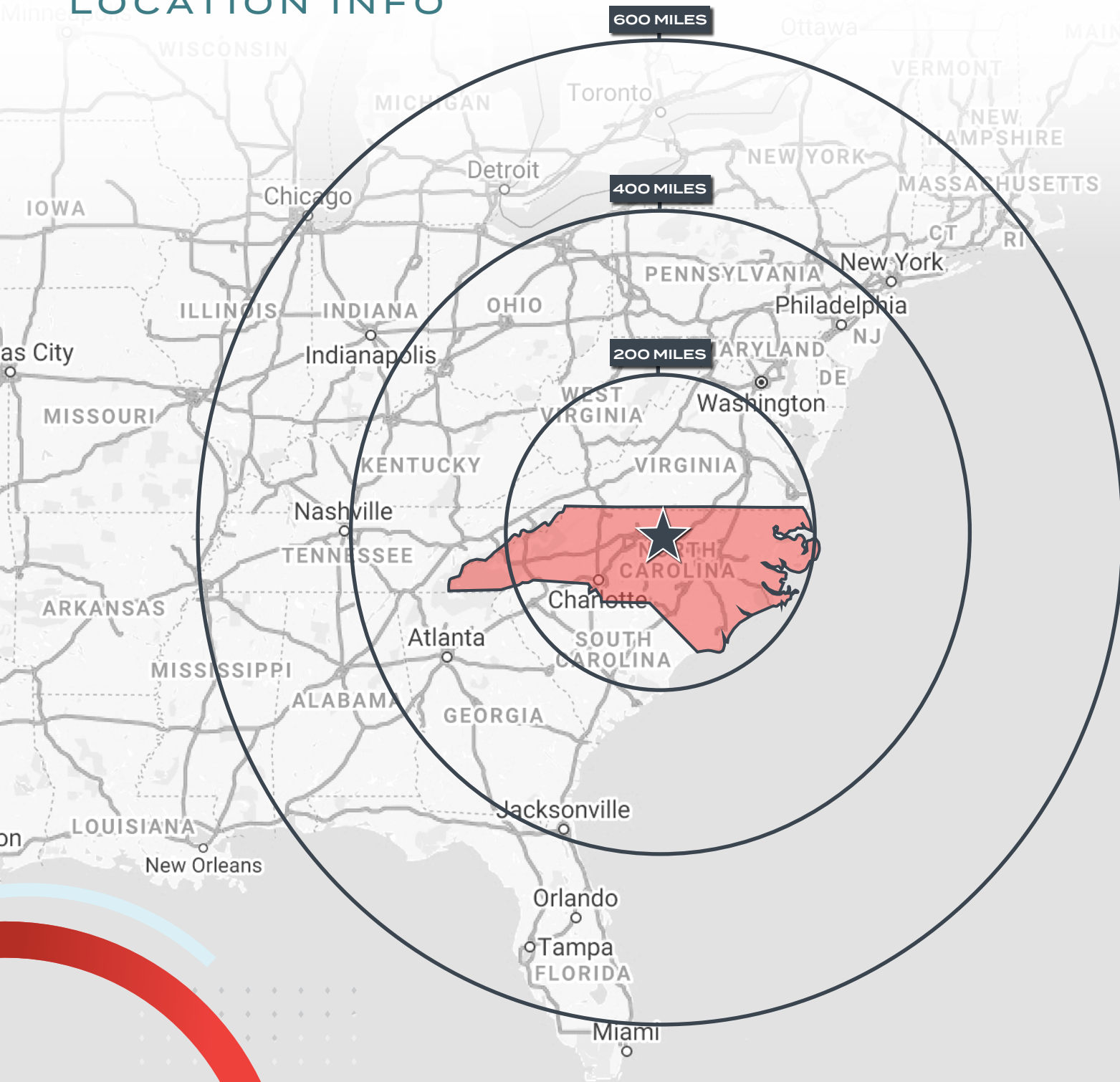

DISTANCE FROM  
**AIRPORTS** 

**38 MILES**  
FROM RALEIGH-DURHAM  
INTERNATIONAL AIRPORT

**43 MILES**  
FROM PIEDMONT TRIAD  
INTERNATIONAL AIRPORT

**104 MILES**  
FROM CHARLOTTE-DOUGLAS  
INTERNATIONAL AIRPORT

DISTANCE FROM  
**PORTS** 

**185 MILES**  
FROM PORT OF WILMINGTON

**200 MILES**  
FROM NORTH CAROLINA PORT

**207 MILES**  
FROM PORT OF VIRGINIA

**306 MILES**  
FROM SOUTH CAROLINA PORTS



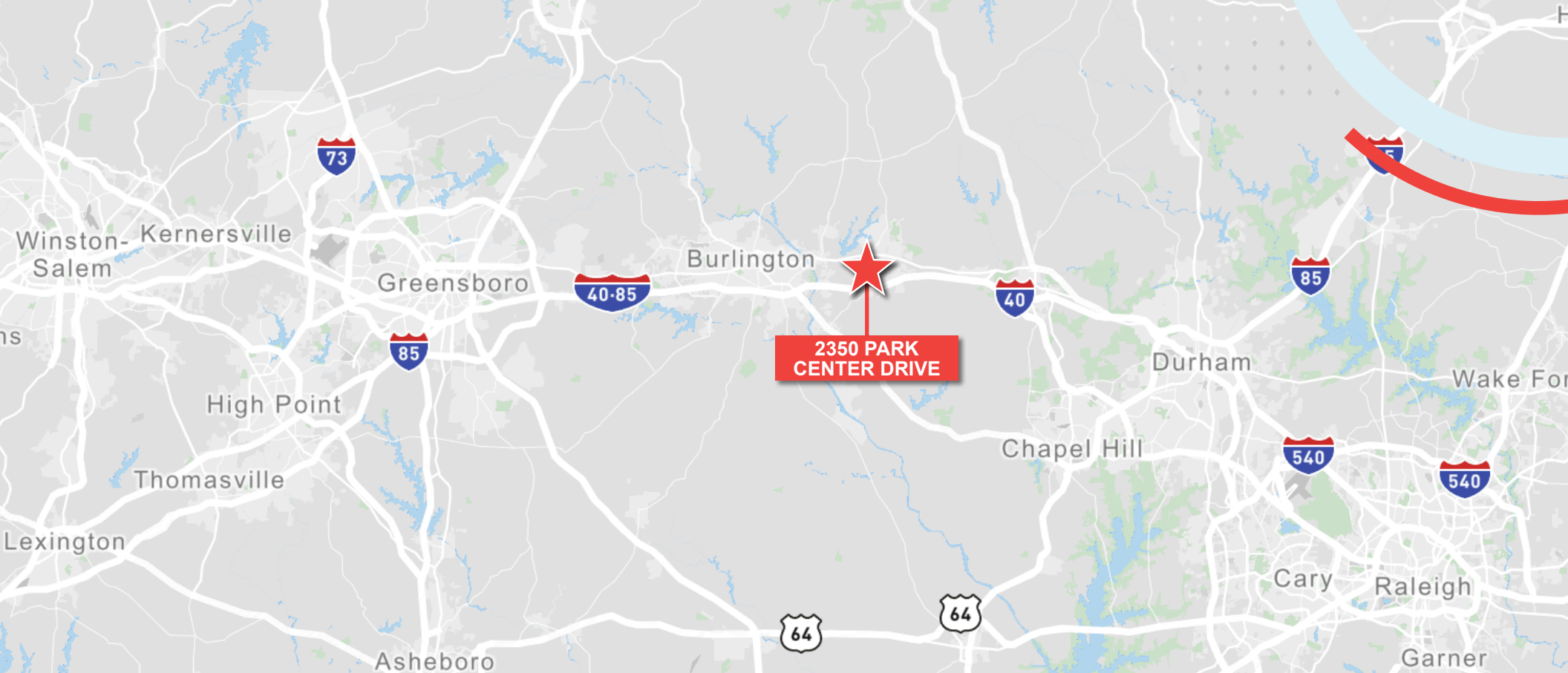

## CONTACT US

### **DODSON SCHENCK**

Managing Director, Industrial Services  
+1 336 478 0234  
dodson.schenck@cbre-triad.com

### **AUSTIN NAGY**

Senior Vice President  
+1 919 831 8197  
austin.nagy@cbre-raleigh.com

© 2023 CB Richard Ellis-Raleigh LLC, a Delaware limited liability company. All rights reserved. This information has been obtained from sources believed reliable, but has not been verified for accuracy or completeness. You should conduct a careful, independent investigation of the property and verify all information. Any reliance on this information is solely at your own risk. CBRE and the CBRE logo are service marks of CBRE, Inc. All other marks displayed on this document are the property of their respective owners, and the use of such logos does not imply any affiliation with or endorsement of CBRE. Photos herein are the property of their respective owners. Use of these images without the express written consent of the owner is prohibited.

OWNED BY AN AFFILIATE OF  
**EQUUS**  
CAPITAL PARTNERS, LTD.

**CBRE | Triad**  
A JOINT VENTURE