

**+/- 1,697 Square Foot Freestanding
Commercial Building For Lease**

**2600 North Main Street
Walnut Creek, California**

Property Information:

- **Stand Alone Approx. 1,697 Sq. Ft. Building With Yard Available for Lease**
- **Asking Rate is \$8,000. Per Mo. NNN**
- **Has a Small Rear, Rocked and Fenced Yard Area of Approx. 3,800 Sq. Ft.**
- **Newly Remodeled With High End Finishes, Stained Concrete Floors, Etc.**
- **Large Open Area/Showroom, Several Offices, Kitchen and One Restroom**
- **Flexible "SC" Service Commercial Zoning**
- **Excellent Walnut Creek Location With Great Access to Interstate 680, Hwy 24**



Listing Broker:

Thomas Caple
CA BRE# 01089011
(510) 908-0505
tom@dpccommercial.com

Listing Broker:

Graham Deutscher
CA BRE# 01854629
(925) 768-1389
graham@dpccommercial.com

Deutscher Properties Corp.

370 Civic Drive
Pleasant Hill, CA
Office (925) 676-6166
Fax (925) 676-6177
www.dpccommercial.com

**2600 North Main Street,
Walnut Creek, CA**

NOTES/

PROPERTY NOTES

- **Approx. 1,697 Sq. Ft. Building on an Approx. 9,583 Sq. Ft. Parcel**
- **Rear Fenced and Rocked Yard Area of Approx. 3,800 Sq. Ft.**
- **Building Has Been Extensively Remodeled With High End Finishes Throughout.**
- **Attractive Lunch Room With Sink and Upper and Lower Cabinets.**
- **Several Private Offices, Conference Room and a Large Open Area/Showroom.**
- **Code Compliant ADA Compliant Restroom.**



Listing Broker:

Thomas Caple
CA BRE# 01089011
(510) 908-0505
tom@dpccommercial.com

Listing Broker:

Graham Deutscher
CA BRE# 01854629
(925) 768-1389
graham@dpccommercial.com

Deutscher Properties Corp.
370 Civic Drive
Pleasant Hill, CA
Office (925) 676-6166
Fax (925) 676-6177
www.dpccommercial.com

2600 North Main Street, Walnut Creek, CA

SITE PLAN

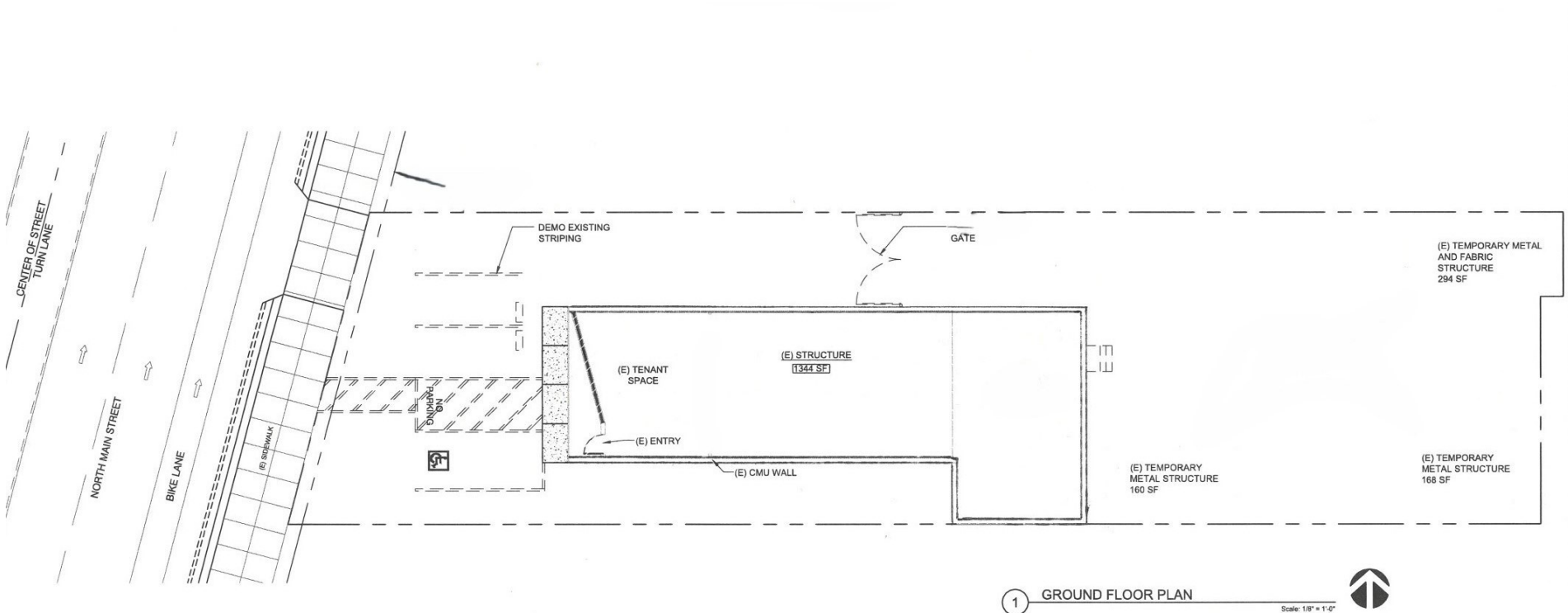

1 GROUND FLOOR PLAN Scale: 1/8" = 1'-0"

Listing Broker:
Thomas Caple
CA BRE# 01089011
(510) 908-0505
tom@dpccommercial.com

Listing Broker:
Graham Deutscher
CA BRE# 01854629
(925) 768-1389
graham@dpccommercial.com

Deutscher Properties Corp.
370 Civic Drive
Pleasant Hill, CA
Office (925) 676-6166
Fax (925) 676-6177
www.dpccommercial.com

**2600 North Main Street,
Walnut Creek, CA LOCATION MAP**

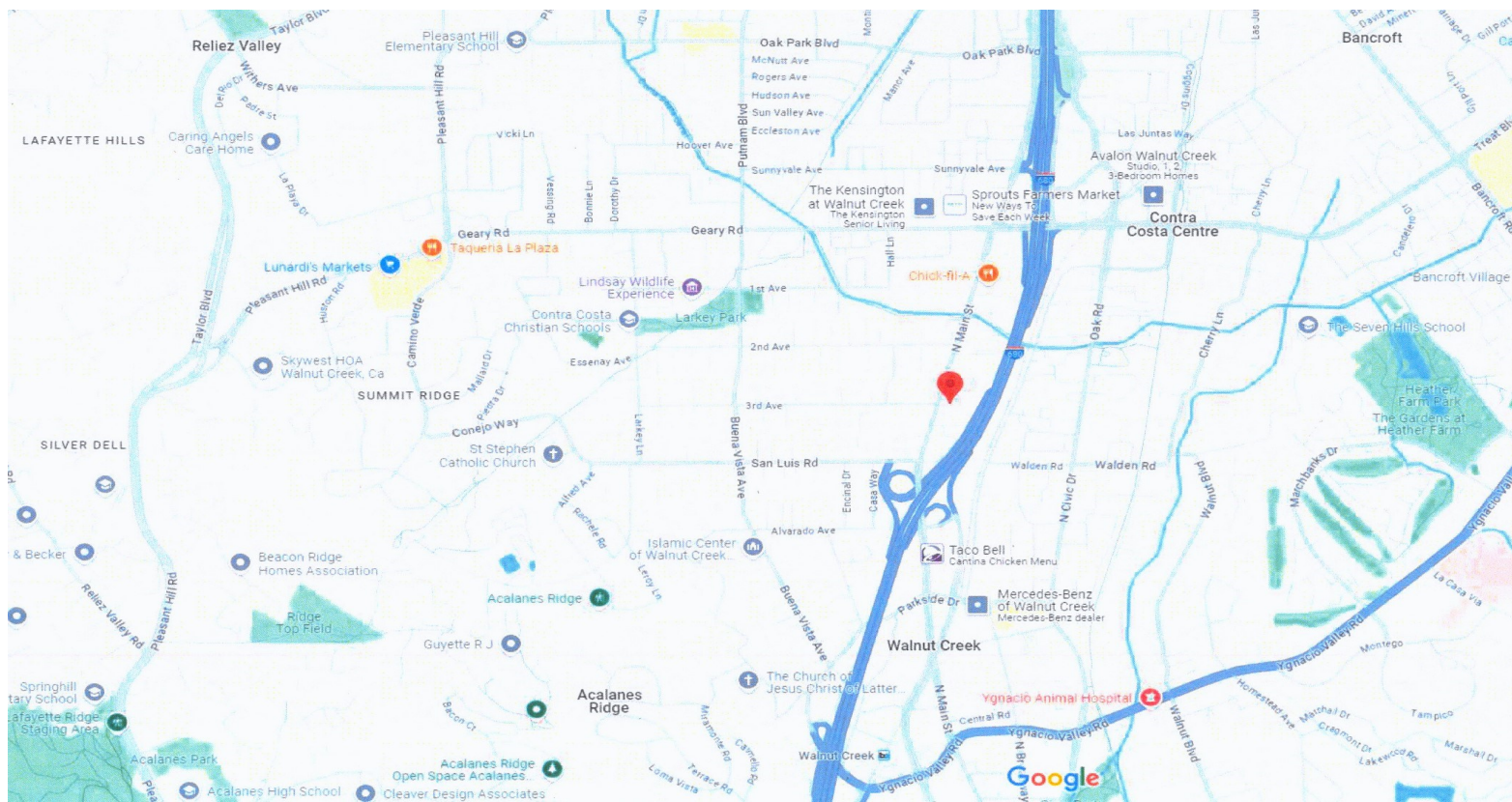

Listing Broker:
Thomas Caple
CA BRE# 01089011
(510) 908-0505
tom@dpccommercial.com

Listing Broker:
Graham Deutscher
CA BRE# 01854629
(925) 768-1389
graham@dpccommercial.com

Deutscher Properties Corp.
370 Civic Drive
Pleasant Hill, CA
Office (925) 676-6166
Fax (925) 676-6177
www.dpccommercial.com