



HOULIHAN LAWRENCE
COMMERCIAL

ALAN ZUCKERMAN

Licensed Associate Real Estate Broker

M. 914.755.4184

AZuckerman@houlihanlawrence.com

800 Westchester Avenue, Suite N-517 • Rye Brook, NY 10573 • O. 914.798.4900

Prime Retail Space in Mamaroneck Plaza For Lease

640 EAST POST ROAD
MAMARONECK, NY 10543

FOR RENT: \$35.00 PSF NNN



- Asking Rent: \$35.00 psf, NNN
- CAM & Taxes: \$14.00 psf
- 2,000 sf available
- Frontage: Approx. 55 feet
- Off street parking for 110+ cars
- Signalized Intersection
- Affluent Community
- Excellent Visibility
- Daily Traffic: 24,951 (inc. N. Barry Avenue)

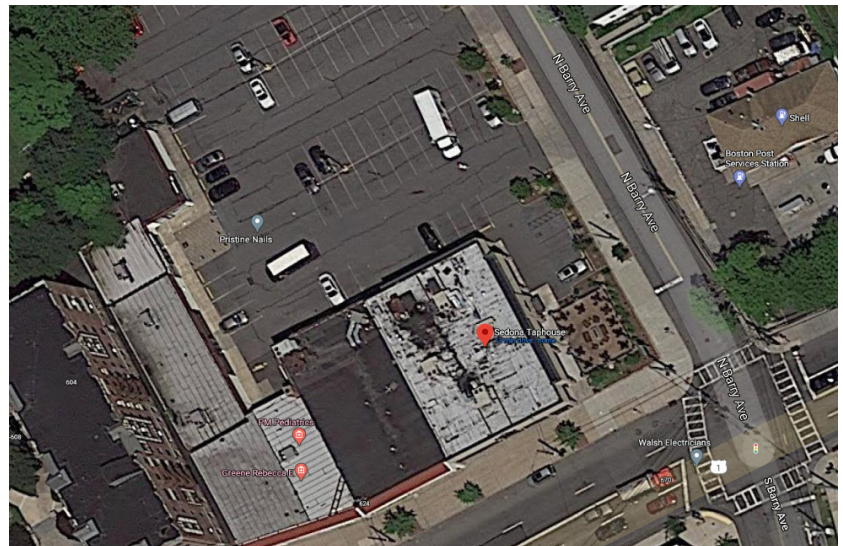

Area Demographics

Miles	1	3	5
Population	18,079	72,072	225,399
Med. HH Income	\$90,250	\$128,406	\$106,517



HOULIHAN LAWRENCE
COMMERCIAL

ALAN ZUCKERMAN

Licensed Associate Real Estate Broker

M. 914.755.4184

AZuckerman@houlihanlawrence.com

800 Westchester Avenue, Suite N-517 • Rye Brook, NY 10573 • O. 914.798.4900

Prime Retail Space in Mamaroneck Plaza For Lease

640 EAST POST ROAD
MAMARONECK, NY 10543

FOR RENT: \$35.00 PSF NNN

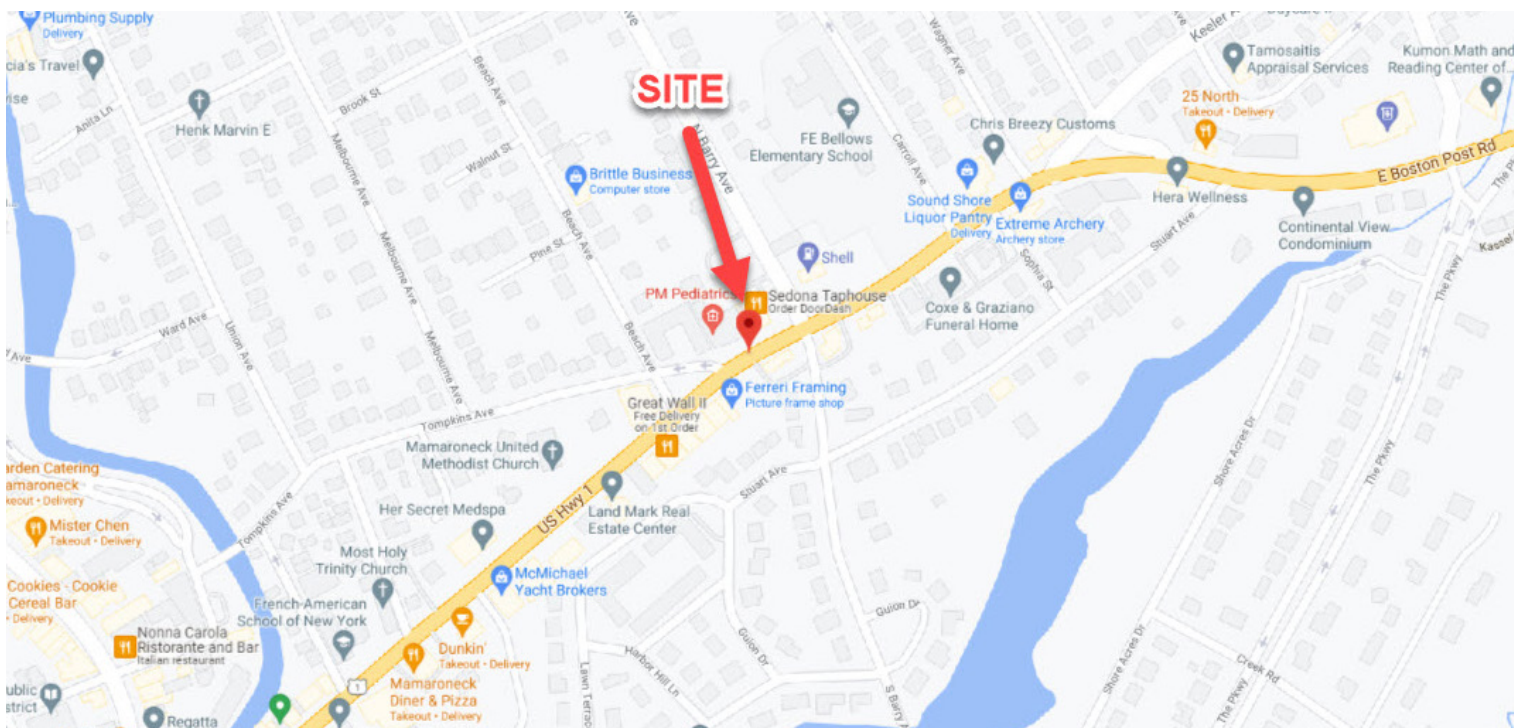
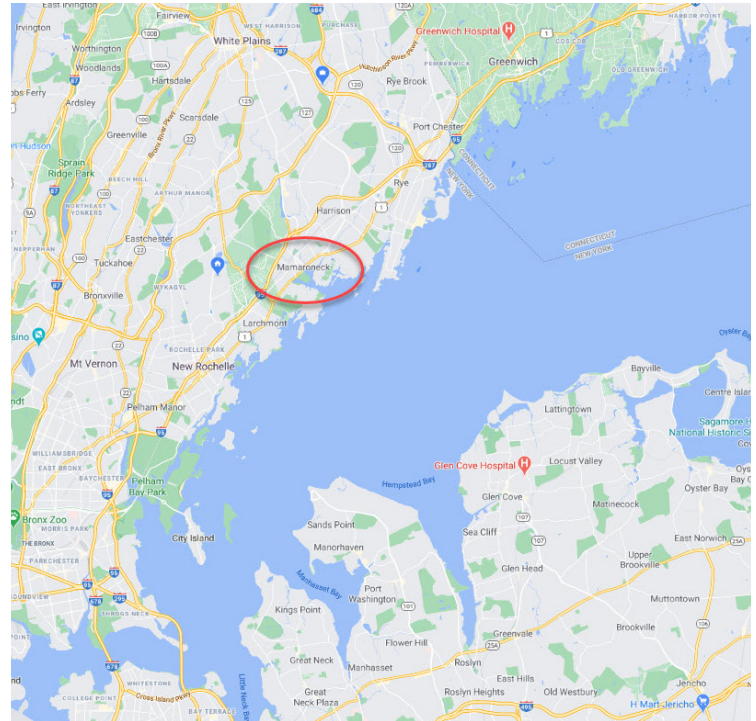
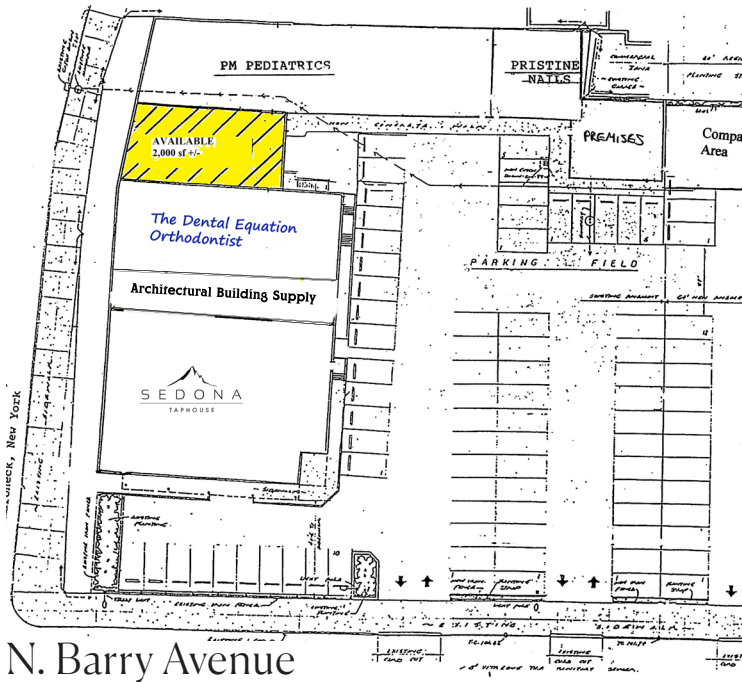

The information contained in this Offering Memorandum is confidential, furnished solely for the purpose of review by a prospective purchaser of certain information relating to the property mentioned herein (the "Property"), and is not to be used for any other purpose or made available to any other person without the prior written consent of HLC. The material is subject to errors and omissions and based on part upon information supplied by sources deemed reliable.