

# Stanley Green

TRADING ESTATE

DUKE AVENUE, CHEADLE HULME,  
CHEADLE, STOCKPORT SK8 6RX

## Unit 7 To Let

7,778 SQ FT (723 SQ M)

AVAILABLE NOW

BREEAM<sup>®</sup>  
Excellent<sup>™</sup>

A  
EPC A+

A  
Prominent  
to A555

CO<sub>2</sub>  
Net Zero  
Operational  
Carbon

Established  
Location

[www.stanleygreentradingestate.co.uk](http://www.stanleygreentradingestate.co.uk)

# Welcome To Stanley Green Trading Estate

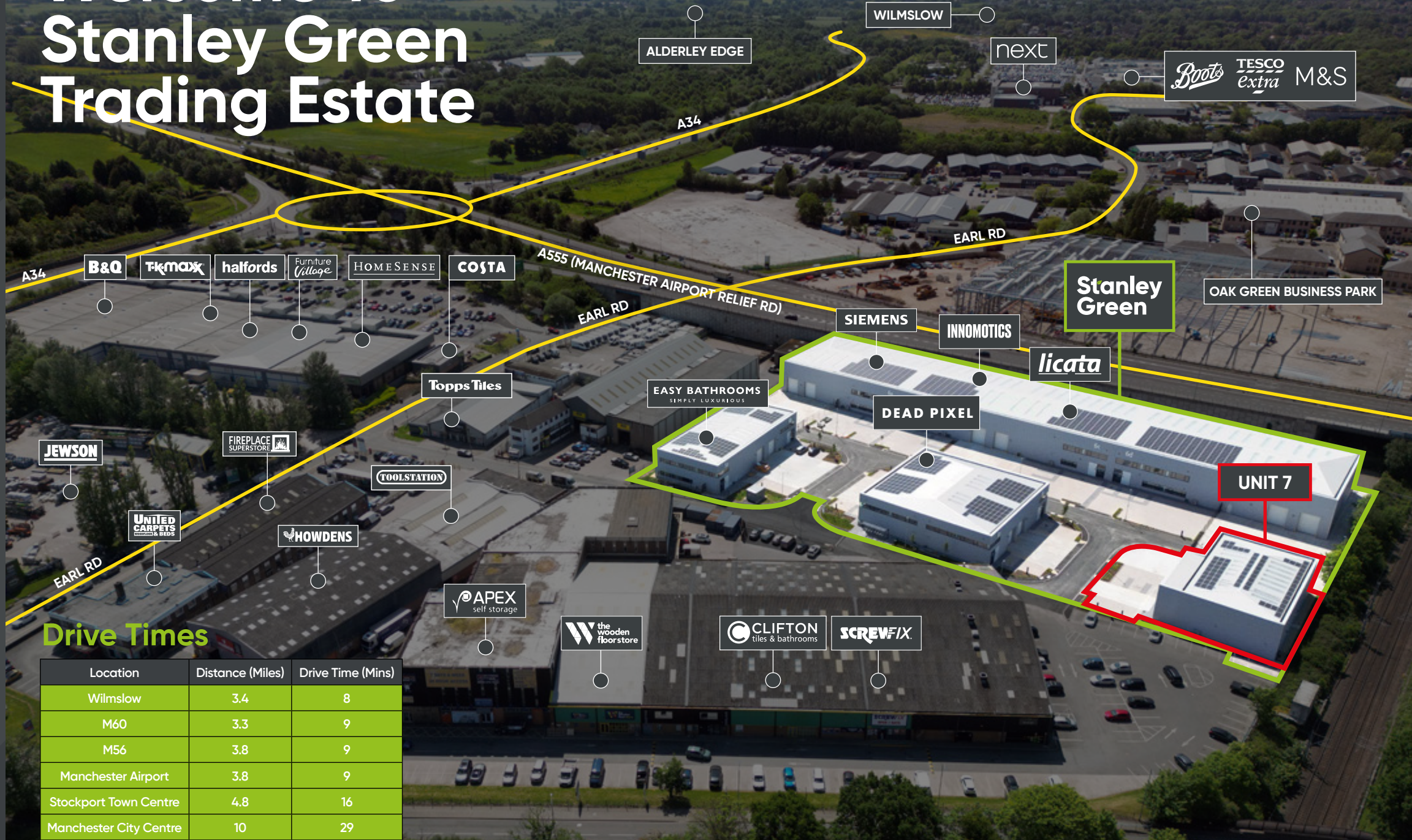

## Drive Times

Location	Distance (Miles)	Drive Time (Mins)
Wilmslow	3.4	8
M60	3.3	9
M56	3.8	9
Manchester Airport	3.8	9
Stockport Town Centre	4.8	16
Manchester City Centre	10	29

# High Specification



First floor fitted offices

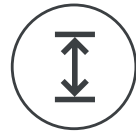

6.5m eaves height



EV charging points



PV power supply to reduce operating costs



37.5kN/sq m floor loading



Electric level access loading doors



3 phase power supply



14 dedicated parking spaces

FLOOR	SQ FT	SQ M
GROUND	6,436	598
FIRST	1,342	125
TOTAL	7,778	723

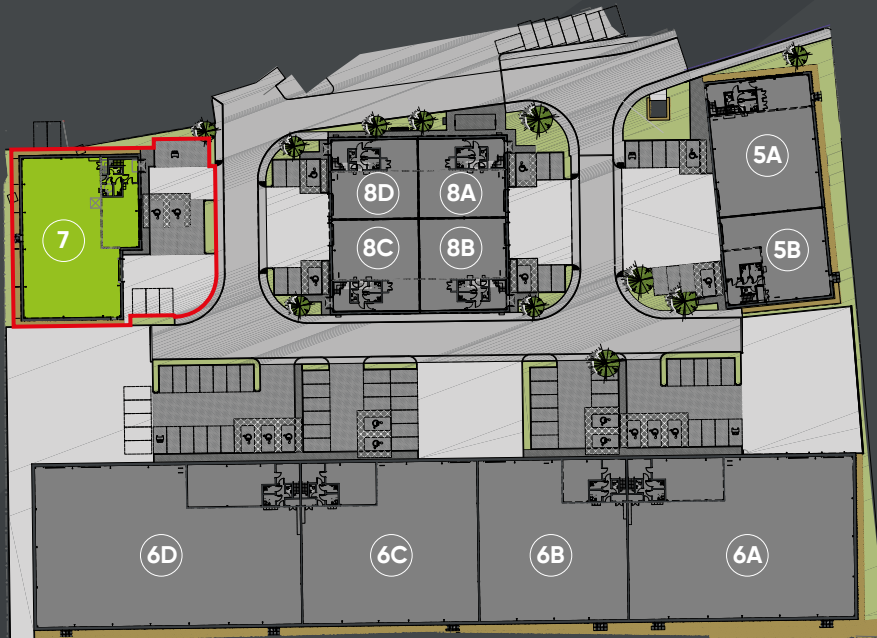

# Further Information

## Location

Stanley Green Trading Estate is located in Cheadle, one of South Manchester's most affluent and desirable suburbs.

Stanley Green Trading Estate is just off the A34 bypass, which provides a direct route to Manchester and the M60 motorway connecting the suburbs of Wilmslow and Alderley Edge to the South. Surrounding the estate are a number of trade, retail and leisure amenities, with more just a short drive away.

Connectivity to Manchester Airport has been greatly enhanced with the completion of the A555 Airport Relief Road, connecting the A6 at Hazel Grove in the East through to Manchester Airport and the M56 motorway to the West.

## Terms

The unit is available to let on terms to be agreed.

## EPC

The property has an EPC rating of A+ (-4) and is Net Zero CO2.

## Estate Charge

The occupier will pay an estates charge for the upkeep and maintenance of the estate.

## Rateable Value

The property has a rateable value of £77,000.

## Anti-Money Laundering

In accordance with AML Regulations, we are obliged to verify the identity and the source of funds for the proposed tenant / purchaser, once a let / sale has been agreed and prior to instructing solicitors.

## Viewing

For more information, please contact the agents:



JASON PRINT  
07833 170 680  
jprint@geraldeve.com



ANDY BACKHOUSE  
07548 596 271  
andy@sixteenrealestate.com



Indicative image



Indicative image

IMPORTANT NOTICE: Gerald Eve and Sixteen Real Estate give notice to anyone who may read these particulars as follows: 1. These particulars are prepared for the guidance only of prospective purchasers. They are intended to give a fair overall description of the property but are not intended to constitute part of an offer or contract. 2. Any information contained herein (whether in the text, plans or photographs) is given in good faith but should not be relied upon as being a statement or representation of fact. 3. Nothing in these particulars shall be deemed to be a statement that the property is in good condition or otherwise nor that any services or facilities are in good working order. 4. The photographs appearing in this brochure show only certain parts and aspects of the property at the time when the photographs were taken. Certain aspects may have changed since the photographs were taken and it should not be assumed that the property remains precisely as displayed in the photographs. Furthermore no assumptions should be made in respect of parts of the property which are not shown in the photographs. 5. Any areas, measurements or distances referred to herein are approximate only. 6. Where there is reference in these particulars to the fact that alterations have been carried out or that a particular use is made of any part of the property this is not intended to be a statement that any necessary planning, building regulations or other consents have been obtained and these matters must be verified by any intending purchaser. 7. Descriptions of a property are inevitably subjective and the descriptions contained herein are used in good faith as an opinion and not by way of statement of fact. Published October 2024.