

Building 14040



2DFLOORPLANS.COM

600 NW Gilman Blvd. Suite E  
Issaquah, WA 98027  
425-677-7511

This drawing is an instrument of service and is the sole property of the client listed. Any alteration of this drawing without removal of references to 2-D As-Built Floor Plans, Inc. is prohibited.

Drawing scale and dimensions are provided for reference only. Refer to CAD files for exact measurements.

©2010 2-D As-Built Floor Plans, Inc. All Rights Reserved.

Area Analysis performed in accordance with ANS/BOMA Z65.1 - 2017 Method A Standard.

Project: C21-925

Date	Action
08/24/2021	Initial Site Measure
C21-925	
10/8/2021	Suite Demising revised as per client request.
C21-925	

Client:  
AS wealth Group LLC

Site:  
Office  
14040 NE 8th Street  
Bellevue, WA 98007

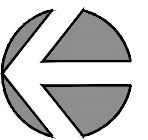

Lease Plan



Floor

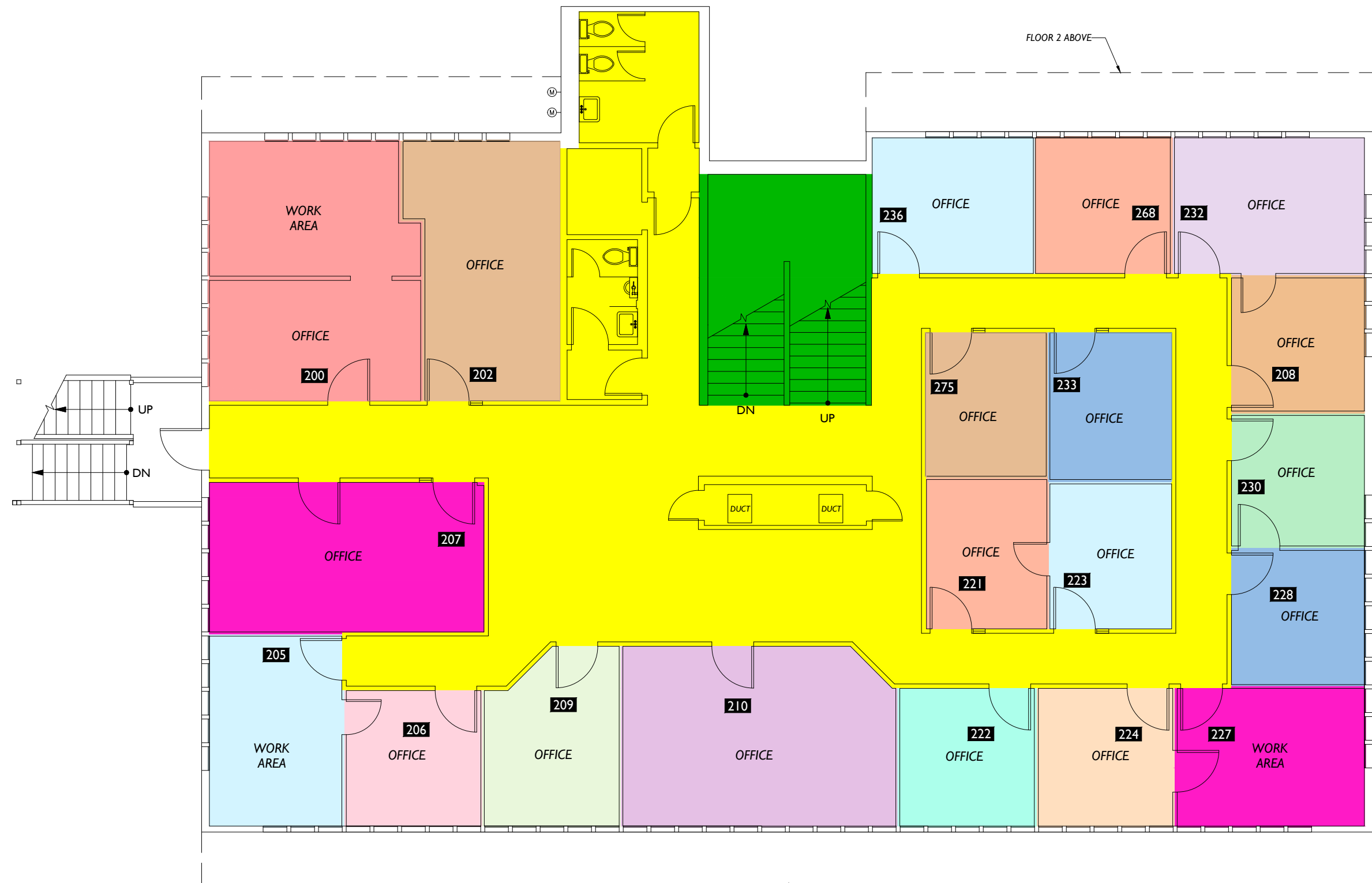

Parking

Parking

**Floor Summary**      **SQ. FT.**

Total Rentable Area	4,169.03
Total Occupant Area	2,658.96
Load Factor	1.567918

Floor Service Area	1,331.23
Building Service Area	0.0
Total Vertical	207.74

Suite #	Occupant Area	Rentable Area	Suite #	Occupant Area	Rentable Area
Suite 200	281.96	442.09	Suite 223	94.65	148.40
Suite 202	195.51	306.54	Suite 224	100.23	157.15
Suite 205	135.27	212.09	Suite 227	138.42	217.03
Suite 206	98.16	153.91	Suite 228	96.58	151.43
Suite 207	216.29	339.13	Suite 230	93.86	147.16
Suite 208	95.97	150.47	Suite 232	138.74	217.53
Suite 209	119.66	187.62	Suite 233	96.04	150.58
Suite 210	254.94	399.73	Suite 236	115.38	180.91
Suite 221	96.08	150.65	Suite 268	98.31	154.14
Suite 222	100.10	156.95	Suite 275	92.81	145.52

Parking