

HUNT

Corporate Services, Inc.

We Facilitate Your Business

10,698 Square Feet Industrial-Flex Space For Lease

Fully Air-Conditioned

Perfect for Lab, Pharma, Engineering or Full Office Space



131 East Ames Court, Plainview, New York

14,484 square foot, one story flex-industrial building, on a one acre plot. Excellent location less than one-half mile to Long Island Expressway and Northern State Parkway.

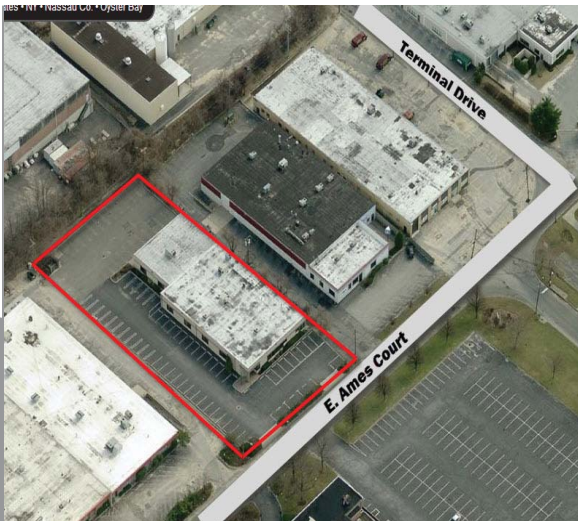

- > 10,698 square feet available for lease
- > Separate entrance and utilities - ideal for 24/7 operation
- > Fully air-conditioned
- > Parking at your door - total of 86 spaces for building
- > Space will be designed and finished to suit
- > Loading door can be installed
- > On the Long Island Expressway, Exit 46

131 East Ames Court, Plainview, New York

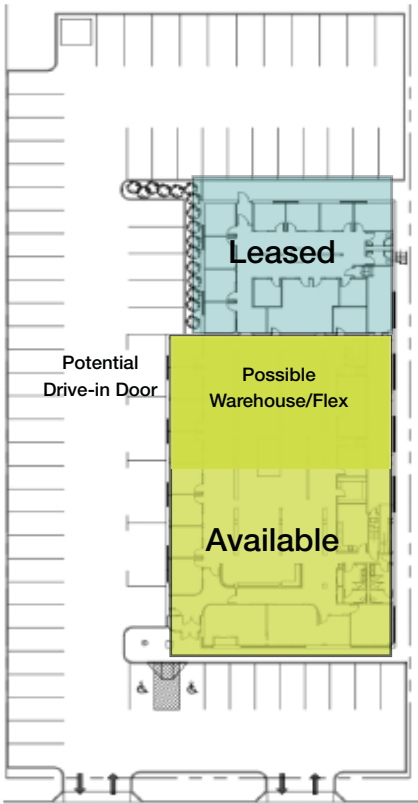

Description:

10,698 square feet in a 14,484 square foot “flex” building situated on a one acre plot. Suitable for industrial-flex or full office use.

Location:

Located off the South Service Road of the Long Island Expressway at Sunnyside Boulevard, Exit 46 and Northern State Parkway, Exit 38.

Parking:

86 parking spaces available for entire building.

Building:

Office Area: To Suit

Heat: Gas

Sprinkler: Yes

Sewers: Yes

Full Air-Conditioning: Yes

Loading: Loading door can be installed

Occupancy:

Vacant, ready for occupancy or build-out.

Rental:

Custom quotation based on finishing requirements.

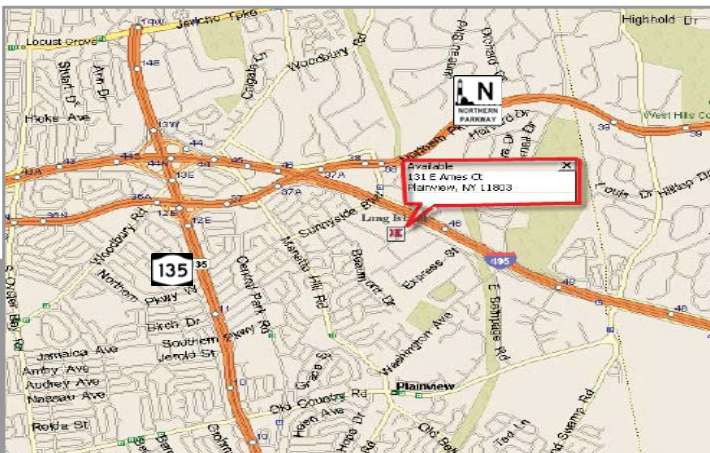

Exclusively Represented By:

David G. Hunt, MCR, CCIM

Licensed Real Estate Broker

HUNT CORPORATE SERVICES, INC.

185 Express Street, Suite 300

Plainview, NY 11803

Tel: (516) 937-1000 • david@huntcorp.com

www.huntcorp.com